

- 1
- 2
- 3
- 4
- 5
- 6
- 7
- 8
- 9
- 10
- 11
- 12
- 13
- 14
- 15
- 16
- 17
- 18

**MATERIAL**

Glass-fibre reinforced polyamide based (PA) technopolymer, black colour, matte finish.

**STANDARD EXECUTIONS**

- **BAS3-A**: zinc-plated steel M10 screws, nuts and washers.
- **BAS3-SST**: AISI 304 stainless steel M10 screws, nuts and washers.

**ASSEMBLY ON LEVELLING ELEMENTS**

The three bearings of the base are supplied with brass bosses, threaded pass-through hole for the assembly of the levelling element series LS.A (see page 798), LV.A (see page 804), LV.F (see page 818).

**FEATURES**

The rounded shapes with a modern and elegant aesthetic guarantee maximum cleanability in the event of liquids or dust falling from above. Maximum tightening torque for screw assembly 35 Nm.

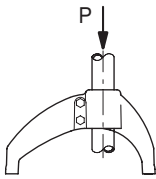

Retention force  
P = 2000 N

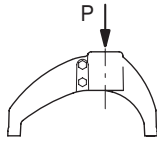

Max. static load  
P = 9800 N

Values obtained with tightening torque 35 Nm

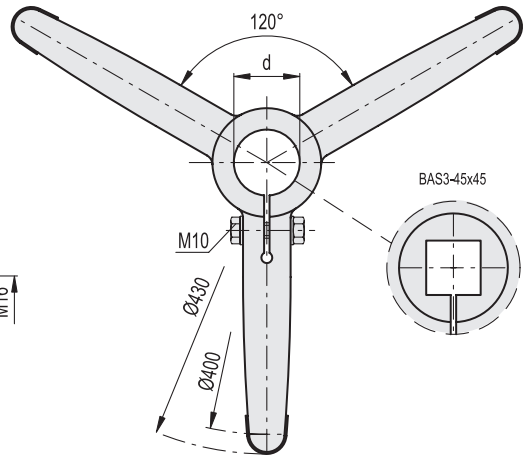
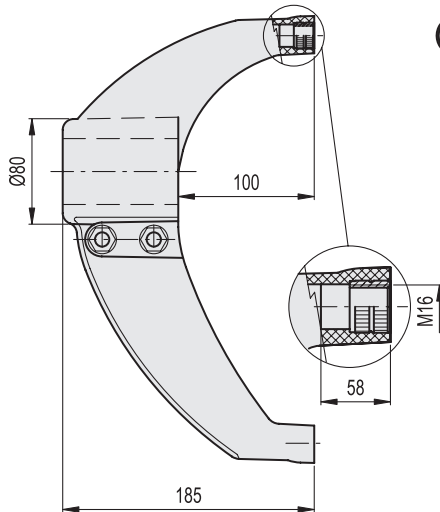

Conversion Table	
1 mm = 0.039 inch	
d	
mm	inch
42.4	1.67
45	1.77
48.3	1.90
50.8	2.00
60.3	2.37

**BAS3**

**METRIC**

**BAS3-SST**

**METRIC**

**INOX** STAINLESS STEEL

Code	Description	d Tube (mm)	d Tube (GAS)	d Tube (inch)	⚖	Code	Description	⚖
419592	BAS3-42-A	42.4	1"1/4	-	800	419593	BAS3-42-SST	800
419590	BAS3-48-A	48.3	1"1/2	-	790	419591	BAS3-48-SST	790
419594	BAS3-50-A	50.8	-	2"	800	419595	BAS3-50-SST	800
419588	BAS3-60-A	60.3	2"	-	770	419589	BAS3-60-SST	770
419752	BAS3-45x45-A	45	-	-	795	419753	BAS3-45x45-SST	795