

Two Layer ESD Mat Kits

Perfect for table top electronic repair and soldering

Protect your sensitive items as well as your work surface with durable ESD matting.

The two layer ESD Mat Kits provide everything needed to ground your mat and operator at a workbench. A conductive layer backs the static dissipative top layer that creates outstanding electrical performance characteristics. The matting offers excellent resistance to hot solders, soldering irons and most solvents.

Cut or drill a small hole to install the CS1090 snap kit in the desired location. Then connect the ground cord to the mat. Use one of the 3 options shown below to ground the mat through the ground cord. The operator can connect the wrist strap to the head of the ground cord.



Features

- Provides Everything Needed to Ground Your Mat and Operator at a Workbench
- Two Layer Rubber: 10^6 - 10^8 Rtt
- Excellent Resistance to Hold Solders, Soldering Irons and Most Solvents
- Nasa Blue, Royal Blue, Green, and Grey

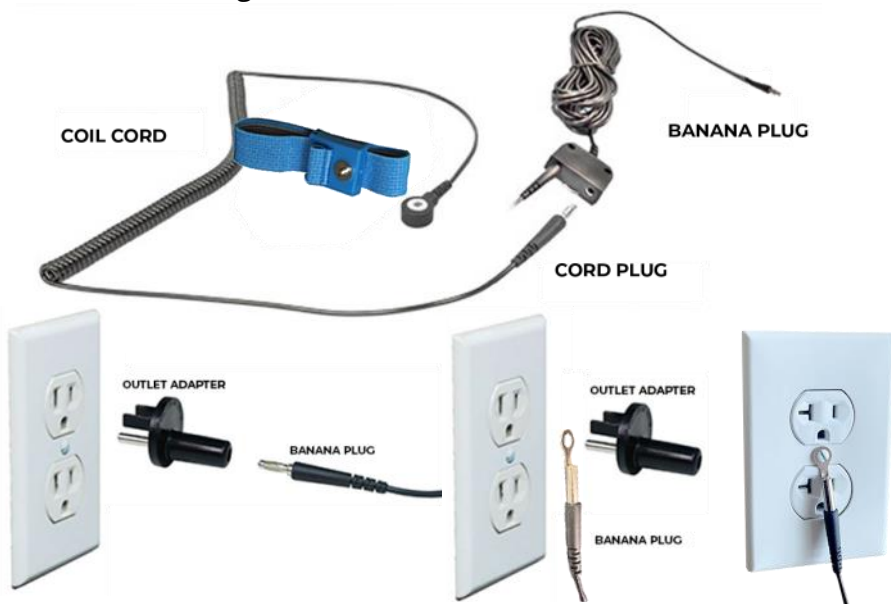

Specifications:

Thickness	0.080" (Except for TTB1624B, 0.060")
Hardness	60 Shore A
Tensile Strength	>1000 PSI
Elongation	>300%
Temperature	190F (87C)
Color	Nasa Blue, Green, Grey, Royal Blue
Rubber	Premium NBR
RTGP	8×10^6 ohms
RTT	2×10^8 ohms
Charge Decay	0.01Seconds

Part Numbers:

TMK1624B	Tray Liner, 16" x 24" x .060", 15' Ground Cord, Wrist Strap Set, Snap Kit, Outlet Adapter and Eyelet Adapter
TMK2436B	Mat, 24" x 36" x .080", 15' Ground Cord, Wrist Strap Set, Snap Kit, Outlet Adapter and Eyelet Adapter
TMK2448B	Mat, 24" x 48" x .080", 15' Ground Cord, Wrist Strap Set, Snap Kit, Outlet Adapter and Eyelet Adapter
TMK2460B	Mat, 24" x 60" x .080", 15' Ground Cord, Wrist Strap Set, Snap Kit, Outlet Adapter and Eyelet Adapter
TMK2472B	Mat, 24" x 72" x .080", 15' Ground Cord, Wrist Strap Set, Snap Kit, Outlet Adapter and Eyelet Adapter
TMK3060B	Mat, 30" x 60" x .080", 15' Ground Cord, Wrist Strap Set, Snap Kit, Outlet Adapter and Eyelet Adapter
TMK3072B	Mat, 30" x 72" x .080", 15' Ground Cord, Wrist Strap Set, Snap Kit, Outlet Adapter and Eyelet Adapter
TMK3648B	Mat, 36" x 48" x .080", 15' Ground Cord, Wrist Strap Set, Snap Kit, Outlet Adapter and Eyelet Adapter
TMK3660B	Mat, 36" x 60" x .080", 15' Ground Cord, Wrist Strap Set, Snap Kit, Outlet Adapter and Eyelet Adapter
TMK3672B	Mat, 36" x 72" x .080", 15' Ground Cord, Wrist Strap Set, Snap Kit, Outlet Adapter and Eyelet Adapter

Replace "B" at the end of the part number with "RB" for royal blue, "GN" for green or "GY" for grey

The ESD matting is rated to 190F (87C). The mats are heat resistant, not heat proof. They will withstand exposure to high temperatures, but it is dependent on exposure time.

This document is prepared for our customers as a service, and is to the best of our knowledge true and accurate. However, it is understood and agreed by the users of this document that we will accept no liability for the conclusions reached. Users of this document may therefore wish to perform additional testing before determining that products mentioned are suitable.