

# RCMM Compact LED multi color beacon

- 110 mm Ø large compact modular LED multi color beacon with multifunction table
- milky lens provides nice, homogenous light
- all 7 colors externally controllable
- Function upgrade: Multifunction table adjustable via new dip switch
- high protection class IP66 & impact resistance IK08
- base modules for all required mounting types
- can be combined with 32-tone sounder
- extensive accessories (mounting brackets, seals, cable glands)

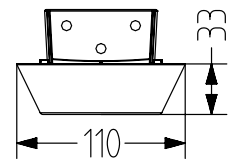
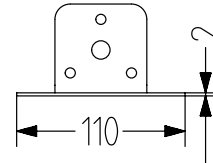
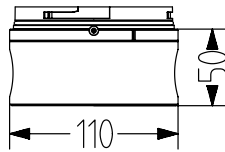
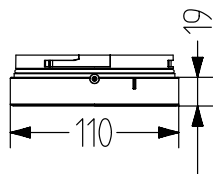
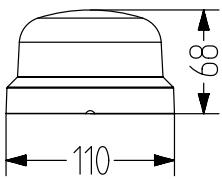

## TECHNICAL DATA

Size	110 mm
Housing	Polycarbonate black or white
Lens	Polycarbonate, smooth (milky-white), colours: red, yellow, green, blue, clear, magenta, turquoise
Type of mounting	Any
Cable entry	Depending on the base, grommet or cable gland (cable entry from below and from the side)
Connection technology	Screw terminal
Leakage current	3mA

Beacon type	Multicolor & multifunction beacon
Light source	LED
Duty cycle	100 %
Service life	Light source > 50.000 h
Operating temperature	-30 / +60°C
Degree of protection	IP66, UL Type 4, 4X, 13
Impact resistance	IK08

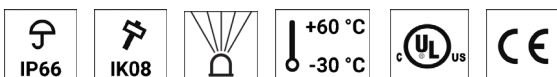

# RCMM

## ORDER DATA

Type	Color	24-48VAC/DC	110-240VAC	Nominal voltage	Voltage range (V)	Nominal current
RCMM	black	850570408		24/48VAC/DC	+/-10%	160mA
	black		850570313	110/120/230/240VAC	+/-10%	45mA
	white	850870408		24/48VAC/DC	+/-10%	160mA
	white		850870313	110/120/230/240VAC	+/-10%	45mA



RBA



RBL



RBH



RBNPT

## BASES

Type	Type of product	24-48 V AC/DC	110-240 V AC
RBA	Audible base for R series beacons	850535408	850535313
RBL	Standard base for horizontal & vertical mounting, black		850500900
RBL	Standard base for horizontal & vertical mounting, white		850800900
RBH	Universal base for horizontal and pole mounting		850510900
RBNPT	Universal base for NPT 1/2" conduit mounting		850515900



RWD



RWU



RWA



RG1



RG2



AKV



RKV

## ACCESSORIES

Type	Type of accessory	Order number
RWD	Design bracket for wall mounting of R-series beacons	850520900
RWU	Metal bracket for wall mounting of R-series beacons	850521900
RWA	Metal bracket for audible bases	850531900
RG1	Flat gasket for R-series bases for sealing onto smooth housings	850590900
RG2	Flat gasket for mounting the RWD designer bracket on walls	850590910
AKV	Cable gland M20 for N/M/R-series, CT5, multitone sirens A and/or beacons Q	698800026
RKV	Cable gland M16 for R series bases	850590920