

# BC7-12-GE

# 2000 lb WLL

## LOW PROFILE BEAM CLAMP WITH GIMBALED EYE

## BeamWare™



20° Gimbaled Hang Point

### GIMBALED BEAM CLAMP

Standard, pre-engineered channel style beam clamps anchor to a building's beam structure to provide a safe and predictable method of rigging grids, clusters, arrays and other objects.

The Gimbaled Style beam clamp is unique in that it offers a gimbaled swivel eye that accommodates up to 20 degrees of off-axis side loading in any direction without losing any of its working load.

The gimbaled feature is especially predictable when bridling suspended objects from wire rope, rigging chain, span sets, etc.

The body of the clamp mounts flush underneath the building's I-beams and side clamps adjust to accommodate beam flange widths between 7" and 12".



### STANDARD FEATURES:

- ▶ Accommodates thicker beam flanges
- ▶ Gimbaled hang point swivels 360°
- ▶ Hang point retains same WLL from 0°- 20°
- ▶ Wide body provides extra clamp stability
- ▶ Non-loosening fasteners

### OPTIONAL ACCESSORIES:

- ▶ See Wire Rope Datasheet
- ▶ See Rigging Components Datasheet

\* Not for human suspension

### SPECIFICATIONS:

**Materials:** Alloy Steel Components

**Width:** 7" to 12" / 178mm to 305mm

**Color:** Black

**Design Factor:** 5:1

**Vertical WLL\*:** 2000 lbs / 908 Kg. WLL (Vertical)

**20 DEG. WL:** 2000 lbs / 908 Kg. WLL

**45 DEG. WL:** 1200 lbs / 545 Kg.

**90 DEG. WL:** Do Not Exceed 65°

\* WLL = Working Load Limit

### PACKAGE CONTENTS:

1 pc 16" Channel

2 pcs Lock / Angle Bracket

1 pc Eyebolt, 5/8"

1 pc Swivel Ball

5 pcs Flatwasher, 5/8

2 pcs Nyloc & Nut, 5/8 - 11

1 pc Hex Nut, 5/8 - 11

2 pcs Hex Bolt, 5/8-11X5.5" Long

2 pcs 1/4 spacer

2 pcs 1/2 spacer

2 pcs 1.00 spacer



Rated for indoor use.

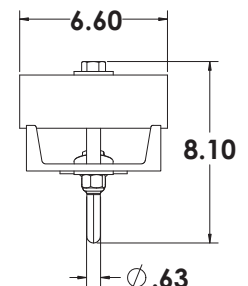
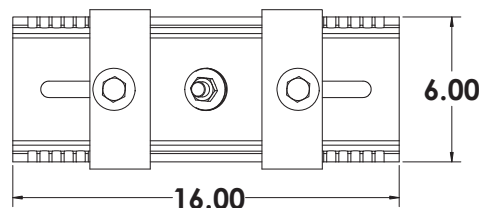
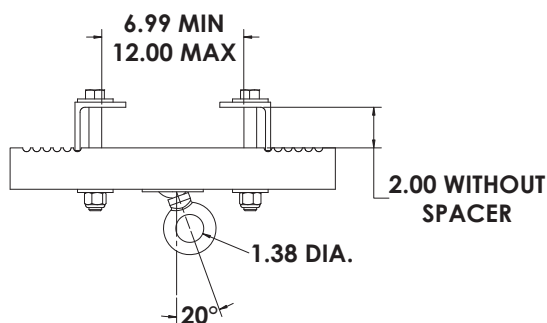

**Adaptive Technologies Group**  
1635 E. Burnett Street | Signal Hill, CA 90755 USA  
Ph: 562.424.1100 | Fax: 562.424.3520  
www.adaptivetechgroup.com



### ALWAYS INSTALL SAFETY CABLES

**WARNING:** Mounting and/or suspension of equipment requires experienced professionals. Improperly installed equipment can result in property damage, personal injury and/or liability to the installing contractor.