

SAW Filter 1191.8 MHz
Part No: MP07513

Model: TA1924A
Rev No: 1

Electrostatic Sensitive Device (ESD)

A. MAXIMUM RATING:

1. Input Power Level: 10 dBm
2. DC Voltage: 3 V
3. Operating temperature range: -40 °C to +85 °C
4. Storage temperature range: -40 °C to +85 °C
5. Moisture Sensitivity Level: Level 1 (MSL 1)

B. ELECTRICAL CHARACTERISTICS:

Item	Unit	Min.	Typical	Max.
Center frequency Fc	MHz	-	1191.8	-
Insertion loss (1164.3~1219.3 MHz) IL	dB	-	2.4	4.0
Amplitude Ripple (1169.8~1213.8 MHz)	dB	-	0.7	1.2
Group delay ripple (1164.3~1219.3 MHz)	ns	-	18	50
Attenuation (Reference level from 0 dB)				
10 ~ 1040 MHz	dB	37	40	-
1040 ~ 1126 MHz	dB	20	33	-
1256 ~ 1345 MHz	dB	20	32	-
1345 ~ 1650 MHz	dB	27	30	-
1650 ~ 3000 MHz	dB	25	28	-
Temperature coefficient of frequency	ppm/k	-	-36	-

C. MEASUREMENT CIRCUIT:

HP Network analyzer

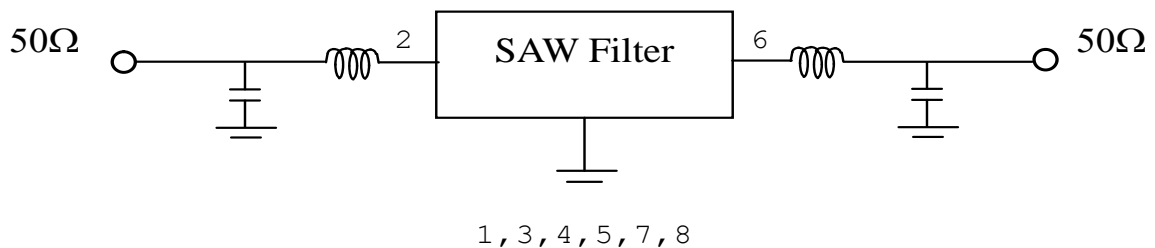

SAW Filter 1191.8 MHz
Part No: MP07513

Model: TA1924A
Rev No: 1

D. FREQUENCY CHARACTERISTICS:

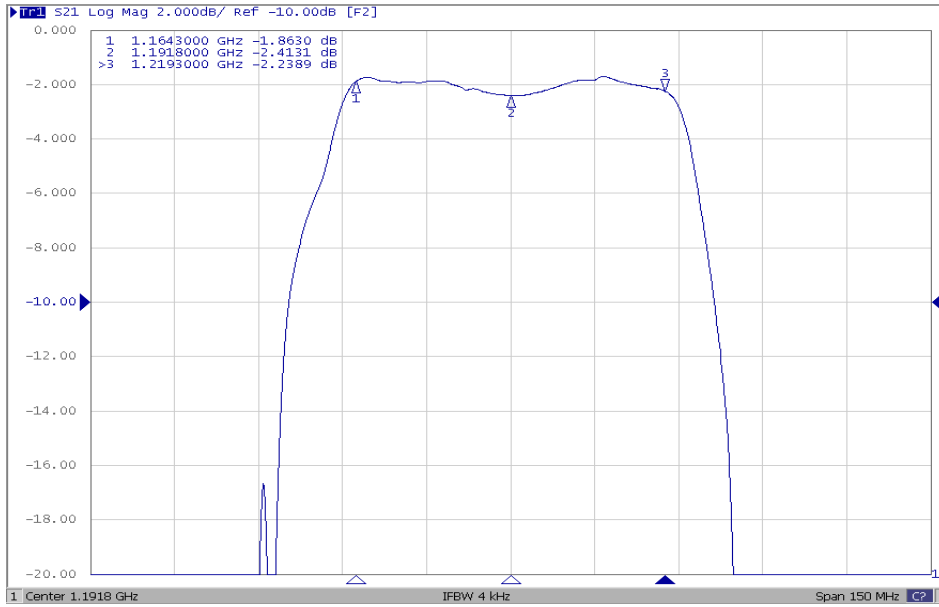

SAW Filter 1191.8 MHz
Part No: MP07513

Model: TA1924A
Rev No: 1

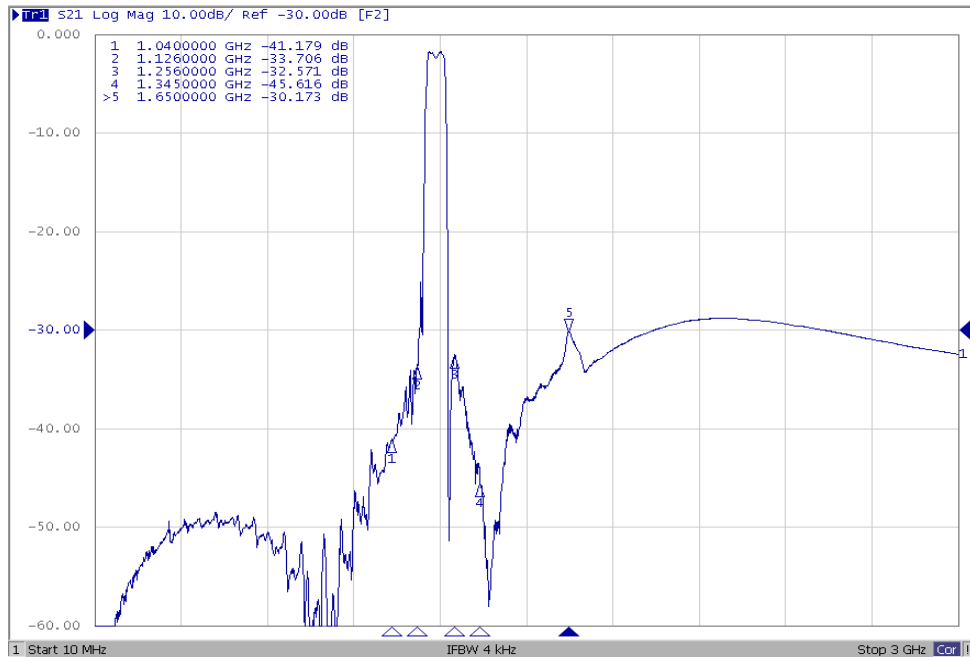

E OUTLINE DRAWING:

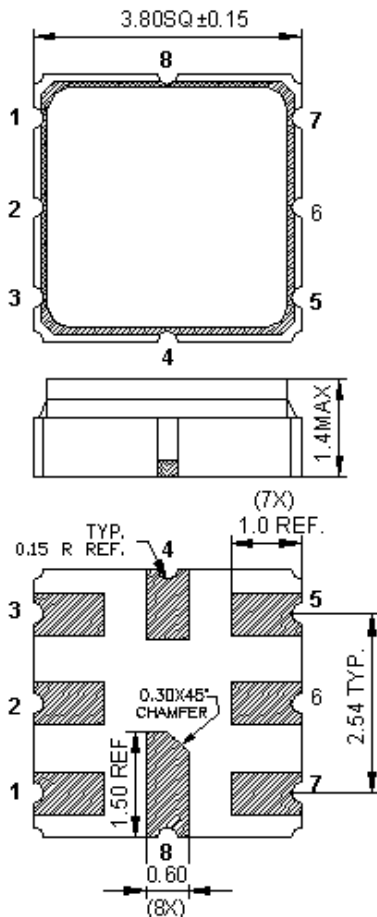

All tolerances are ± 0.05 mm unless otherwise specified
 Unit : mm

SAW Filter 1191.8 MHz
Part No: MP07513

Model: TA1924A
Rev No: 1

F. PCB FOOTPRINT

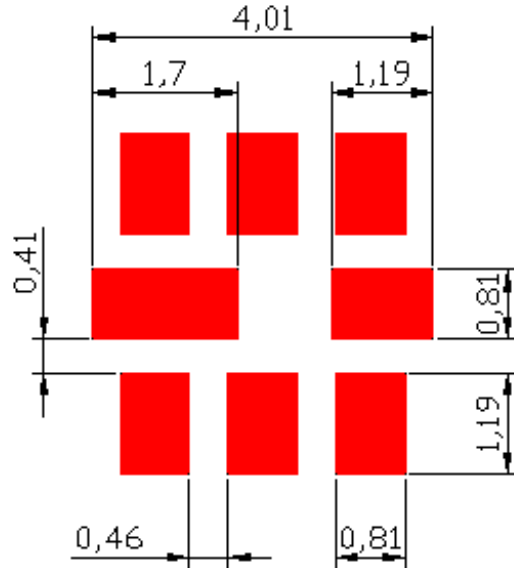

G. PACKING:

1. Reel dimension

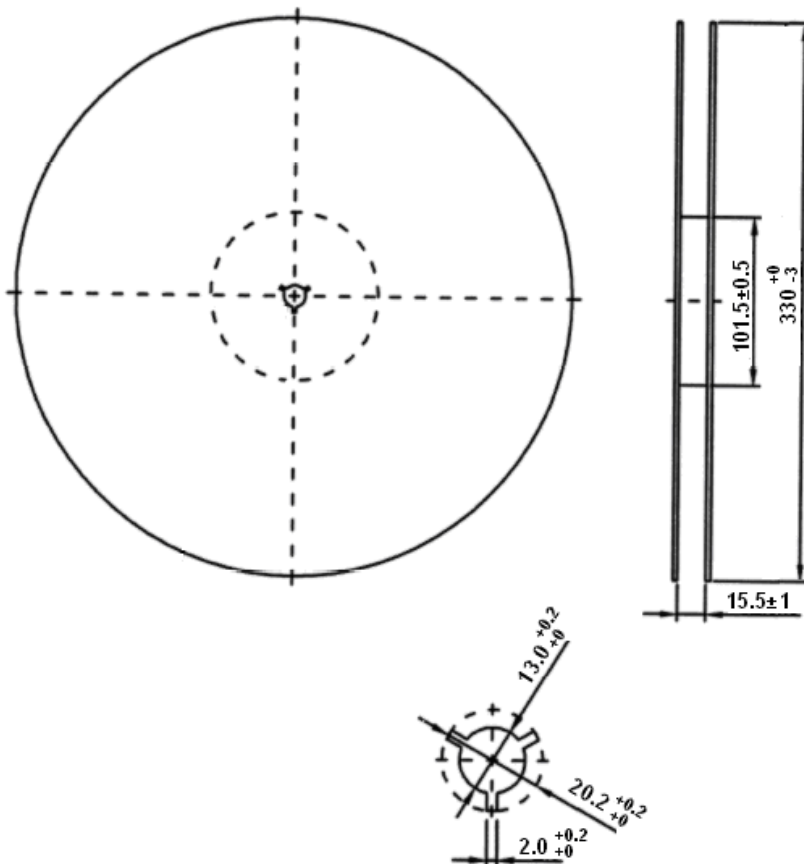

SAW Filter 1191.8 MHz
Part No: MP07513

Model: TA1924A
Rev No: 1

2. Tape dimension

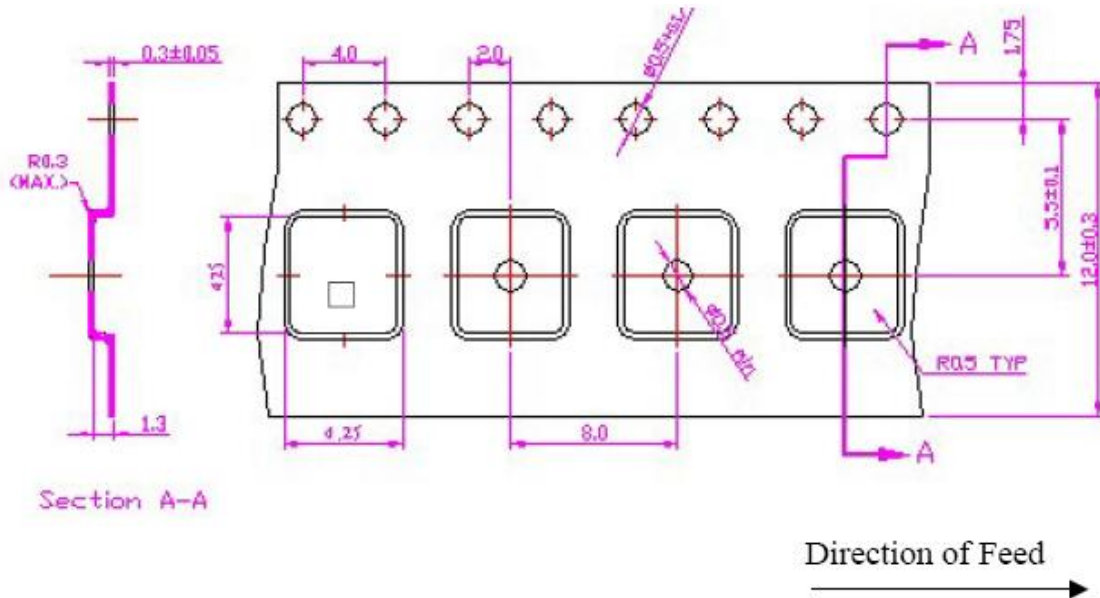

H. ECOMMENDED REFLOW PROFILE:

1. Preheating shall be fixed at 150~180°C for 60~90 seconds.
2. Ascending time to preheating temperature 150°C shall be 30 seconds min.
3. Heating shall be fixed at 220°C for 50~80 seconds and at 260°C+0/-5°C peak (20~40sec).
4. Time: 2 times.

