

BILL OF MATERIALS			
ITEM	QTY.	Unit	DESCRIPTION
1	1	EA	CONNECTOR INTERFACE HOUSING, WHITE BRONZE
2	1	EA	INNER CONTACT, BRASS /GOLD
3	1	EA	WIRE SUPPORT (SEE PREPARATION TABLE FOR USAGE)
4	1	EA	6.6mm ID FERRULE CRIMP RING, WHITE BRONZE
5	20	mm	Ø7.6mm ID HEAT SHRINK PE MATERIAL,BLACK

ASSEMBLY INSTRUCTIONS:

- CUT CABLE TO DESIRED LENGTH
- SLIP HEAT SHRINK AND CRIMP RING OVER CABLE END.
- STRIP CABLE AS SHOWN BELOW
- SLIDE SMALL WIRE SUPPORT [FN3] OVER END CONDUCTOR BACK TO PTFE.
- SOLDER CENTER CONDUCTOR TO CENTER CONTACT [FN2] △2
- INSERT CENTER CONDUCTOR INTO HOUSING UNTIL CONNECTOR CLICKS INTO PLACE.
- SPREAD SHIELDING BRADE OVER HOUSING END.
- SLIDE CRIMP RING IN PLACE AND CRIMP USING APPROPRIATE CRIMP TO FOR WIRE SIZE. △1 △2
- SLIDE HEAT SHRINK OVER CRIMP RING AND SHRINK IN PLACE USING HEAT GUN.

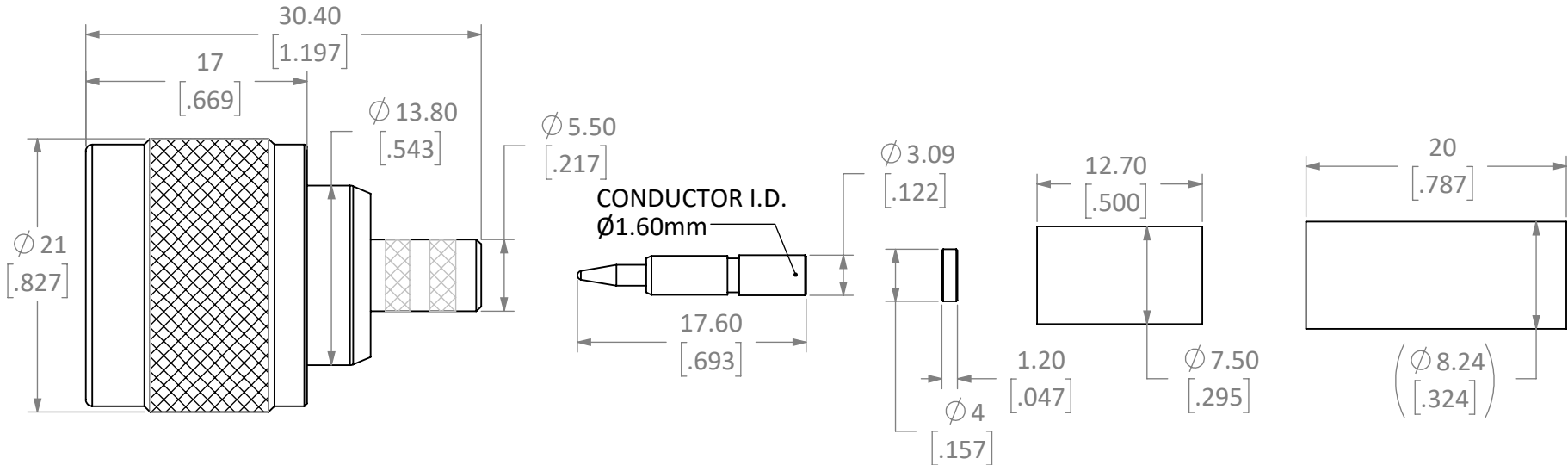
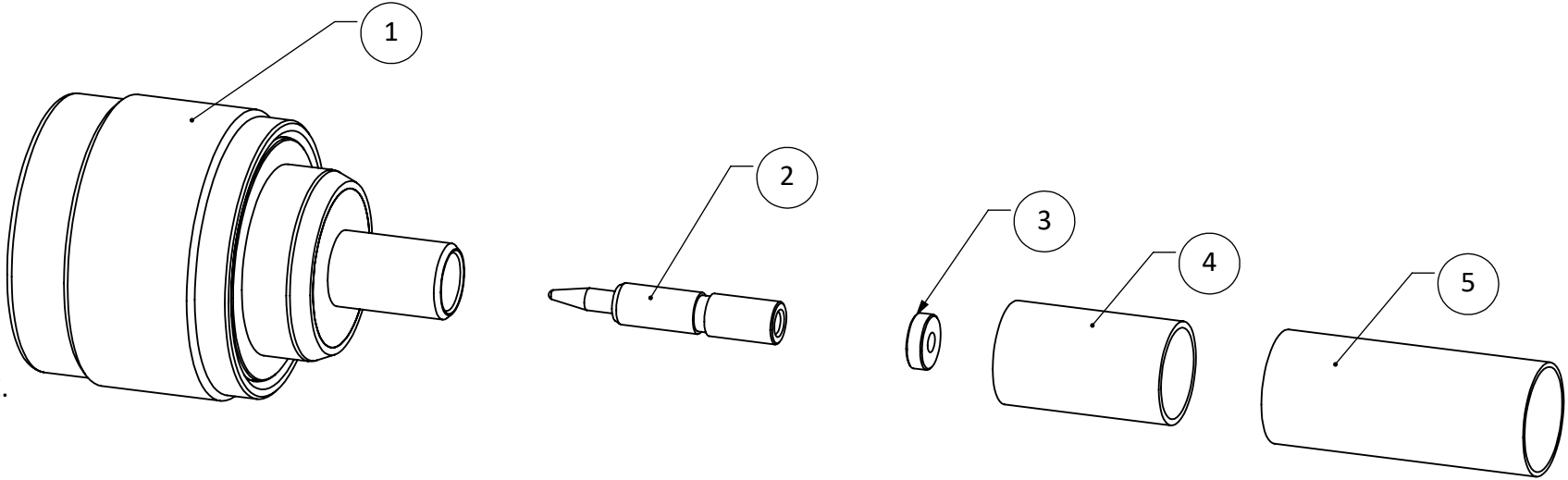

NOTES: (UNLESS OTHERWISE SPECIFIED)

- ALL DIMENSIONS ARE IN MILLIMETER [inch].
- DIMENSIONS APPLY AFTER FINISHING.
- MANUFACTURE TO BE COMPLIANT WITH EU RoHS DIRECTIVE,USE MATERIALS THAT DO NOT CONTAIN REACH SUBSTANCES OF VERY HIGH CONCERN >1000ppm, AND USE DRC CONFLICT-FREE SOURCED MATERIALS.
- IMPEDANCE: 50Ω
- FREQUENCY RANGE: DC 0-11 GHz
- VSWR: 1.3 Max @ 6 GHz
- MAX DIELECTRIC: 2500Vrms min.
- CONTACT RESISTANCE:
  - INNER: 1.0mΩ MAX
  - OUTER: 1.0mΩ MAX
- INTERFACE IAW MIL-STD-348A
- OPERATING TEMP: -60°~165°C
- CRIMPED SIZE:
  - △1 FERRULE: HEX CRIMP 5.41mm [215in]
  - △2 CONTACT: HEX CRIMP 2.54 [.100in]
- SEE TABLE FOR RECOMMENDED STRIPPING DIMENSIONS
- DURABILITY: 500 CYCLES MIN

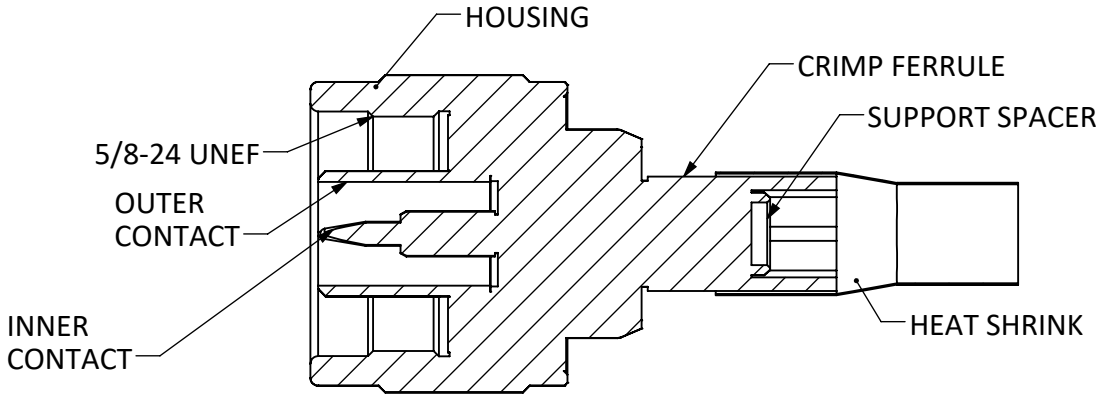
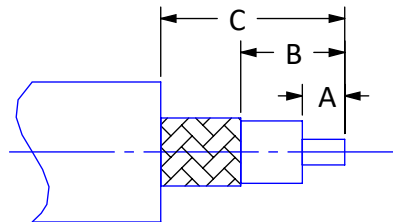

SOLID SHARING MODEL VIEW

CABLE TYPE	DIM A	DIMB	DIM C	WIRE SUPPORT SPACER REQUIRED
LMR-240	4.7 [.195]	8.1 [.318]	15.85 [.624]	YES
RG-8/X	3.5 [.138]	8.1 [.318]	15.85 [.624]	NO

**WARNING:** THIS DRAWING CONTAINS PROPRIETARY INFORMATION THAT IS THE SOLE PROPERTY OF LINX TECHNOLOGIES, AND SHALL BE TREATED AS SUCH. NO DISCLOSURE OR REPRODUCTION OF THIS DOCUMENT IS PERMITTED, IN WHOLE OR IN PART, WITHOUT THE EXPRESS WRITTEN PERMISSION OF LINX TECHNOLOGIES OR ITS DESIGNATED AGENTS.

MATERIAL: BRASS	INTERPRET DIMENSIONS AND TOLERANCES PER ASME Y14.5.		PROJECTION: 
WEIGHT:	.X ±2.0 .XX ±1.00 .XXX ±.500	ANGLES: ±1° SURFACE:	
FINISH: WHITE BRONZE GOLD CONTACT PIN	DRAWN: JHAGER ENGR: DASARATHAN	DT: 9/11/20 DT: 9/21/20	



159 ORT LANE  
MERLIN, OR 97532

TITLE:  
**CONNECTOR, N, CRIMP, LMR-240**

SIZE **B** DWG. NO. **C-CONN007-2-W** REV **1**

SCALE: 2:1 DO NOT SCALE DRAWING SHEET 1 OF 1