



WR-34 Waveguide Electromechanical Relay SPDT/
 DPDT Latching Switch, Ka Band 33 GHz Max.
 Freq., 620 Watts, UG Cover, 28V, Self Cut Off

Waveguide Electromechanical Relay Switches Technical

PEWGS6040

Features

- 22 to 33 GHz SPDT Waveguide Switch
- Optional DPDT Configuration
- WR-34 Waveguide
- Insertion Loss: 0.15 dB Max
- Isolation: 60 dB min
- +28 Vdc Nominal Voltage
- Input Power Rating up to 0.62 KW CW max
- Latching Self Cut Off Actuator
- Position Indicator and Manual Override Access
- Fully Weatherized Package
- Quick Connect Circular DC Connector with Mate
- -40°C to +85°C Operating Temperature

Applications

- Electronic Warfare
- Electronic Countermeasures
- Microwave Radio
- VSAT
- Radar
- Space Systems
- Test Instrumentation
- Research and Development

Description

The PEWGS6040 electromechanical WR-34 waveguide switch operates across a wide frequency range from 22 GHz to 33 GHz and is configured for single pole double throw (SPDT) operation. A shorting plate on port 3 can be removed for optional double pole double throw (DPDT) operation. This innovative design features a latching Self Cut Off actuator and patented motor drive with arc suppression. The motor drive housing supports a viewable position indicator window and a cover that can be removed for manual override access.

Impressive performance includes 0.15 dB max insertion loss, 60 dB min Isolation, 1.15:1 max VSWR, and an operating life of 250K cycles minimum. The design operates across a temperature range of -40°C to +85°C, requires +28Vdc nominal bias voltage, and has an input power rating of up to 0.62 KW CW maximum. The waveguide ports have standard UG Cover with Custom O-Ring Groove Flanges. The rugged package design is fully weatherized for up to 100% humidity exposure and supports a quick connect circular 6 pin MIL-SPEC DC bias connector with mate included.

Electrical Specifications

Switch Type	SPDT/DPDT
Actuator Type	Latching
Actuator Options	Self Cut Off, Set Indicators, Manual Override, Viewing Window

Description	Minimum	Typical	Maximum	Units
Frequency Range	22		33	GHz
Operating Voltage	21	28	32	Volts
Actuating Current @ 28 Volts			1	A
VSWR			1.15:1	
Insertion Loss			0.15	dB
Isolation	60			dB
Switching Time		80		ms
Input Power (CW)			620	Watts

Click the following link (or enter part number in "SEARCH" on website) to obtain additional part information including price, inventory and certifications: [WR-34 Waveguide Electromechanical Relay SPDT/DPDT Latching Switch, Ka Band 33 GHz Max. Freq., 620 Watts, UG Cover, 28V, Self Cut Off PEWGS6040](#)



WR-34 Waveguide Electromechanical Relay SPDT/
DPDT Latching Switch, Ka Band 33 GHz Max.
Freq., 620 Watts, UG Cover, 28V, Self Cut Off

Waveguide Electromechanical Relay Switches Technical

PEWGS6040

Mechanical Specifications

Size

Operating Life 250,000 Cycles
Operating Pressure 30 psig

Configuration

Waveguide Size WR-34
Flange Type UG Cover
Body Material and Plating Aluminum, Gold
Body Plating Specification MIL-DTL-5541

Environmental Specifications

Temperature

Operating Range -40 to +85 deg C
Storage Range -55 to +100 deg C

Humidity 0 to 100%, Fully Weatherized

Compliance Certifications (see [product page](#) for current document)

Plotted and Other Data

Notes:

Typical Performance Data

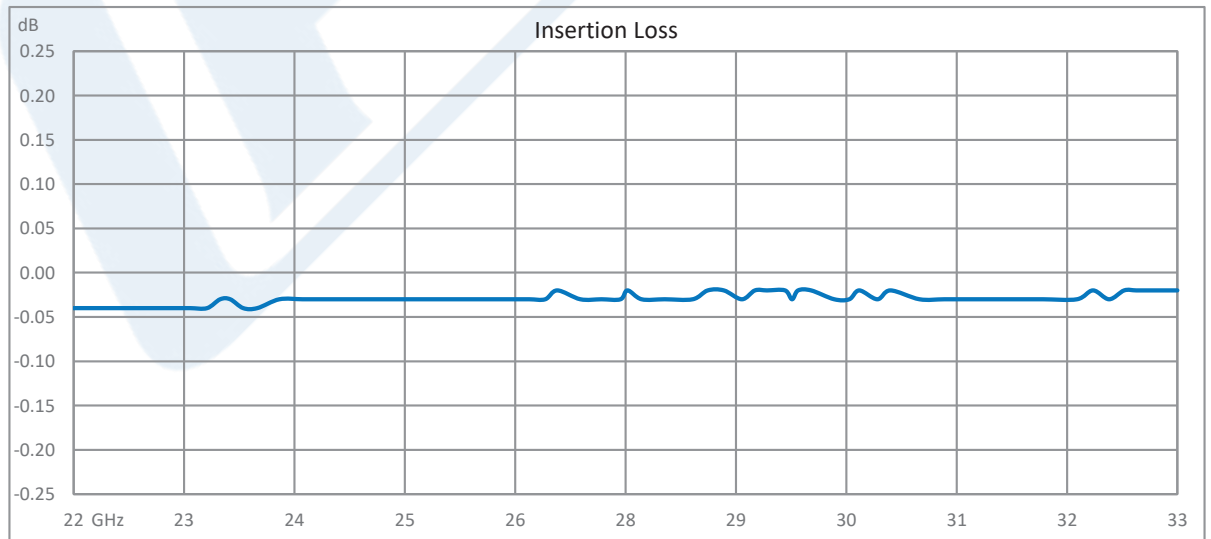

Click the following link (or enter part number in "SEARCH" on website) to obtain additional part information including price, inventory and certifications: [WR-34 Waveguide Electromechanical Relay SPDT/DPDT Latching Switch, Ka Band 33 GHz Max. Freq., 620 Watts, UG Cover, 28V, Self Cut Off PEWGS6040](#)



WR-34 Waveguide Electromechanical Relay SPDT/
DPDT Latching Switch, Ka Band 33 GHz Max.
Freq., 620 Watts, UG Cover, 28V, Self Cut Off

Waveguide Electromechanical Relay Switches Technical

PEWGS6040

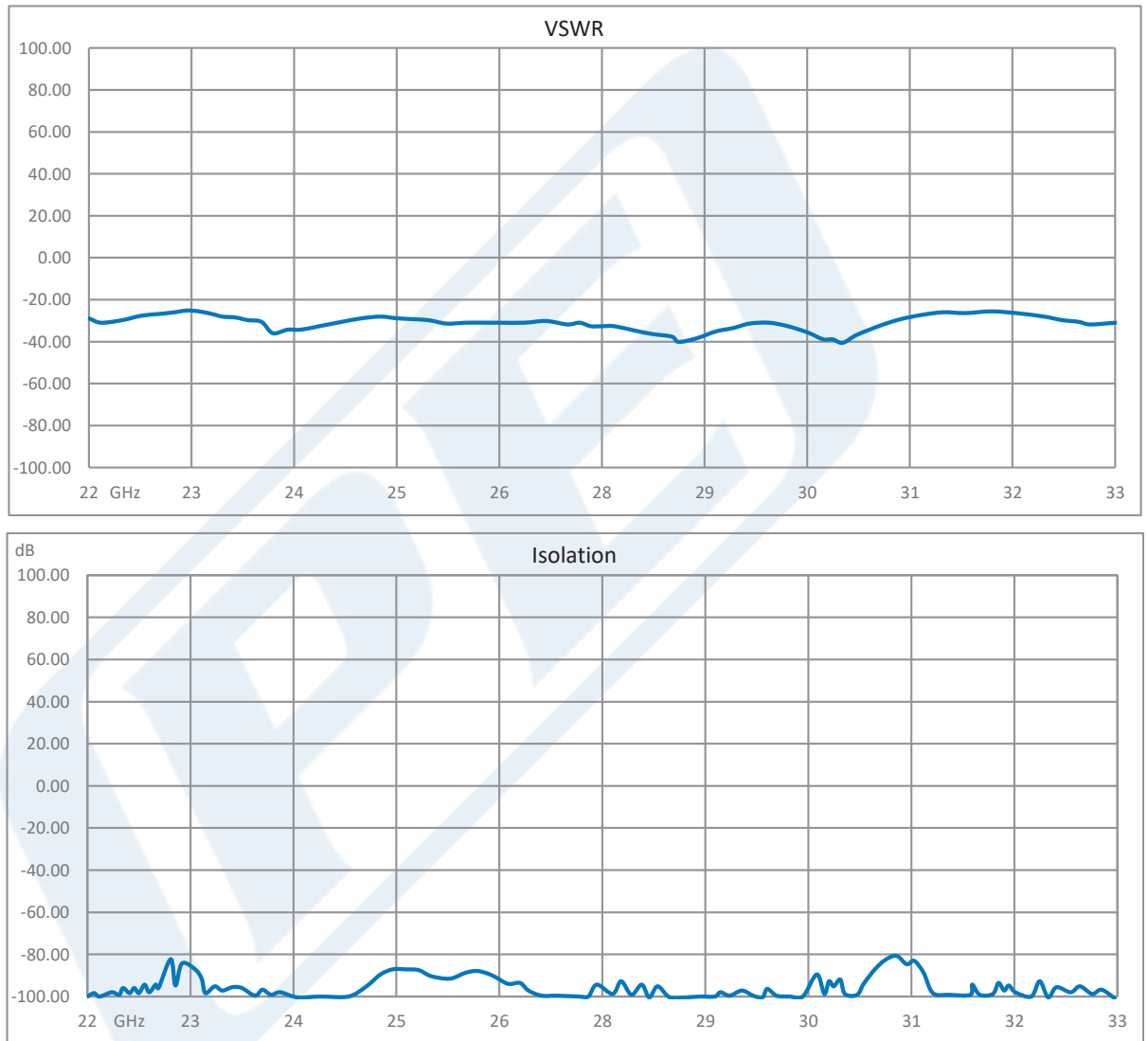

Click the following link (or enter part number in "SEARCH" on website) to obtain additional part information including price, inventory and certifications: [WR-34 Waveguide Electromechanical Relay SPDT/DPDT Latching Switch, Ka Band 33 GHz Max. Freq., 620 Watts, UG Cover, 28V, Self Cut Off PEWGS6040](#)



WR-34 Waveguide Electromechanical Relay SPDT/
DPDT Latching Switch, Ka Band 33 GHz Max.
Freq., 620 Watts, UG Cover, 28V, Self Cut Off

Waveguide Electromechanical Relay Switches Technical

PEWGS6040

WR-34 Waveguide Electromechanical Relay SPDT/DPDT Latching Switch, Ka Band 33 GHz Max. Freq., 620 Watts, UG Cover, 28V, Self Cut Off from Pasternack Enterprises has same day shipment for domestic and International orders. Our RF, microwave and millimeter wave products maintain a 99.4% availability and are part of the broadest selection in the industry.

Click the following link (or enter part number in "SEARCH" on website) to obtain additional part information including price, inventory and certifications: [WR-34 Waveguide Electromechanical Relay SPDT/DPDT Latching Switch, Ka Band 33 GHz Max. Freq., 620 Watts, UG Cover, 28V, Self Cut Off PEWGS6040](https://www.pasternack.com/wr-34-waveguide-electromechanical-relay-spd-dpdt-latching-switch-33-ghz-pewgs6040-p.aspx)

URL: <https://www.pasternack.com/wr-34-waveguide-electromechanical-relay-spd-dpdt-latching-switch-33-ghz-pewgs6040-p.aspx>

The information contained in this document is accurate to the best of our knowledge and representative of the part described herein. It may be necessary to make modifications to the part and/or the documentation of the part, in order to implement improvements. Pasternack reserves the right to make such changes as required. Unless otherwise stated, all specifications are nominal. Pasternack does not make any representation or warranty regarding the suitability of the part described herein for any particular purpose, and Pasternack does not assume any liability arising out of the use of any part or documentation.

PEWGS6040 CAD Drawing

WR-34 Waveguide Electromechanical Relay SPDT/DPDT Latching Switch,
Ka Band 33 GHz Max. Freq., 620 Watts, UG Cover, 28V, Self Cut Off

REVISIONS			
REV.	DESCRIPTION	DATE	APPROVED
A	INITIAL RELEASE	07/16/19	T. GALLA

- NOTES:
1. MANUAL OVERRIDE & POSITION INDICATOR.
 2. WEATHERIZED COVER WITH CLEAR VIEWING WINDOW.
 3. FOR ACCESS TO MANUAL OVERRIDE LOOSEN (2) CAPTIVE SCREWS.

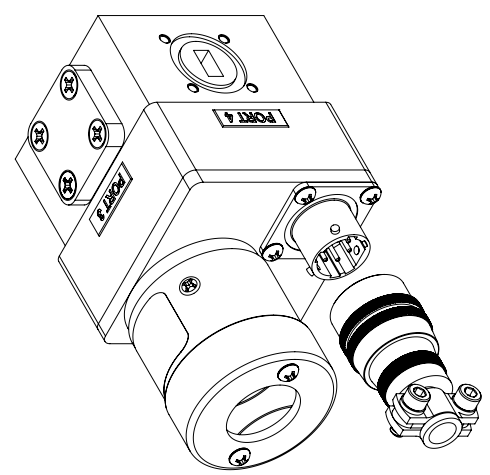
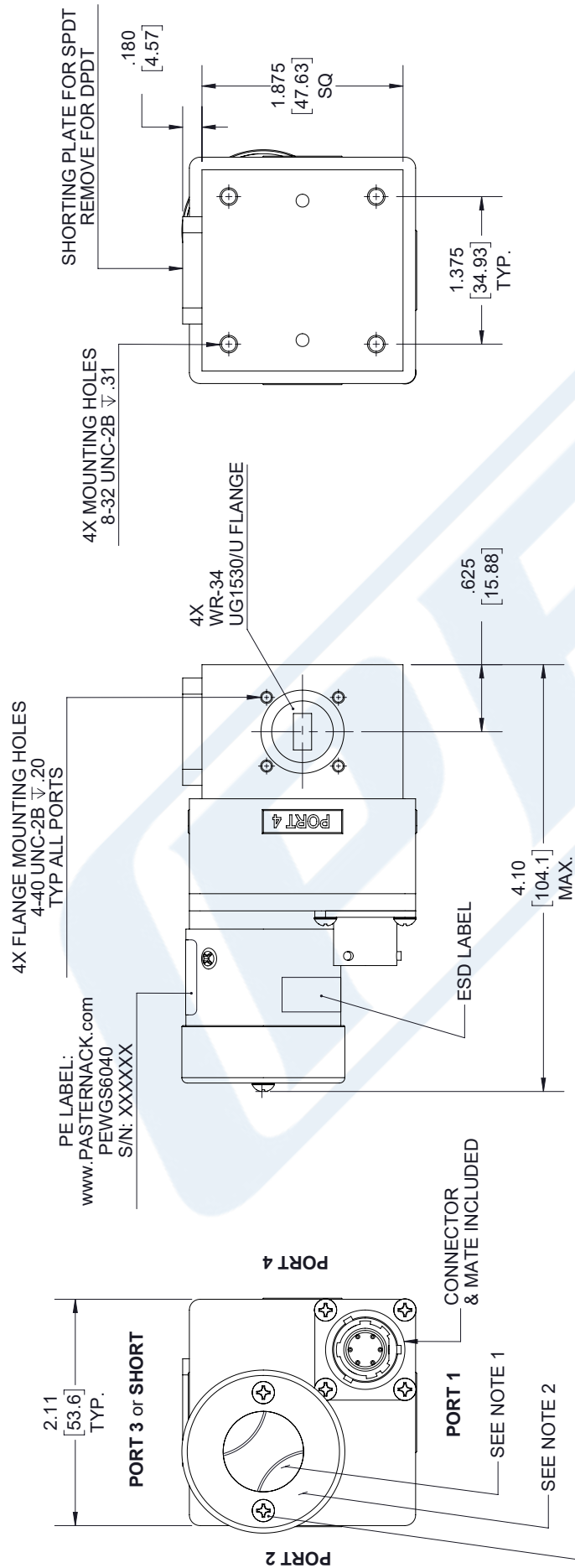

<p>UNLESS OTHERWISE SPECIFIED LEADING DIMENSIONS ARE INCHES DIMENSIONS IN [] ARE MILLIMETERS</p> <p>TOLERANCES:</p> <table border="0"> <tr> <td>X±.2</td> <td>[5.08]</td> <td>FRACTIONS</td> </tr> <tr> <td>XX±.01</td> <td>[.25]</td> <td>±.132</td> </tr> <tr> <td>.XXX±.005</td> <td>[.13]</td> <td>ANGLES ± 1°</td> </tr> </table> <p>ALL DIMENSIONS SHOWN ARE FOR REFERENCE ONLY.</p> <p>THIRD-ANGLE PROJECTION</p>		X±.2	[5.08]	FRACTIONS	XX±.01	[.25]	±.132	.XXX±.005	[.13]	ANGLES ± 1°	<p>THE INFORMATION AND DESIGN IN THIS DOCUMENT IS THE PROPERTY OF PASTERNAK CORPORATION. ALL RIGHTS RESERVED.</p> <p>SHEET 1 OF 2</p> <p>SCALE N/A</p>	
X±.2	[5.08]	FRACTIONS										
XX±.01	[.25]	±.132										
.XXX±.005	[.13]	ANGLES ± 1°										
<p>www.pasternack.com e-mail: sales@pasternack.com</p>		<p>PASTERNAK an INFINITO brand</p> <p>Pasternack Enterprises, Inc. P.O. Box 16759, Irvine, CA 92623. Phone: 1.949.261.1920 1.866.727.8376 Fax: 1.949.261.7451</p>										
SIZE	CAGE	DRAWN BY	PART NUMBER									
A	53919	K.DANG	PEWGS6040									
REV			A									

THESE COMMODITIES, TECHNOLOGY OR SOFTWARE WERE EXPORTED FROM THE UNITED STATES IN ACCORDANCE WITH THE EXPORT ADMINISTRATION REGULATIONS. DIVERSION CONTRARY TO U.S. LAW PROHIBITED.

PEWGS6040 CAD Drawing

WR-34 Waveguide Electromechanical Relay SPDT/DPDT Latching Switch,
Ka Band 33 GHz Max. Freq., 620 Watts, UG Cover, 28V, Self Cut Off

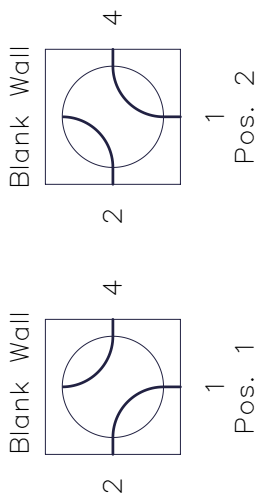

R.F. PATHS--SRDI

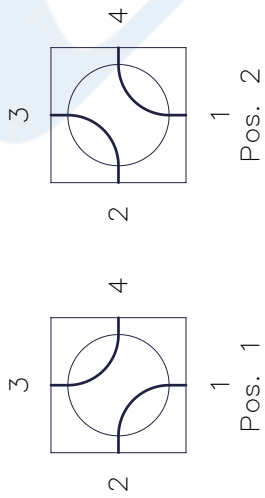

R.F. PATHS--DPDI

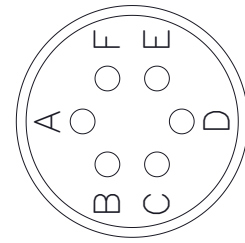
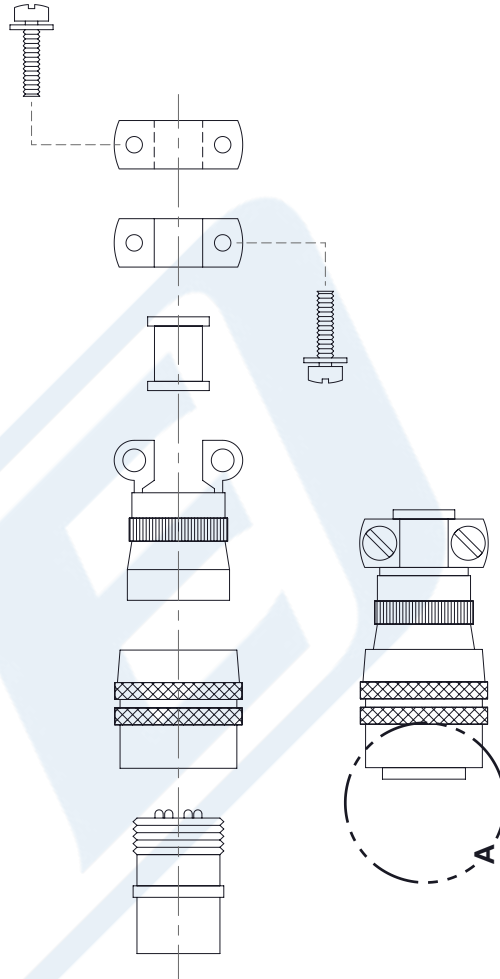
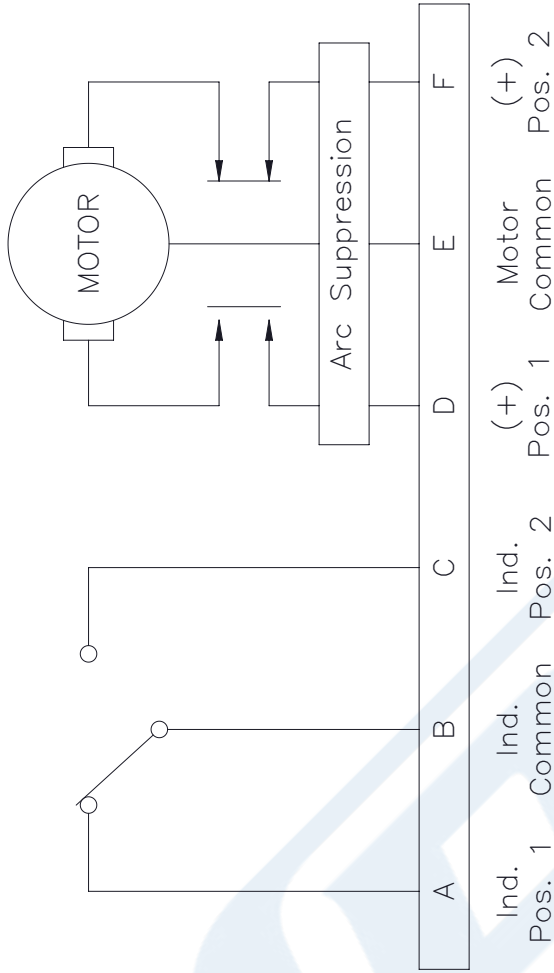

THE INFORMATION AND DESIGN IN THIS DOCUMENT IS THE PROPERTY OF PASTERNAK CORPORATION. ALL RIGHTS RESERVED.		SHEET 2 OF 2	
PE PASTERNAK an INFINITO brand Pasternack Enterprises, Inc. P.O. Box 16759, Irvine, CA 92623. Phone: 1,949,261,1920 1,866,727,8376 Fax: 1,949,261,7451 www.pasternack.com e-mail: sales@pasternack.com		SCALE N/A	
UNLESS OTHERWISE SPECIFIED LEADING DIMENSIONS ARE INCHES DIMENSIONS IN [] ARE MILLIMETERS		SIZE CAGE DRAWN BY PART NUMBER A 53919 K.DANG PEWGS6040	
TOLERANCES: X±.2 [5.08] .XX±.01 [.25] .XXX±.005 [.13]		FRACTIONS ±1/32 ANGLES ±1°	
ALL DIMENSIONS SHOWN ARE FOR REFERENCE ONLY. THIRD-ANGLE PROJECTION		REV A	

THESE COMMODITIES, TECHNOLOGY OR SOFTWARE WERE EXPORTED FROM THE UNITED STATES IN ACCORDANCE WITH THE EXPORT ADMINISTRATION REGULATIONS. DIVERSION CONTRARY TO U.S. LAW PROHIBITED.