

Customer Information Sheet

IF IN DOUBT - ASK

©

NOT TO SCALE

THIRD ANGLE PROJECTION

ALL DIMENSIONS IN mm

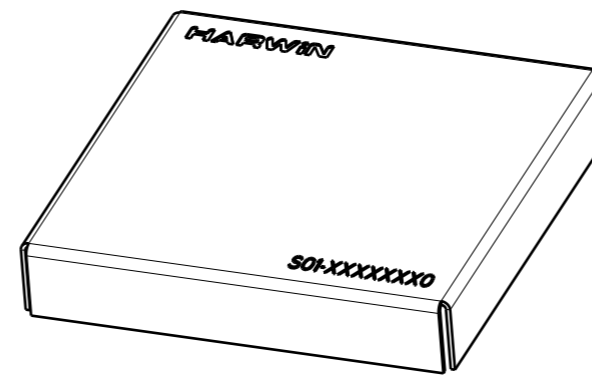
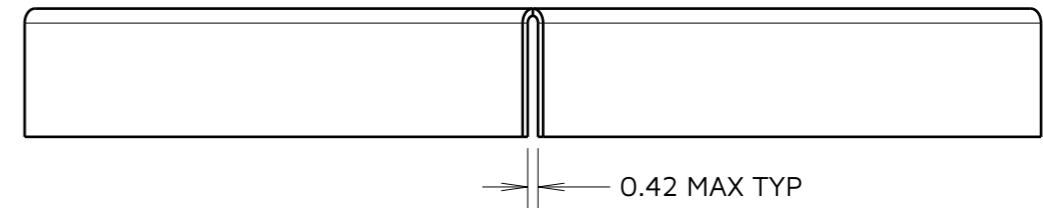
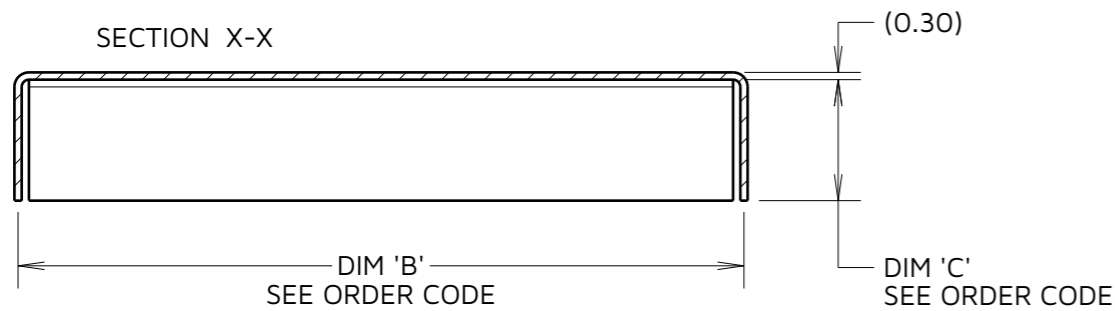
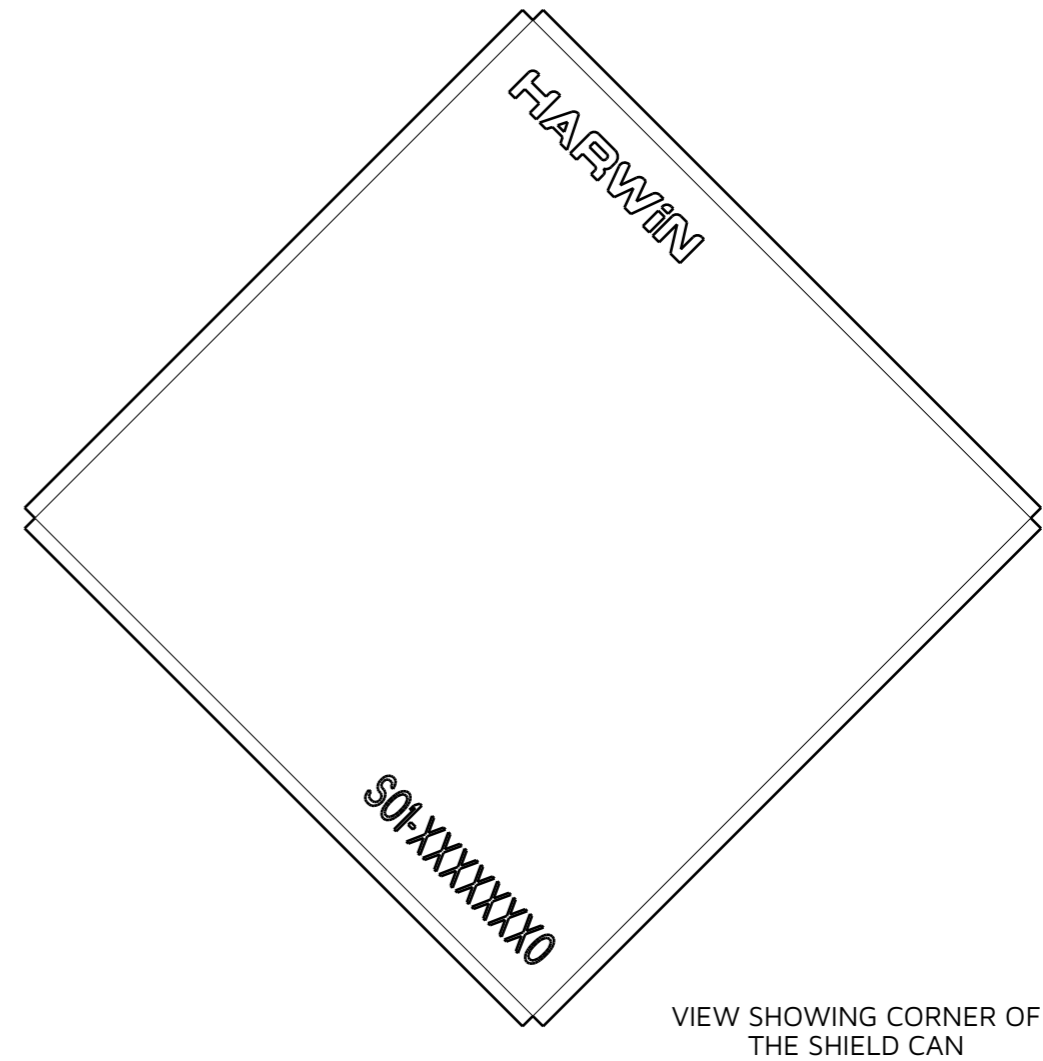
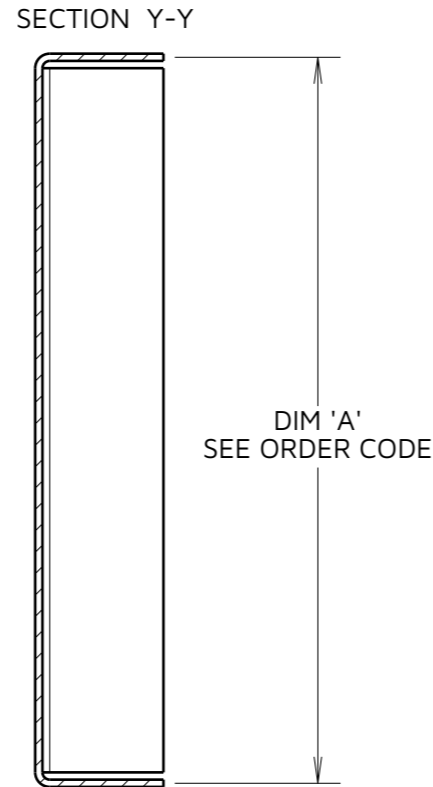
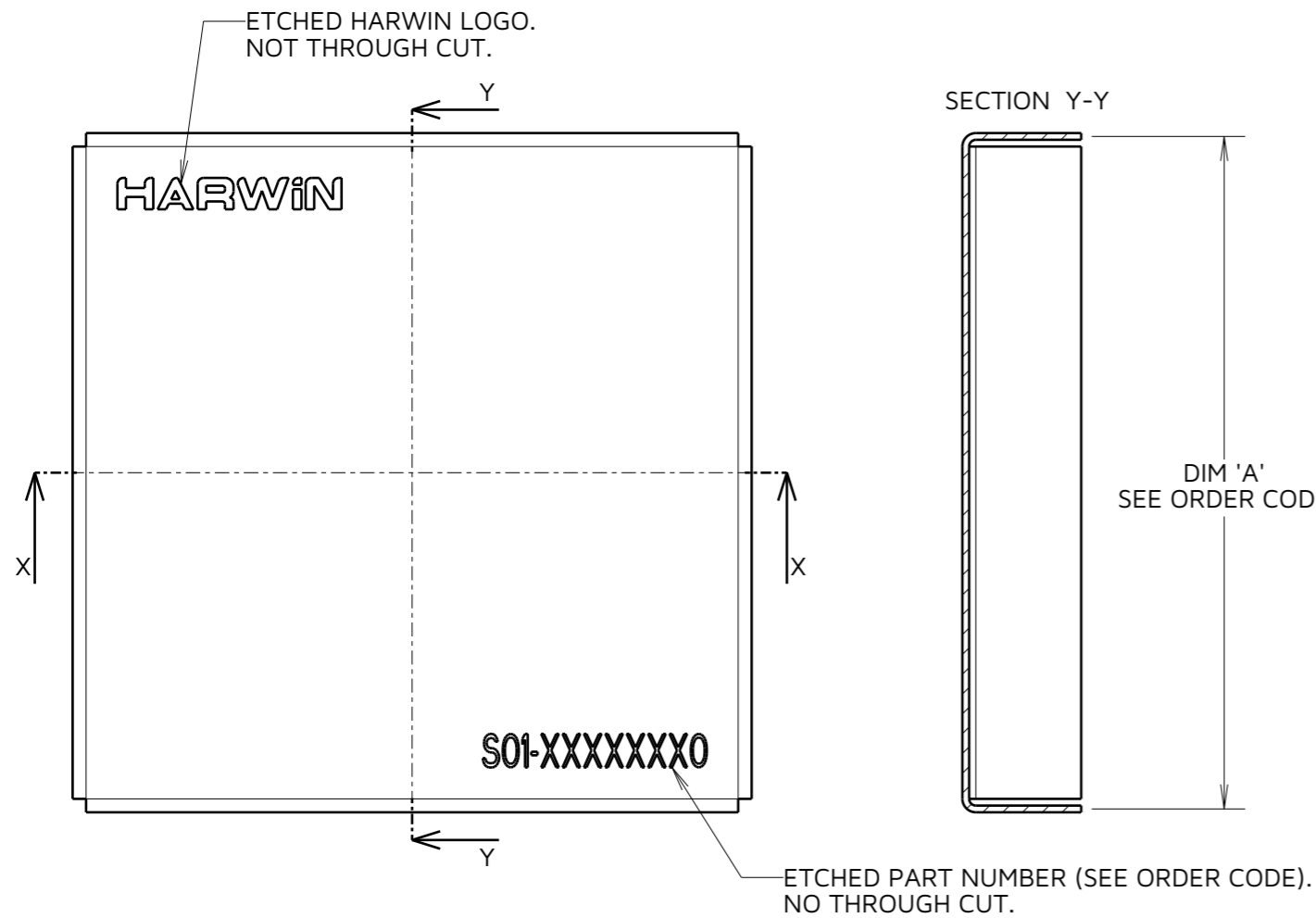

ORDER CODE:

SO1-XXXXXXXXXO

SIZE:
 DIM 'A' = LENGTH: 10-100mm
 DIM 'B' = WIDTH: 10-100mm
 DIM 'C' = HEIGHT: 3-10mm
 FINISH:
 O = UNPLATED FINISH

RTP	7	08.02.24	33642
NAME	ISS.	DATE	CN/CO
APPROVED: R.PORTLOCK			
CHECKED: A.YEOMANS			
DRAWN: S.BENNETT			
ASSEMBLY DRG:			

- NOTES:
- DIM 'C', HEIGHT OF THE CAN IS FROM THE BOTTOM EDGE TO THE INSIDE OF THE TOP FACE.
 - BOTH DIM 'A' AND 'B' ARE FROM THE CENTRE OF THE MATERIAL THICKNESS.
 - CANS ARE PACKED IN MULTIPLES IN BOXES.
 - SHIELD CAN IS RECOMMENDED FOR USE WITH RFI SHIELD CLIPS: S1711-XXR AND S2711-XXR.
 - FOR LIST OF STOCKED SHIELD CAN SIZES, SEE SO1-XXXXXXXXXO CANS ON HARWIN.COM.
 - NON STANDARD SIZES AVAILABLE, PLEASE ENQUIRE FOR MORE DETAILS.

HARWIN

www.harwin.com

TOLERANCES
 X. = ±1mm
 X.X = ±0.50mm
 X.XX = ±0.20mm
 X.XXX = ±0.01mm
 ANGLES = ±5°
 UNLESS STATED

THIS DRAWING AND ANY INFORMATION OR DESCRIPTIVE MATTER SET OUT HEREON ARE CONFIDENTIAL AND COPYRIGHT PROPERTY OF THE HARWIN GROUP AND MUST NOT BE DISCLOSED, LOANED, COPIED OR USED FOR MANUFACTURING, TENDERING OR FOR ANY OTHER PURPOSE WITHOUT THEIR WRITTEN PERMISSION.

MATERIAL:
 NICKEL SILVER, HALF HARD NS106, TO BS1653
 0.30mm THICK

TITLE:
Ezi SHIELD CAN
 DRAWING NUMBER:
SO1-XXXXXXXXXO