

IEC Appliance Inlet C14 with Fuseholder 1- or 2-pole



Screw-on mounting
with fuseholder 1- or 2-pole
Sandwich/rear-side



Snap-in version
with fuseholder 1- or 2-pole
Sandwich/rear-side



Metal snaps Version, Detail view
IEC connector C14 with fuse holder 1- or 2-pole
Sandwich/rear-side



See below:
[Approvals and Compliances](#)

Description

- Panel mount :
Sandwich/rear-side
- 2 Functions :
Appliance Inlet Protection class I , with or without Fuseholder for fuse-links 5 x 20 mm on the rear-side 1- or 2-pole
- Meets the requirements of IEC 60335-1 for appliances in unattended use. This includes the enhanced requirements of glow wire tests acc. to IEC 60695-2-11 or -12 &-13.
- For PCB mounting
- Pick and place version

Characteristics

- PCB mount with snap-in or screw-on feet
Suitable for automatic PCB assembling
- All single elements are already wired
- Fuseholder on the inside of the equipment prevents accidental use of incorrect fuse-links by the user
- Blister tray as optional packaging variant
- Suitable for use in equipment according to IEC/UL 62368-1

Other versions on request

- Ground terminal with quick-connect terminal 6,3 x 0,8 mm
- Ground terminal with solder terminal
- For protection class II

References

Weblinks

[pdf data sheet](#), [html datasheet](#), [General Product Information](#), [Approvals](#), [Distributor-Stock-Check](#), [Accessories](#), [Detailed request for product](#)

Newly available variants corresponding to V-Lock mating cordset. The connector is equipped with a notch intended for use with the latching cordset. The cord latching system prevents against accidental removal of the cordset.

Technical Data

| | | | |
|-----------------------------------|---|-----------------------------------|--|
| Ratings IEC | 10A / 250VAC; 50Hz | Appliance inlet/-outlet | C14 acc. to IEC 60320-1, UL 498, CSA C22.2 no. 42 (for cold conditions) pin-temperature 70 °C, 10A, Protection Class I |
| Ratings UL/CSA | 10A / 250VAC; 60Hz without fuseholder 16A (UL) | Fuseholder | 1-/2-pole, Shocksafe category PC2 acc. to IEC 60127-6, for fuse-links 5 x 20mm |
| Dielectric Strength | > 3kVAC between L-N > 4kVAC between L/N-PE (1 min/50Hz) | Rated Power Acceptance @ Ta 23 °C | 5 x 20: 3.15W (1 pole)/ 2.5W (2-pole) per pole |
| Allowable Operation Temperature | -25 °C to 70 °C | Power Acceptance @ Ta > 23°C | Admissible power acceptance at higher ambient temperature see derating curves |
| IP-Protection | front side IP40 acc. to IEC 60529 | | |
| Protection against electric shock | Suitable for appliances with protection class I acc. to IEC 61140 | | |
| Terminal | For PCB mounting | | |
| Panel Thickness S | Screw: max 6 mm Mounting screw torque max 0.3Nm Snap-in: 1.5/2/2.5/3 mm | | |
| Material: Housing | Thermoplastic, black, UL 94V-0 | | |

Approvals and Compliances



Detailed information on product approvals, code requirements, usage instructions and detailed test conditions can be looked up in [Details about Approvals](#)

SCHURTER products are designed for use in industrial environments. They have approvals from independent testing bodies according to national and international standards. Products with specific characteristics and requirements such as required in the automotive sector according to IATF 16949, medical technology according to ISO 13485 or in the aerospace industry can be offered exclusively with customer-specific, individual agreements by SCHURTER.

Approvals





The approval mark is used by the testing authorities to certify compliance with the safety requirements placed on electronic products.

Approval Reference Type: GSF1

| Approval Logo | Certificates | Certification Body | Description |
|--|-------------------------------|--------------------|--|
|  | VDE Approvals | VDE | Certificate Number: 40024857 |
|  | UL Approvals | UL | UR File Number: E93617, E96454 |
|  | CCC Approvals | CCC | CCC Certificate Number: 2020180204013041 |



Product standards

Product standards that are referenced

| Organization | Design | Standard | Description |
|--|-----------------------|------------------|---|
|  | Designed according to | IEC 60320-1 | Appliance couplers for household and similar general purposes |
|  | Designed according to | IEC 60127-6 | Miniature fuses. Part 6. Fuse-holders for miniature fuse-links |
|  | Designed according to | IEC 61058-1 | Switches for appliances. Part 1. General requirements |
|  | Designed according to | UL 498 | Standard for Attachment Plugs and Receptacles |
|  | Designed according to | CSA C22.2 no. 42 | General Use Receptacles, Attachment Plugs, and Similar Wiring Devices |







Application standards

Application standards where the product can be used

| Organization | Design | Standard | Description |
|--|--------------------------------|----------------|--|
|  | Suitable for applications acc. | IEC/UL 62368-1 | Audio/video, information and communication technology equipment - Part 1: Safety requirements |
|  | Suitable for applications acc. | IEC 60335-1 | Safety of electrical appliances for household and similar purposes. Meets the requirements for appliances in unattended use. This includes the enhanced requirements of glow wire tests acc. to IEC 60695-2-11 or -12 & -13. |

Compliances

The product complies with following Guide Lines

| Identification | Details | Initiator | Description |
|--|--|-------------|--|
|  | CE declaration of conformity | SCHURTER AG | The CE marking declares that the product complies with the applicable requirements laid down in the harmonisation of Community legislation on its affixing in accordance with EU Regulation 765/2008. |
|  | UKCA declaration of conformity | SCHURTER AG | The UKCA marking declares that the product complies with the applicable requirements laid down in the British Amendment of Regulation (EC) 765/2008. |
|  | RoHS | SCHURTER AG | Directive RoHS 2011/65/EU, Amendment (EU) 2015/863 |
|  | China RoHS | SCHURTER AG | The law SJ / T 11363-2006 (China RoHS) has been in force since 1 March 2007. It is similar to the EU directive RoHS. |
|  | REACH | SCHURTER AG | On 1 June 2007, Regulation (EC) No 1907/2006 on the Registration, Evaluation, Authorization and Restriction of Chemicals 1 (abbreviated as "REACH") entered into force. |
|  | | SCHURTER AG | V-Lock system are based on a matching plug-dose combination. The connector is equipped with a notch intended for use with the latching cordset. The cord latching system prevents against accidental removal of the cordset. |
|  | White Paper Glow wire test | SCHURTER AG | Meets the requirements of IEC 60335-1 for appliances in unattended use. This includes the enhanced requirements of glow wire tests acc. to IEC 60695-2-11 or -12 & -13. |

Dimensions [mm]

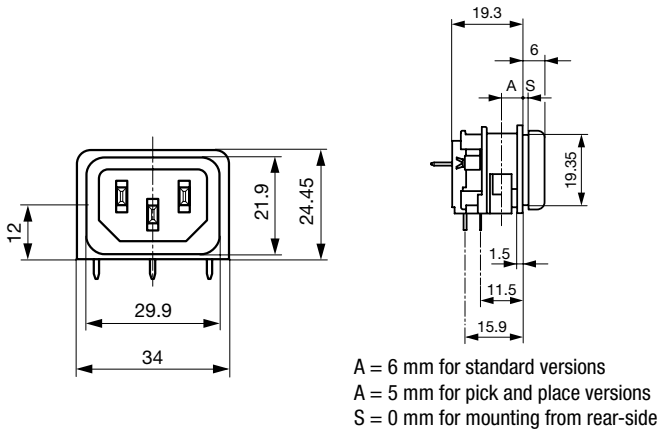

with insulation cover on rear side for version without fuseholder

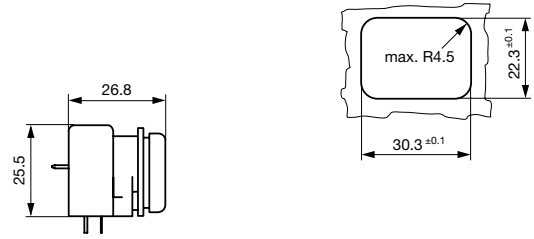

for mounting from rear-side

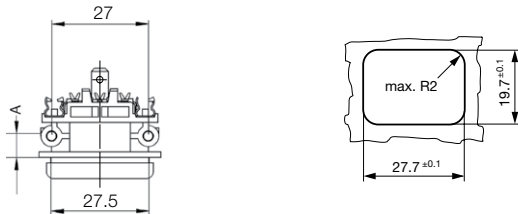

A = 6 mm for standard versions
 A = 5 mm for pick and place versions

for sandwich mounting

Drilling diagrams

without fuseholder

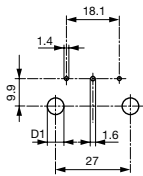

D1 for snap-in mounting = 6 ± 0.05
 D1 for self-tapping screw = 3.6 ± 0.1

with 1-pole fuseholder

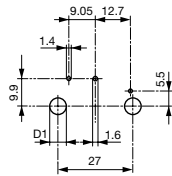

D1 for snap-in mounting = 6 ± 0.05
 D1 for self-tapping screw = 3.6 ± 0.1

with 2-pole fuseholder

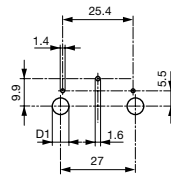

D1 for snap-in mounting = 6 ± 0.05
 D1 for self-tapping screw = 3.6 ± 0.1

Pick and Place versions without / with 1-pole or 2-pole fuseholder

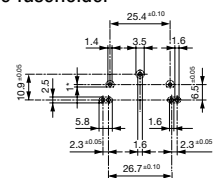

1* only for protection class II

Derating Curves

1-pole

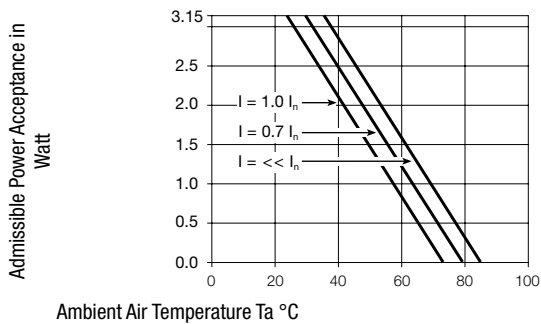

2-pole

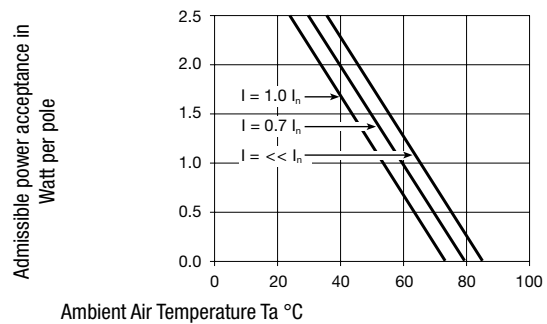

All Variants

| Mounting side | Panel mounting | Panel Thickness s [mm] | Fuseholder | Ground terminal 4.8 x 0.8 mm | Ground terminal direction | Packaging | V-Lock | Order Number |
|---------------|----------------|---------------------------|------------|---------------------------------|---------------------------|--------------|--------|--------------|
| Sandwich | Snap-in | 1.5 | - | ● | in line with PIN-axis | - | | GSF1.0201.31 |
| Sandwich | Snap-in | 2 | - | ● | in line with PIN-axis | - | | GSF1.0201.41 |
| Sandwich | Snap-in | 2.5 | - | ● | in line with PIN-axis | - | | GSF1.0201.51 |
| Sandwich | Snap-in | 3 | - | ● | in line with PIN-axis | - | | GSF1.0201.61 |
| Sandwich | Snap-in | 1.5 | - | ● | angled to pin axis | - | | GSF1.0202.31 |
| Sandwich | Snap-in | 2 | - | ● | angled to pin axis | - | | GSF1.0202.41 |
| Sandwich | Snap-in | 2.5 | - | ● | angled to pin axis | - | | GSF1.0202.51 |
| Sandwich | Snap-in | 3 | - | ● | angled to pin axis | - | | GSF1.0202.61 |
| Sandwich | Snap-in | 1.5 | 1-pole | ● | in line with PIN-axis | - | | GSF1.1201.31 |
| Sandwich | Snap-in | 2 | 1-pole | ● | in line with PIN-axis | - | | GSF1.1201.41 |
| Sandwich | Snap-in | 2.5 | 1-pole | ● | in line with PIN-axis | - | | GSF1.1201.51 |
| Sandwich | Snap-in | 3 | 1-pole | ● | in line with PIN-axis | - | | GSF1.1201.61 |
| Sandwich | Snap-in | 1.5 | 1-pole | ● | angled to pin axis | - | | GSF1.1202.31 |
| Sandwich | Snap-in | 2 | 1-pole | ● | angled to pin axis | - | | GSF1.1202.41 |
| Sandwich | Snap-in | 2.5 | 1-pole | ● | angled to pin axis | - | | GSF1.1202.51 |
| Sandwich | Snap-in | 3 | 1-pole | ● | angled to pin axis | - | | GSF1.1202.61 |
| Sandwich | Snap-in | 1.5 | 2-pole | ● | in line with PIN-axis | - | | GSF1.2201.31 |
| Sandwich | Snap-in | 2 | 2-pole | ● | in line with PIN-axis | - | | GSF1.2201.41 |
| Sandwich | Snap-in | 2.5 | 2-pole | ● | in line with PIN-axis | - | | GSF1.2201.51 |
| Sandwich | Snap-in | 3 | 2-pole | ● | in line with PIN-axis | - | | GSF1.2201.61 |
| Sandwich | Snap-in | 1.5 | 2-pole | ● | angled to pin axis | - | | GSF1.2202.31 |
| Sandwich | Snap-in | 2 | 2-pole | ● | angled to pin axis | - | | GSF1.2202.41 |
| Sandwich | Snap-in | 2.5 | 2-pole | ● | angled to pin axis | - | | GSF1.2202.51 |
| Sandwich | Screw | 1.5 | - | ● | in line with PIN-axis | - | | GSF1.0001.31 |
| Sandwich | Screw | 2 | - | ● | in line with PIN-axis | - | | GSF1.0001.41 |
| Sandwich | Screw | 2.5 | - | ● | in line with PIN-axis | - | | GSF1.0001.51 |
| Sandwich | Screw | 3 | - | ● | in line with PIN-axis | - | | GSF1.0001.61 |
| Sandwich | Screw | 1.5 | - | ● | angled to pin axis | - | | GSF1.0002.31 |
| Sandwich | Screw | 2 | - | ● | angled to pin axis | - | | GSF1.0002.41 |
| Sandwich | Screw | 2.5 | - | ● | angled to pin axis | - | | GSF1.0002.51 |
| Sandwich | Screw | 3 | - | ● | angled to pin axis | - | | GSF1.0002.61 |
| Sandwich | Screw | 2.5 | 1-pole | ● | in line with PIN-axis | Blister tray | | 3-104-974 |
| Sandwich | Screw | 1.5 | 1-pole | ● | in line with PIN-axis | - | | GSF1.1001.31 |
| Sandwich | Screw | 2 | 1-pole | ● | in line with PIN-axis | - | | GSF1.1001.41 |
| Sandwich | Screw | 2.5 | 1-pole | ● | in line with PIN-axis | - | | GSF1.1001.51 |
| Sandwich | Screw | 3 | 1-pole | ● | in line with PIN-axis | - | | GSF1.1001.61 |
| Sandwich | Screw | 1.5 | 1-pole | ● | angled to pin axis | - | | GSF1.1002.31 |
| Sandwich | Screw | 2 | 1-pole | ● | angled to pin axis | - | | GSF1.1002.41 |
| Sandwich | Screw | 2.5 | 1-pole | ● | angled to pin axis | - | | GSF1.1002.51 |
| Sandwich | Screw | 3 | 1-pole | ● | angled to pin axis | - | | GSF1.1002.61 |
| Sandwich | Screw | 2.5 | 1-pole | ● | in line with PIN-axis | - | | GSF1.1006.51 |
| Sandwich | Screw | 1.5 | 2-pole | ● | in line with PIN-axis | - | | GSF1.2001.31 |
| Sandwich | Screw | 2 | 2-pole | ● | in line with PIN-axis | - | | GSF1.2001.41 |
| Sandwich | Screw | 2.5 | 2-pole | ● | in line with PIN-axis | - | | GSF1.2001.51 |
| Sandwich | Screw | 3 | 2-pole | ● | in line with PIN-axis | - | | GSF1.2001.61 |
| Sandwich | Screw | 1.5 | 2-pole | ● | angled to pin axis | - | | GSF1.2002.31 |

| Mounting side | Panel mounting | Panel Thickness s [mm] | Fuseholder | Ground terminal 4.8 x 0.8 mm | Ground terminal direction | Packaging | V-Lock | Order Number |
|---------------|----------------|------------------------|------------|------------------------------|---------------------------|--------------|--------|--------------|
| Sandwich | Screw | 2 | 2-pole | ● | angled to pin axis | - | | GSF1.2002.41 |
| Sandwich | Screw | 2.5 | 2-pole | ● | angled to pin axis | - | | GSF1.2002.51 |
| Sandwich | Screw | 3 | 2-pole | ● | angled to pin axis | - | | GSF1.2002.61 |
| Rear Side | Snap-in | 6 | - | ● | in line with PIN-axis | - | | GSF1.0201.01 |
| Rear Side | Snap-in | 6 | - | ● | angled to pin axis | - | | GSF1.0202.01 |
| Rear Side | Snap-in | 6 | 1-pole | ● | in line with PIN-axis | - | | GSF1.1201.01 |
| Rear Side | Snap-in | 6 | 1-pole | ● | angled to pin axis | - | | GSF1.1202.01 |
| Rear Side | Snap-in | 6 | 2-pole | ● | in line with PIN-axis | - | | GSF1.2201.01 |
| Rear Side | Snap-in | 6 | 2-pole | ● | angled to pin axis | - | | GSF1.2202.01 |
| Rear Side | Screw | 6 | - | ● | in line with PIN-axis | - | | GSF1.0001.01 |
| Rear Side | Screw | 6 | - | ● | angled to pin axis | - | | GSF1.0002.01 |
| Rear Side | Screw | 6 | 1-pole | ● | in line with PIN-axis | - | | GSF1.1001.01 |
| Rear Side | Screw | 6 | 1-pole | ● | angled to pin axis | - | | GSF1.1002.01 |
| Rear Side | Screw | 6 | 2-pole | ● | in line with PIN-axis | - | | GSF1.2001.01 |
| Rear Side | Screw | 6 | 2-pole | ● | angled to pin axis | - | | GSF1.2002.01 |
| Rear Side | Metal snaps | 6 | - | ● | angled to pin axis | Blister tray | | GSF1.3402.01 |
| Rear Side | Metal snaps | 6 | 1-pole | ● | angled to pin axis | Blister tray | | GSF1.4402.01 |
| Rear Side | Metal snaps | 6 | 2-pole | ● | angled to pin axis | Blister tray | | GSF1.5402.01 |

Most Popular.

Availability for all products can be searched real-time: <https://www.schurter.com/en/info-center/support-tools/stock-check-distributors>

Optional blister tray packaging 250 Pcs

Packaging unit 50 Pcs

Mating Outlets/Connectors

Category / Description

Appliance Outlet Overview complete



| | |
|--|------|
| 4787, Mounting: Screw-on mounting, Appliance Outlet: IEC Solder terminals, 10 A, Suitable for appliances with protection class I | 4787 |
| 4788, Mounting: Snap-in version, Appliance Outlet: IEC Solder / Quick Connect, 10 A, Suitable for appliances with protection class I | 4788 |
| IEC Appliance Outlet F or H, Screw-on Mounting, Front Side, Solder, PCB or Quick-connect Terminal | 5091 |

Connector Overview complete



| | |
|---|---------|
| 4782 Mounting: Power Cord, 3 x 1 mm ² / 3 x 18 AWG, Cable, Connector: IEC C13 | 4782 |
| 4785 Mounting: Power Cord, 3 x 1 mm ² / 3 x 18 AWG, Cable, Connector: IEC C13 | 4785 |
| 4300-06 Mounting: Power Cord, 3 x 1 mm ² / 3 x 18 AWG, Cable, Connector: IEC C13 | 4300-06 |
| 4781 Mounting: Power Cord, Cable, Connector: IEC C15 | 4781 |
| 4784 Mounting: Power Cord, 3 x 1 mm ² / 3 x 18 AWG, Cable, Connector: IEC C15 | 4784 |

Mating Outlets/Connectors shuttered



[Connector Overview complete](#)

| | |
|--|------|
| 4783 Mounting: Power Cord, 3 x 1 mm ² / 3 x 18 AWG, Cable, Connector: IEC C13 | 4783 |
|--|------|



[Power Cord Overview complete](#)

| | |
|---|---------|
| VAC13KS, Overview, V-Lock cord retaining, diverse Connector IEC C13, diverse, black | VAC13KS |
| VAC17KS, V-Lock cord retaining, diverse m, Connector IEC C17, diverse, black / grey / white | VAC17KS |