



679 SERIES

9mm High Intensity Panel Mount Indicators

MECHANICAL / SPECIFICATIONS

MOUNTING HOLE SIZE:
0.374" (9.5 mm)

MAX PANEL THICKNESS:
0.374" (9.5 mm);

WITH GASKET:
0.318" (8.0 mm)

MOUNTING TORQUE:
0.362 lbs/ft (5 kg/cm)

VOLTAGE OPTIONS:
6, 12 & 24 V DC (no resistor required)

OPERATING TEMP:
-20 °C to +75 °C (-4 °F to +167 °F)

STORAGE TEMP:
-40 °C to +100 °C (-40 °F to +212 °F)

ELECTRICAL CONNECTION:
Solder terminals, 6" wire leads

HOUSING:

Brass-Chrome or Black Plated

TERMINALS:

Copper-Nickel Plated

LOCK WASHER:

Iron-Nickel Plated

NUT:

Brass-Nickel Plated

CERTIFICATIONS & RATINGS

RoHS compliant
NEMA 4X (with gasket)
IP66 (with gasket)

APPLICATION

The 679 Series LED Panel Mount Indicators are designed for a variety of applications such as:

- Main power indication
- Remote power indication
- Status indication
- Maintenance and warning indication
- Instrumentation

DIMENSIONS inches [mm]

RECESSED Non-Polarized

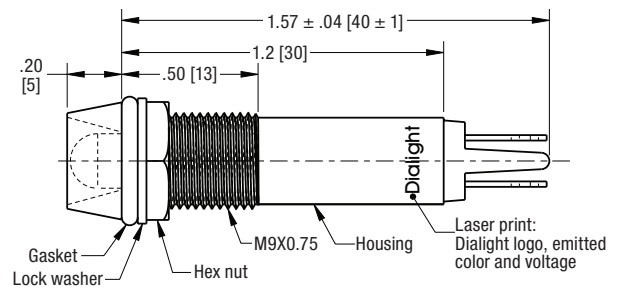
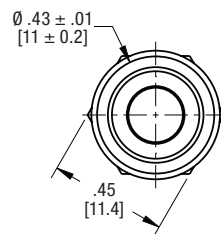

PROTRUDING Non-Polarized

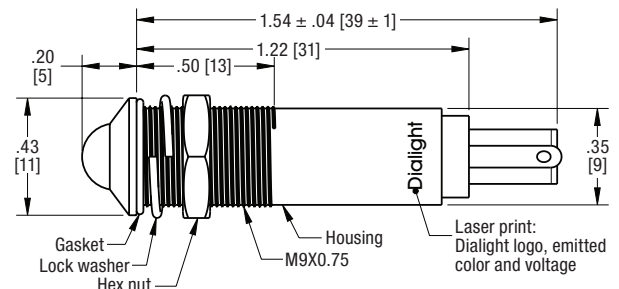
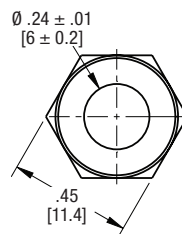

6" WIRE LEADS

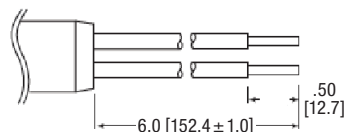

ORDERING INFORMATION

Recessed LED

Part Number / Termination		Color	Voltage (V DC)	Current (mA)	Intensity Typ. (mcd)	Plating
Solder Terminals	6" Wire Leads					
679-2112-321F	679-2115-321F	● Red	6	15	775	Chrome
679-2212-322F	679-2215-322F	● Green			5870	
679-2312-323F	679-2315-323F	● Orange			1570	
679-2412-324F	679-2415-324F	● Blue			270	
679-2112-331F	679-2115-331F	● Red	12		775	
679-2212-332F	679-2215-332F	● Green			5870	
679-2312-333F	679-2315-333F	● Orange			1570	
679-2412-334F	679-2415-334F	● Blue			270	
679-2112-341F	679-2115-341F	● Red	24		775	
679-2212-342F	679-2215-342F	● Green			5870	
679-2312-343F	679-2315-343F	● Orange			1570	
679-2412-344F	679-2415-344F	● Blue			270	
679-2122-321F	679-2125-321F	● Red	6		775	Black
679-2222-322F	679-2225-322F	● Green			5870	
679-2322-323F	679-2325-323F	● Orange			1570	
679-2422-324F	679-2425-324F	● Blue			270	
679-2122-331F	679-2125-331F	● Red	12		775	
679-2222-332F	679-2225-332F	● Green			5870	
679-2322-333F	679-2325-333F	● Orange			1570	
679-2422-334F	679-2425-334F	● Blue			270	
679-2122-341F	679-2125-341F	● Red	24		775	
679-2222-342F	679-2225-342F	● Green			5870	
679-2322-343F	679-2325-343F	● Orange			1570	
679-2422-344F	679-2425-344F	● Blue			270	

Protruding LED

Part Number / Termination		Color	Voltage (V DC)	Current (mA)	Intensity Typ. (mcd)	Plating
Solder Terminals	6" Wire Leads					
679-1112-321F	679-1115-321F	● Red	6	15	485	Chrome
679-1212-322F	679-1215-322F	● Green			5870	
679-1312-323F	679-1315-323F	● Orange			1570	
679-1412-324F	679-1415-324F	● Blue			215	
679-1112-331F	679-1115-331F	● Red	12		485	
679-1212-332F	679-1215-332F	● Green			5870	
679-1312-333F	679-1315-333F	● Orange			1570	
679-1412-334F	679-1415-334F	● Blue			215	
679-1112-341F	679-1115-341F	● Red	24		485	
679-1212-342F	679-1215-342F	● Green			5870	
679-1312-343F	679-1315-343F	● Orange			1570	
679-1412-344F	679-1415-344F	● Blue			215	
679-1122-321F	679-1125-321F	● Red	6		485	Black
679-1222-322F	679-1225-322F	● Green			5870	
679-1322-323F	679-1325-323F	● Orange			1570	
679-1422-324F	679-1425-324F	● Blue			215	
679-1122-331F	679-1125-331F	● Red	12		485	
679-1222-332F	679-1225-332F	● Green			5870	
679-1322-333F	679-1325-333F	● Orange			1570	
679-1422-334F	679-1425-334F	● Blue			215	
679-1122-341F	679-1125-341F	● Red	24		485	
679-1222-342F	679-1225-342F	● Green			5870	
679-1322-343F	679-1325-343F	● Orange			1570	
679-1422-344F	679-1425-344F	● Blue			215	



Dialight reserves the right to make changes at any time in order to supply the best product possible. The most current version of this document will always be available at: www.dialightsignalsandcomponents.com

Warranty Statement: Except for the warranty expressly provided for at: www.dialight.com/resources/warranties/, Dialight disclaims any and all other warranties, express or implied, including, without limitation, any warranties of merchantability, fitness for a particular purpose, title, and noninfringement.