

USEQFSEA50L180

Aliases (USEQFSEA50L180)

KEMET, QFS, Flame Detection, SMD, Infrared, Small SMD Package, 12C
Communication Compatible

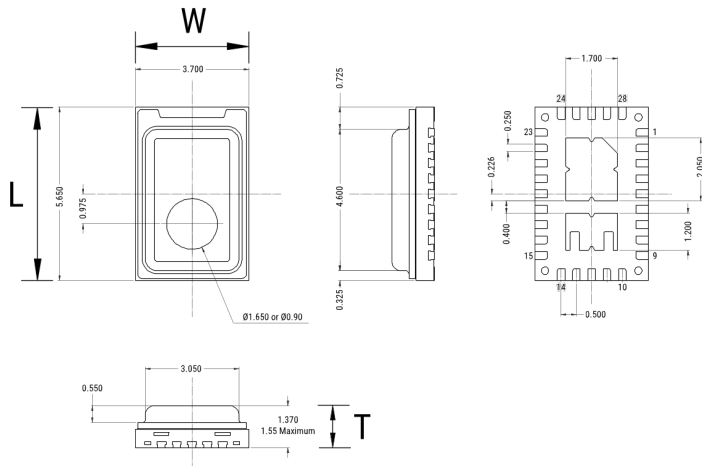

Click [here](#) for the 3D model.

Dimensions	
L	5.65mm NOM
W	3.7mm NOM
T	1.55mm MAX

Packaging Specifications	
Packaging	T&R, 178mm
Packaging Quantity	800
Typical Component Weight	70 mg

General Information	
Series	QFS
Type	Flame Detection
Style	SMD
Description	12C
Features	Small SMD Package, 12C Communication Compatible
RoHS	With Exemptions
REACH	SVHC (PZT – CAS 12626-81-2)
SCIP Number	f8c5f819-a3bd-41c4-887e-bd5dcb8c5edf
Qualifications	REACH
MSL	3

Specifications	
Temperature Range	-40/+85°C
Power Supply Voltage	1.75 - 3.6 V
Current	1 - 23 uA (Supply Current, Typical)
Miscellaneous	Human motion rejection. Sensor Type: Single.
D*	2.5 x 10^8 cm sqrt(Hz)/ W
NEP	2.7 x 10^-10 W/sqrt(Hz)
Time Constant	10ms (10-20 Hz peak)
Field of View	90 degrees
Element Size	0.64mm x 0.64mm
Filter Aperture	d = 1.65 mm
Filter	5 um long pass (human motion rejection)

Statements of suitability for certain applications are based on our knowledge of typical operating conditions for such applications, but are not intended to constitute - and we specifically disclaim - any warranty concerning suitability for a specific customer application or use. This Information is intended for use only by customers who have the requisite experience and capability to determine the correct products for their application. Any technical advice inferred from this Information or otherwise provided by us with reference to the use of our products is given gratis, and we assume no obligation or liability for the advice given or results obtained.