

- 1
- 2
- 3
- 4
- 5
- 6
- 7
- 8
- 9
- 10
- 11
- 12
- 13
- 14
- 15
- 16
- 17
- 18
- 19

**STANDARD EXECUTIONS**

- **RML-US-AN:** (AlNiCo) Aluminium-nickel-cobalt magnet, resistant to temperatures up to 450°C.
  - **RML-US-ND:** (NdFeB) Neodymium-iron-boron magnet, resistant to temperatures up to 80°C.
- Retaining magnets technical data (on page 1052).

**FEATURES AND APPLICATIONS**

RML-US retaining magnets are unshielded cylindric magnets. They are mostly attached by gluing. When used without air gap, RML-US unshielded magnets have lower adhesive forces than the magnet systems RML (see page ) in which magnetic shielding increases enormously the intensity of the adhesive force acting on the surface.



Conversion Table			
1 mm = 0.039 inch			
D		D	
mm	inch	mm	inch
2	0.08	10	0.39
3	0.12	12	0.47
4	0.16	15	0.59
5	0.20	20	0.78
6	0.23	34	1.33
8	0.31		

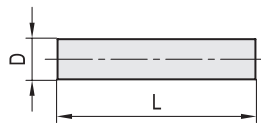

METRIC

**RML-US-AN**

Code	Description	D+0 -0.2	L±0.1	Nominal adhesive forces* [N]	⚖️
502041	RML-US-AN-3-10	3	10	1.1	2
502043	RML-US-AN-3-12	3	12	1.3	2
502045	RML-US-AN-4-16	4	16	1.9	3
502047	RML-US-AN-4-20	4	20	2	3
502049	RML-US-AN-5-20	5	20	2.3	37
502051	RML-US-AN-6-15	6	15	2.8	4
502053	RML-US-AN-6-24	6	24	2.8	5
502055	RML-US-AN-6-30	6	30	2.8	7
502057	RML-US-AN-8-25	8	25	3.8	9
502059	RML-US-AN-8-32	8	32	3.8	12
502061	RML-US-AN-10-20	10	20	5	12
502063	RML-US-AN-10-40	10	40	7	27
502065	RML-US-AN-12-40	12	40	8	37
502067	RML-US-AN-12-48	12	48	8	43
502069	RML-US-AN-15-30	15	30	10	43
502071	RML-US-AN-15-60	15	60	11	87
502073	RML-US-AN-20-40	20	40	17	92
502075	RML-US-AN-34-80	34	80	61	555

**RML-US-ND**

Code	Description	D±0.1	L±0.1	Nominal adhesive forces* [N]	⚖️
502081	RML-US-ND-2-4	2	4	1.6	0.1
502082	RML-US-ND-2-8	2	8	1.7	0.2
502083	RML-US-ND-3-6	3	6	3.6	0.3
502084	RML-US-ND-4-5	4	5	6	0.5
502085	RML-US-ND-4-10	4	10	6.9	0.9
502086	RML-US-ND-4-15	4	15	7	1.4
502087	RML-US-ND-4-20	4	20	7.1	1.9
502088	RML-US-ND-5-10	5	10	10	1.5
502089	RML-US-ND-5-15	5	15	11	2
502090	RML-US-ND-5-20	5	20	11	3
502091	RML-US-ND-6-10	6	10	14	2
502092	RML-US-ND-6-15	6	15	14	3
502093	RML-US-ND-6-25	6	25	15	5
502094	RML-US-ND-8-10	8	10	26	3.8
502095	RML-US-ND-8-20	8	20	27	7.5
502096	RML-US-ND-8-30	8	30	28	11
502097	RML-US-ND-10-20	10	20	44	12
502098	RML-US-ND-10-30	10	30	45	18
502099	RML-US-ND-10-40	10	40	46	24

\* The values of the nominal adhesive forces are approximate and refer to magnetic properties of laboratory samples.