

TELEPHONE LINE PROTECTOR, 500 A 8/20 MS MAX DISCHARGE CURRENT (IMAX), PER MODE

CATALOG NUMBER

SLP1RJ11



CERTIFICATIONS



FEATURES

- RJ11 sockets provide simple plug-in connection for 4 or 6 position RJ plugs
- Includes patch cord and adhesive mounting strips
- Provides both L-L and L-PE protection modes for comprehensive protection
- Automatic over-current protection

PRODUCT ATTRIBUTES

- Max Continuous Operating Voltage (Uc): 280 V
- Max Discharge Current (Imax), Per Mode: 500 kA 8/20 μ s
- Voltage Protection Level (Up), T-R: 110 V
- Voltage Protection Level (Up), T/R-G: 500 V @ 125 A
- Rated Load Current (IL): 160 mA
- Connection Type: RJ11
- Ground Lead Length: 6"
- Lead Size imperial: #18
- Temperature: -40 to 149 °F
- Depth (D): 1.1"
- Height (H): 1 1/2"

Width (W): 3.06"
Unit Weight: 0.11 lb
Certification Details: UL® 497A

DIAGRAMS

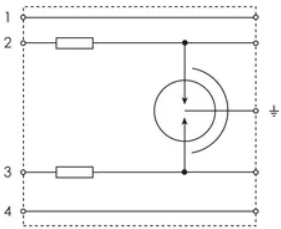

WARNING

nVent products shall be installed and used only as indicated in nVent's product instruction sheets and training materials. Instruction sheets are available at www.nvent.com and from your nVent customer service representative. Improper installation, misuse, misapplication or other failure to completely follow nVent's instructions and warnings may cause product malfunction, property damage, serious bodily injury and death and/or void your warranty.

North America
+1.800.753.9221
Option 1 – Customer Care
Option 2 – Technical Support

Europe
Netherlands:
+31 800-0200135
France:
+33 800 901 793

Europe
Germany:
800 1890272
Other Countries:
+31 13 5835404

APAC
Shanghai:
+ 86 21 2412 1618/19
Sydney:
+61 2 9751 8500