

PLD M 260 W-40/80 715/D40 - LED machine light



2702942

<https://www.phoenixcontact.com/us/products/2702942>

Please be informed that the data shown in this PDF document is generated from our online catalog. Please find the complete data in the user documentation. Our general terms of use for downloads are valid.



LED machine light, 24 V DC, emission angle (vertical/Horizontal): 40 °/80 °, length: 715 mm, diameter: 40 mm, degree of protection: IP67, can be swiveled, resistant to coolants and lubricants

Product description

This LED machine light is designed to provide illumination inside or on machinery. You can use the light in harsh environments. This is possible thanks to the following properties: - High type of protection - Resistance to common cooling agents and lubricants - Resistance to vibrations and shock - 4 mm-thick safety glass The small diameter of just 40 mm enables mounting even where space is at a premium. Mounting is by means of holders or brackets (neither of which are supplied as standard) in which the light can swivel and the lighting can therefore be optimally aligned.

Your advantages

- Space saving, thanks to the small diameter
- Plug-in supply line enables free choice of the cable length as well as quick and easy installation
- Focused illumination, thanks to swivel action
- IP67 protection and resistance to cooling agents and lubricants enables use in machine tools
- Can be used at high temperatures and can be subjected to strong vibrations and shocks
- Safety glass enables use even in environments with potential mechanical strain
- ETL approval permits use on the North American market
- Particularly economical thanks to energy-efficient LED technology and an LED service life of at least 60,000 h

Commercial data

Item number	2702942
Packing unit	1 pc
Minimum order quantity	1 pc
Sales key	DR08
Product key	DRL222
Catalog page	Page 505 (C-6-2019)
GTIN	4055626443959
Weight per piece (including packing)	1,300 g
Weight per piece (excluding packing)	1,000 g
Customs tariff number	94054239
Country of origin	DE

PLD M 260 W-40/80 715/D40 - LED machine light



2702942

<https://www.phoenixcontact.com/us/products/2702942>

Technical data

Notes

Order information:	The PLD M-ME MC/D40 mounting holder (Item No. 2702491) or the PLD M-ME MB/D40 mounting bracket (Item No. 2702527) is required in order to mount the light.
--------------------	--

Product properties

Product type	Machine light
Application	Machine tool
Mounting position	any
Special properties	can be swiveled with mounting accessories resistant to coolants and lubricants

Electrical properties

Supply: Module electronics

Connection method	M12 connector (A-coded)
Number of positions	4
Permissible conductor cross section	min. 0.34 mm ²
Supply voltage	24 V DC
Supply voltage range	20 V DC ... 28 V DC
Current consumption	typ. 0.9 A (at 24 V DC)
Power consumption	approx. 21.5 W (at 24 V DC)
Protective circuit	Surge protection; Varistor and suppressor diode, 36 V DC Reverse polarity protection; Polarity protection diode

Connection data

Connection method	M12 connector (A-coded)
-------------------	-------------------------

Signaling

Light properties

Source of light type	LED
Number of LEDs	57
Service life, lighting appliance	60000 h (L70)
Color temperature	5000 K
Color rendering index	80
Luminous flux	approx. 2330 lm (Net luminous flux)
Luminous efficacy	approx. 108 lm/W
Illumination	max. 1692 lx (Distance of 1 m) min. 403 lx (Distance of 1 m over 1 m ² area)
Average illumination	1001 lx (Distance of 1 m over 1 m ² area)
Emission angle	40 ° (C0-C180) 80 ° (C90-C270)

PLD M 260 W-40/80 715/D40 - LED machine light



2702942

<https://www.phoenixcontact.com/us/products/2702942>

Ordinance	Delegated Regulation (EU) 2019/2015
Energy efficiency class	C (3 light sources)
	E (1 light source)
Note	This product contains energy efficiency class C light sources.
	This product contains an energy efficiency class E light source.

Dimensions

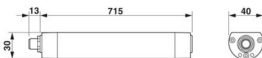
Dimensional drawing	
Width	40 mm
Height	30 mm
Length	715 mm
Diameter	40 mm
Note on dimensions	Length without M12 flush-type connector

Material specifications

Color	aluminum color
Material ()	Anodized aluminum (Light housing)
	Single-pane safety glass (ESG, thermally toughened float glass) (Pane)

Environmental and real-life conditions

Ambient conditions

Ambient temperature (operation)	0 °C ... 50 °C
Degree of protection	IP67
Air pressure (operation)	69 kPa ... 102 kPa
Air pressure (storage/transport)	69 kPa ... 102 kPa
Ambient temperature (storage/transport)	-20 °C ... 75 °C
Permissible humidity (operation)	95 % (non-condensing)
Permissible humidity (storage/transport)	95 % (non-condensing)

Standards and regulations

Protection class	III (IEC 61140, EN 61140, VDE 0140-1)
------------------	---------------------------------------

Mounting

Mounting type	Screw mounting
Assembly note	Mounting with mounting holders or mounting brackets, please observe the notes in the package slip.
Mounting position	any

PLD M 260 W-40/80 715/D40 - LED machine light

2702942

<https://www.phoenixcontact.com/us/products/2702942>



Drawings

Dimensional drawing

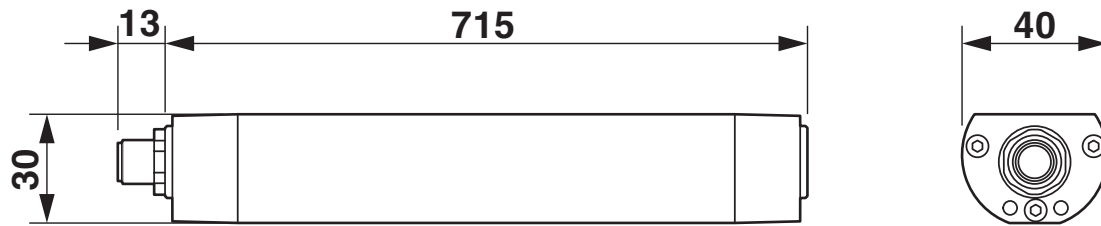

PLD M 260 W-40/80 715/D40 - LED machine light



2702942

<https://www.phoenixcontact.com/us/products/2702942>

Approvals

To download certificates, visit the product detail page: <https://www.phoenixcontact.com/us/products/2702942>



ETLus
Approval ID: LV-Lighting-Systems



cETL
Approval ID: Luminaires



EAC
Approval ID: TR_TS_D_12879-22

cETLus

PLD M 260 W-40/80 715/D40 - LED machine light



2702942

<https://www.phoenixcontact.com/us/products/2702942>

Classifications

ECLASS

ECLASS-11.0	27110345
ECLASS-12.0	27110345
ECLASS-13.0	27110345

ETIM

ETIM 9.0	EC000348
----------	----------

UNSPSC

UNSPSC 21.0	32151500
-------------	----------

Environmental product compliance

EU RoHS	
Fulfills EU RoHS substance requirements	Yes
Exemption	6(a)-I, 6(c), 7(c)-I
China RoHS	
Environment friendly use period (EFUP)	EFUP-50
	An article-related China RoHS declaration table can be found in the download area for the respective article under "Manufacturer declaration". For all articles with EFUP-E, no China RoHS declaration table issued and required.
EU REACH SVHC	
REACH candidate substance (CAS No.)	Lead(CAS: 7439-92-1)
SCIP	b33bab8c-2dda-4a8c-b32f-96bcfe714435

PLD M 260 W-40/80 715/D40 - LED machine light



2702942

<https://www.phoenixcontact.com/us/products/2702942>

Mandatory accessories

PLD M-ME MC/D40 - Mounting holder

2702492

<https://www.phoenixcontact.com/us/products/2702492>



Mounting holder, for machine lights PLD M 260 .../D40, Swiveling range $\pm 20^\circ$

PLD M-ME MB/D40 - Mounting bracket

2702527

<https://www.phoenixcontact.com/us/products/2702527>

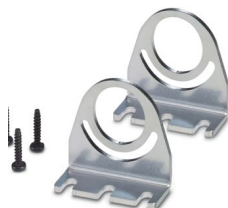

Mounting bracket, for machine lights PLD M 260 .../D40, Swiveling range $\pm 45^\circ$

Accessories

PLD M 260 W-40/80 715/D40 - LED machine light



2702942

<https://www.phoenixcontact.com/us/products/2702942>

SAC-4P- 1,5-PUR/M12FS - Sensor/actuator cable

1668108

<https://www.phoenixcontact.com/us/products/1668108>



Sensor/actuator cable, 4-position, PUR halogen-free, black-gray RAL 7021, free cable end, on Socket straight M12, coding: A, cable length: 1.5 m

SAC-4P- 3,0-PUR/M12FS - Sensor/actuator cable

1668111

<https://www.phoenixcontact.com/us/products/1668111>



Sensor/actuator cable, 4-position, PUR halogen-free, black-gray RAL 7021, free cable end, on Socket straight M12, coding: A, cable length: 3 m

PLD M 260 W-40/80 715/D40 - LED machine light



2702942

<https://www.phoenixcontact.com/us/products/2702942>

SAC-4P- 5,0-PUR/M12FS - Sensor/actuator cable

1668124

<https://www.phoenixcontact.com/us/products/1668124>



Sensor/actuator cable, 4-position, PUR halogen-free, black-gray RAL 7021, free cable end, on Socket straight M12, coding: A, cable length: 5 m

SAC-4P- 1,5-PUR/M12FR - Sensor/actuator cable

1668221

<https://www.phoenixcontact.com/us/products/1668221>



Sensor/actuator cable, 4-position, PUR halogen-free, black-gray RAL 7021, free cable end, on Socket angled M12, coding: A, cable length: 1.5 m

PLD M 260 W-40/80 715/D40 - LED machine light



2702942

<https://www.phoenixcontact.com/us/products/2702942>

SAC-4P- 3,0-PUR/M12FR - Sensor/actuator cable

1668234

<https://www.phoenixcontact.com/us/products/1668234>



Sensor/actuator cable, 4-position, PUR halogen-free, black-gray RAL 7021, free cable end, on Socket angled M12, coding: A, cable length: 3 m

SAC-4P- 5,0-PUR/M12FR - Sensor/actuator cable

1668247

<https://www.phoenixcontact.com/us/products/1668247>



Sensor/actuator cable, 4-position, PUR halogen-free, black-gray RAL 7021, free cable end, on Socket angled M12, coding: A, cable length: 5 m

Phoenix Contact 2024 © - all rights reserved
<https://www.phoenixcontact.com>

Phoenix Contact USA
586 Fulling Mill Road
Middletown, PA 17057, United States
(+717) 944-1300
info@phoenixcon.com