

THIS DRAWING IS UNPUBLISHED
VERTRAULICHE UNVERÖFFENTLICHE ZEICHNUNG

RELEASE FOR PUBLIKATION
FREI FUER VERÖFFENTLICHUNG

MATED WITH:
PASSEND ZU:

LOC DIST

REVISIONS
ÄNDERUNGEN

| | | | | | | | | | | | |
|----------------|---------------------|--|------------------|----|---|---|-----|-----------------------------|------|-----|------|
| COPYRIGHT 2000 | BY AMP INCORPORATED | ALL RIGHTS RESERVED ALLE RECHTE VORBEHALTEN | 1110948, 1110949 | AI | - | P | LTR | DESCRIPTION BESCHREIBUNG | DATE | DWN | APVD |
| | | | | | | | | | | | |

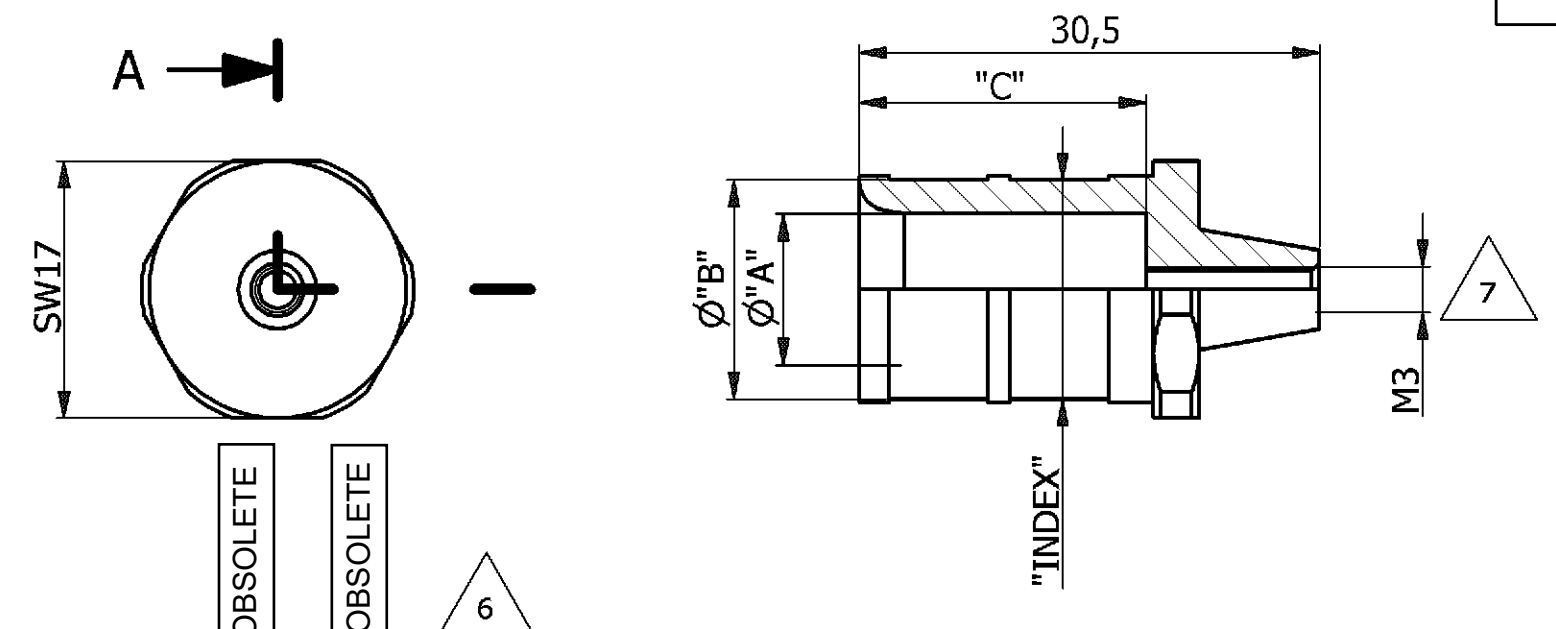

NOTES

- 1 SUITABLE CONTACTS: SERIES HF06
CUSTOMER DRAWING: 11100948, 1110949
- 2 SUITABLE CONTACTS: SERIES HF08
CUSTOMER DRAWING: 1103037, 1103038
- 3 SUITABLE CRIMPING TOOL: HYDR. TOOL 30kN
CUSTOMER DRAWING: 1105653
- 4 SUITABLE CRIMPING TOOL: HYDR. TOOLS 60kN
CUSTOMER DRAWING: 1110956
- 5 DIE SIZE "INDEX" ACC. TO DIN 48083, SEE
CUSTOMER DRAWINGS OF CRIMPING TOOLS
- 6 SHRINK. TUBE ACC. TO MIL I-23053 B/5, RATE 3:1
- 7 STANDARDS:
DIN EN 61984; DIN EN 60664-1
- 8 PACKAGING:
10 SETS IN A CARTON

OBSOLETE
OBSOLETE

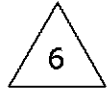

| PART NO. / QUANTITY | | | | | | | | | | | DESCRIPTION | INDEX ACC. | A | B | C | MATERIAL | SURFACE | WEIGHT [kg] | NOTE | ITEM |
|---------------------|---|---|---|---|---|---|---|---|---|---|--------------|------------|------|------|----|----------|---------------|-------------|------------------------------|------|
| 1 | 1 | 1 | 1 | 1 | 1 | 1 | 1 | 1 | 1 | 1 | SHRINK. TUBE | - | - | - | PO | BLACK | 0,004 | 18 / 45 | 14 | |
| 1 | 1 | 1 | 1 | 1 | 1 | 1 | 1 | 1 | 1 | 1 | SHRINK. TUBE | - | - | - | PO | BLACK | 0,003 | 18 / 25 | 13 | |
| 1 | 1 | 1 | 1 | 1 | 1 | 1 | 1 | 1 | 1 | 1 | SHRINK. TUBE | - | - | - | PO | BLACK | 0,002 | 12 / 25 | 12 | |
| 1 | 1 | 1 | 1 | 1 | 1 | 1 | 1 | 1 | 1 | 1 | CRIMP BARREL | 14 | 11,5 | 14,0 | 19 | COPPER | SILVER PLATED | 0,018 | WIRE SIZE 50 MM ³ | 11 |
| 1 | 1 | 1 | 1 | 1 | 1 | 1 | 1 | 1 | 1 | 1 | CRIMP BARREL | 16 | 11,8 | 16,5 | 19 | COPPER | SILVER PLATED | 0,027 | WIRE SIZE 70 MM ³ | 10 |
| 1 | 1 | 1 | 1 | 1 | 1 | 1 | 1 | 1 | 1 | 1 | CRIMP BARREL | 14 | 10,0 | 14,5 | 19 | COPPER | SILVER PLATED | 0,024 | WIRE SIZE 50 MM ³ | 9 |
| 1 | 1 | 1 | 1 | 1 | 1 | 1 | 1 | 1 | 1 | 1 | CRIMP BARREL | 14 | 9,8 | 14,5 | 19 | COPPER | SILVER PLATED | 0,025 | WIRE SIZE 48 MM ³ | 8 |
| 1 | 1 | 1 | 1 | 1 | 1 | 1 | 1 | 1 | 1 | 1 | CRIMP BARREL | 12 | 8,2 | 12,5 | 19 | COPPER | SILVER PLATED | 0,021 | WIRE SIZE 35 MM ³ | 7 |
| 1 | 1 | 1 | 1 | 1 | 1 | 1 | 1 | 1 | 1 | 1 | CRIMP BARREL | 12 | 8,5 | 12,5 | 19 | COPPER | SILVER PLATED | 0,020 | WIRE SIZE 30 MM ³ | 6 |
| 1 | 1 | 1 | 1 | 1 | 1 | 1 | 1 | 1 | 1 | 1 | CRIMP BARREL | 10 | 7,0 | 10,0 | 19 | COPPER | SILVER PLATED | 0,016 | WIRE SIZE 25 MM ³ | 5 |
| 1 | 1 | 1 | 1 | 1 | 1 | 1 | 1 | 1 | 1 | 1 | CRIMP BARREL | 8 | 5,9 | 8,5 | 19 | COPPER | SILVER PLATED | 0,014 | WIRE SIZE 18 MM ³ | 4 |
| 1 | 1 | 1 | 1 | 1 | 1 | 1 | 1 | 1 | 1 | 1 | CRIMP BARREL | 8 | 5,5 | 8,5 | 19 | COPPER | SILVER PLATED | 0,015 | WIRE SIZE 16 MM ³ | 3 |
| 1 | 1 | 1 | 1 | 1 | 1 | 1 | 1 | 1 | 1 | 1 | CRIMP BARREL | 6 | 4,5 | 6,0 | 19 | COPPER | SILVER PLATED | 0,011 | WIRE SIZE 10 MM ³ | 2 |
| 1 | 1 | 1 | 1 | 1 | 1 | 1 | 1 | 1 | 1 | 1 | CRIMP BARREL | 5 | 3,8 | 5,5 | 19 | COPPER | SILVER PLATED | 0,010 | WIRE SIZE 06 MM ³ | 1 |

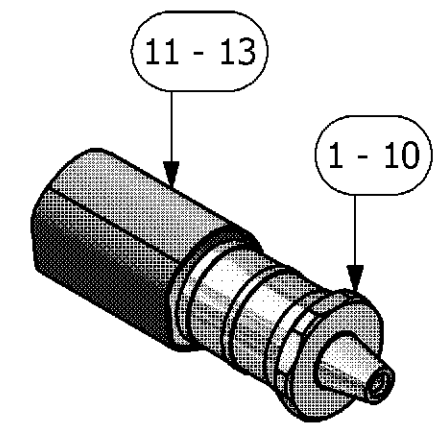

M 1:1

| 1-1 | 1-0 | 0-9 | 0-8 | 0-7 | 0-6 | 0-5 | 0-4 | 0-3 | 0-2 | 0-1 | DESCRIPTION | INDEX ACC. | A | B | C | MATERIAL | SURFACE | WEIGHT | NOTE | ITEM | |
|-----|-----|-----|-----|-----|-----|-----|-----|-----|-----|-----|---|------------|---|---|---|----------|---------|--------|------|------|--|
| | | | | | | | | | | | ORDERING TEXT: CH.6 MM ² -6MM WIRE: H07V-K 1x6MM ² | | | | | | | | | | |
| | | | | | | | | | | | ORDERING TEXT: CH.10.MM ² -6MM WIRE: H07V-K 1x10MM ² | | | | | | | | | | |
| | | | | | | | | | | | ORDERING TEXT: CH.16 MM ² -6MM WIRE: H07V-K 1x16MM ² | | | | | | | | | | |
| | | | | | | | | | | | ORDERING TEXT: CH.18.MM ² -6MM WIRE: RADOX 155, ZYRAD 555, BETATHERM 155 3x6MM ² | | | | | | | | | | |
| | | | | | | | | | | | ORDERING TEXT: CH.25 MM ² -6MM WIRE: H07V-K 1x25MM ² | | | | | | | | | | |
| | | | | | | | | | | | ORDERING TEXT: CH.30.MM ² -6MM WIRE: RADOX 155, ZYRAD 555, BETATHERM 155 3x10MM ² | | | | | | | | | | |
| | | | | | | | | | | | ORDERING TEXT: CH.35 MM ² -6MM WIRE: LAPP H07V-K, H07V-K UL STYLE 1015, CSA, TEW 1x35MM ² | | | | | | | | | | |
| | | | | | | | | | | | ORDERING TEXT: CH.48.MM ² -6MM WIRE: RADOX 155, ZYRAD 555, BETATHERM 155 3x16MM ² | | | | | | | | | | |
| | | | | | | | | | | | ORDERING TEXT: CH.50 MM ² -6MM WIRE: LAPP H07V-K, H07V-K UL STYLE 1015, CSA, TEW 1x50MM ² | | | | | | | | | | |
| | | | | | | | | | | | ORDERING TEXT: CH.70.MM ² -6MM WIRE: LAPP H07V-K, H07V-K UL STYLE 1015, CSA, TEW 1x70MM ² , 2x35MM ² | | | | | | | | | | |
| | | | | | | | | | | | ORDERING TEXT: CH.50H.MM ² -6MM WIRE: HIGH FLEX. WIRE ACC. TO DIN 46438 | | | | | | | | | | |

| | | | | |
|---|--|---|--|---|
| <p>THIS DRAWING IS A CONTROLLED DOCUMENT FOR AMP INCORPORATED. IT IS SUBJECT TO CHANGE AND THE CONTROLLING ENGINEERING ORGANIZATION SHOULD BE CONTACTED FOR THE LATEST REVISION. DIESSES ZEICHNUNGSDOKUMENT WIRD DURCH AMP INCORPORATED KONTROLLIERT. ÄNDERUNGEN, DIE DEM TECHNISCHEN FORTSCHRITT DIENEN, SIND VORBEHALTEN. DEN JEWELIGS LETZTGÜLTIGEN ÄNDERUNGSSTAND ERFAHREN SIE AUF ANFRAGE.</p> | | DWN H.BRAUN 25.10.2005 | | |
| <p>DIMENSIONS: DIMENSIONEN: mm</p> <p>TOLERANCES UNLESS OTHERWISE SPECIFIED: ALLGEMEINTOLERANZEN</p> <p>n. ISO 8015 - # n. ISO 2768 - # n. DIN 16901-#</p> <p>0 PLC # 1 PLC # 2 PLC # 3 PLC # ANGLES / WINKEL #</p> | | CHK | <p>APVD T.SCHNURPFEIL 25.10.2005</p> | |
| <p>MATERIAL</p> | | <p>FINISH / OBERFLAECH / FARBE</p> | <p>APVD T.SCHNURPFEIL 25.10.2005</p> <p>PRODUCT SPEC. PRODUKTSPEZ. 108-74024</p> <p>APPLICATION SPEC. VERARBEITUNGSSPEZ. 114-74031</p> | <p>NAME CRIMP BARREL SERIES HF06, HF08</p> |
| <p>CUSTOMER DRAWING / KUNDENZEICHNUNG</p> | | <p>WEIGHT GEWICHT SEE TABLE</p> | <p>SIZE A3</p> <p>CAGE CODE 00779</p> <p>DRAWING NO ZEICHNUNGS-NR. 1110952</p> | <p>RESTRICTED TO NUR FUER</p> <p>SCALE MASSSTAB 2:1</p> <p>SHEET BLATT 1</p> <p>OF VON 1</p> <p>REV. B4</p> |

K:\Prod_Eng\3D-Modelle\Krimp\Barn\FCL110952.dwg