

1 2 3 4 5 6 7

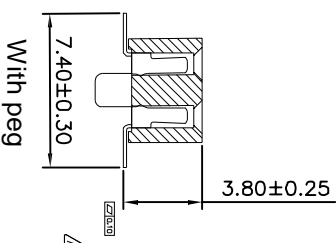
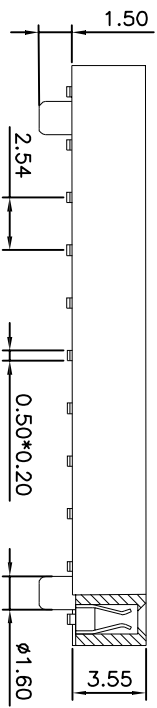
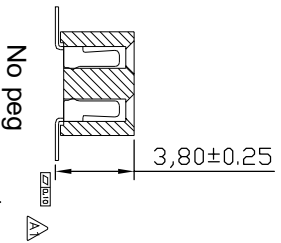
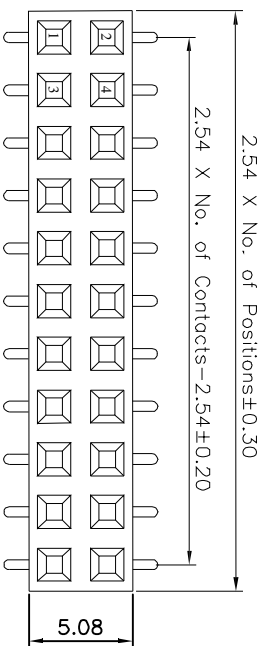

Technical Data

Material:
 Contact Material: Brass
 Contact Plating: Au over 50µ"Ni
 Insulator Material: PA6T UL94V-0

Electrical:
 Current rating: 3.0Amps/contact max.
 Contact resistance: ≤20mΩ/contact
 Insulation resistance: ≥1000MΩ at V=100V
 Withstanding Voltage: 300VAC/minute

Mechanical:
 Mechanical life Cycle :min.200
 Operating Temperature: Gold plated -55°C to +105°C
 Tin Plated: -40°C to + 105°C
 Soldering Temperature: 260°C max. 5sek

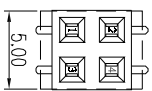
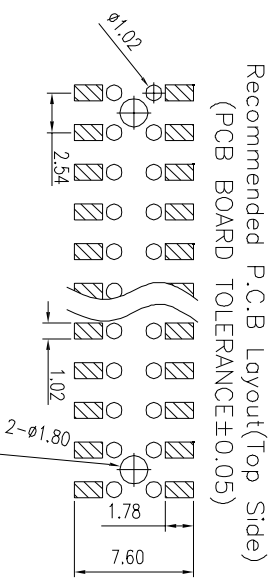

Special CAP for 2*2P-2*4P

ROHS compliant
 Unit: mm

Scale	Free	Customer-No.								
TOLERANCE										
.X	±0.40									
.XX	±0.25	Drawn 04.07.2017 Winnie								
.XXX	±0.15	Approved 04.07.2017 Winnie								
DIM	TOL	ASSMANN WSW-No. ABL-254-xx-SR4X								
Angle	±3°	Drawing-No. ASS 7666 CO rev01								
<table border="1"> <thead> <tr> <th>①</th> <th>Update</th> <th>S.Bölling</th> </tr> </thead> <tbody> <tr> <td>⑩</td> <td>Drawn</td> <td>Winnie</td> </tr> </tbody> </table>		①	Update	S.Bölling	⑩	Drawn	Winnie	Replace Sheet		
①	Update	S.Bölling								
⑩	Drawn	Winnie								
<table border="1"> <thead> <tr> <th>Id.</th> <th>Modification</th> <th>Date</th> <th>Name</th> </tr> </thead> <tbody> <tr> <td></td> <td></td> <td>23.06.2017</td> <td>Winnie</td> </tr> </tbody> </table>		Id.	Modification	Date	Name			23.06.2017	Winnie	
Id.	Modification	Date	Name							
		23.06.2017	Winnie							

1 2 3 4 5 6 7

