

# PPC 6/3 - COMBI coupling

3000694

<https://www.phoenixcontact.com/us/products/3000694>



Please be informed that the data shown in this PDF document is generated from our online catalog. Please find the complete data in the user documentation. Our general terms of use for downloads are valid.



COMBI coupling, nom. voltage: 1000 V, nominal current: 41 A, number of connections: 2, number of positions: 3, connection method: Push-in connection, 1 level, Rated cross section: 6 mm<sup>2</sup>, cross section: 0.5 mm<sup>2</sup> - 10 mm<sup>2</sup>, color: gray

## Your advantages

- For secure and space-saving accommodation of plug-in contacts in cable ducts and distributor shafts
- The Push-in technology COMBI couplings for self-assembly provide solutions that users can implement themselves
- Tested for railway applications

## Commercial data

Item number	3000694
Packing unit	25 pc
Minimum order quantity	25 pc
Sales key	BE22
Product key	BE2245
Catalog page	Page 350 (C-1-2019)
GTIN	4046356751766
Weight per piece (including packing)	25.168 g
Weight per piece (excluding packing)	17.27 g
Customs tariff number	85366990
Country of origin	PL

# PPC 6/3 - COMBI coupling

3000694

<https://www.phoenixcontact.com/us/products/3000694>



## Technical data

### Product properties

Product type	Terminal coupling
Area of application	Railway industry
	Machine building
	Plant engineering
Number of positions	3
Pitch	8.2 mm
Number of connections	2
Number of rows	1
Potentials	3

### Insulation characteristics

Overvoltage category	III
Degree of pollution	3

### Electrical properties

Rated surge voltage	8 kV
Maximum power dissipation for nominal condition	1.31 W

### Connection data

Nominal cross section	6 mm <sup>2</sup>
-----------------------	-------------------

#### 1 level

Stripping length	12 mm
Internal cylindrical gage	A5
Connection in acc. with standard	IEC 61984
Conductor cross section rigid	0.5 mm <sup>2</sup> ... 10 mm <sup>2</sup>
Cross section AWG	20 ... 8 (converted acc. to IEC)
Conductor cross section flexible	0.5 mm <sup>2</sup> ... 6 mm <sup>2</sup>
Conductor cross section, flexible [AWG]	20 ... 10 (converted acc. to IEC)
Conductor cross-section flexible (ferrule without plastic sleeve)	0.5 mm <sup>2</sup> ... 6 mm <sup>2</sup>
Flexible conductor cross section (ferrule with plastic sleeve)	0.5 mm <sup>2</sup> ... 6 mm <sup>2</sup>
Conductor cross-section flexible (2 conductors with the same cross-section, with TWIN ferrule and plastic sleeve)	0.5 mm <sup>2</sup> ... 1.5 mm <sup>2</sup>
2 conductors with the same cross section, flexible, with TWIN ferrule with plastic sleeve	0.5 mm <sup>2</sup> ... 1.5 mm <sup>2</sup>
Nominal current	41 A
Maximum load current	41 A (with 6 mm <sup>2</sup> conductor cross section)
Nominal voltage	1000 V
Nominal cross section	6 mm <sup>2</sup>

#### 1 level Connection cross sections directly pluggable

Conductor cross section rigid	1 mm <sup>2</sup> ... 10 mm <sup>2</sup>
-------------------------------	--

# PPC 6/3 - COMBI coupling

3000694

<https://www.phoenixcontact.com/us/products/3000694>



Conductor cross-section flexible (ferrule without plastic sleeve)	1 mm² ... 6 mm²
Flexible conductor cross section (ferrule with plastic sleeve)	1 mm² ... 6 mm²

## Dimensions

Width	24.6 mm
End cover width	2.2 mm
Height	47 mm
Depth	24.7 mm
Pitch	8.2 mm

## Material specifications

Color	gray
Flammability rating according to UL 94	V0
Insulating material group	I
Insulating material	PA
Static insulating material application in cold	-60 °C
Temperature index of insulation material (DIN EN 60216-1 (VDE 0304-21))	125 °C
Relative insulation material temperature index (Elec., UL 746 B)	130 °C
Fire protection for rail vehicles (DIN EN 45545-2) R22	HL 1 - HL 3
Fire protection for rail vehicles (DIN EN 45545-2) R23	HL 1 - HL 3
Fire protection for rail vehicles (DIN EN 45545-2) R24	HL 1 - HL 3
Fire protection for rail vehicles (DIN EN 45545-2) R26	HL 1 - HL 3
Calorimetric heat release NFPA 130 (ASTM E 1354)	27,5 MJ/kg
Surface flammability NFPA 130 (ASTM E 162)	passed
Specific optical density of smoke NFPA 130 (ASTM E 662)	passed
Smoke gas toxicity NFPA 130 (SMP 800C)	passed

## Mechanical properties

### Mechanical data

Open side panel	Yes
-----------------	-----

## Environmental and real-life conditions

### Ambient conditions

Ambient temperature (operation)	-60 °C (max. operating temperature see derating curve)
Ambient temperature (storage/transport)	-25 °C ... 60 °C (for a short time, no longer than 24 h, -60°C to +70°C)
Ambient temperature (assembly)	-5 °C ... 70 °C
Ambient temperature (actuation)	-5 °C ... 70 °C
Permissible humidity (operation)	20 % ... 90 %
Permissible humidity (storage/transport)	30 % ... 70 %

## Standards and regulations

Connection in acc. with standard	IEC 61984
----------------------------------	-----------

# PPC 6/3 - COMBI coupling

3000694

<https://www.phoenixcontact.com/us/products/3000694>



## Drawings

Circuit diagram



Diagram

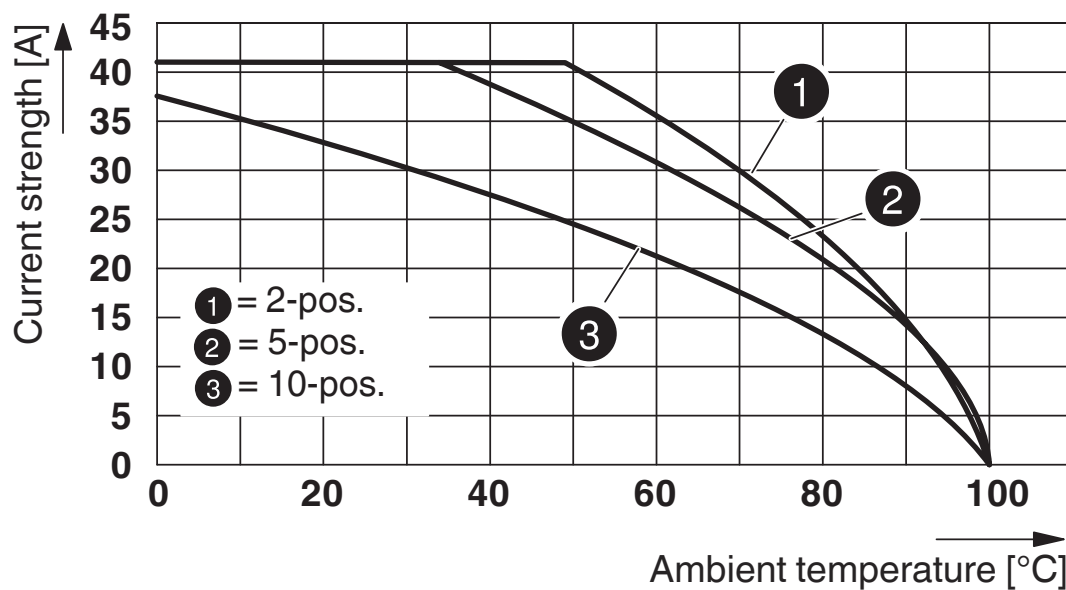

# PPC 6/3 - COMBI coupling

3000694

<https://www.phoenixcontact.com/us/products/3000694>



## Approvals

To download certificates, visit the product detail page: <https://www.phoenixcontact.com/us/products/3000694>

### DNV

Approval ID: TAE000015D



### CSA

Approval ID: 13631

	Nominal voltage $U_N$	Nominal current $I_N$	Cross section AWG	Cross section $\text{mm}^2$
Use group B				
	600 V	36 A	20 - 8	-
Use group C				
	600 V	36 A	20 - 8	-



### IECEE CB Scheme

Approval ID: DE1-64372\_B1\_B2

	Nominal voltage $U_N$	Nominal current $I_N$	Cross section AWG	Cross section $\text{mm}^2$
	1000 V	-	-	-



### EAC

Approval ID: RU C-DE.BL08.B.00511



### cULus Recognized

Approval ID: E60425



### VDE Zeichengenehmigung

Approval ID: 40043445

	Nominal voltage $U_N$	Nominal current $I_N$	Cross section AWG	Cross section $\text{mm}^2$
	1000 V	-	-	0.5 - 6



### cULus Recognized

Approval ID: E60425

# PPC 6/3 - COMBI coupling

3000694

<https://www.phoenixcontact.com/us/products/3000694>



## Classifications

### ECLASS

ECLASS-11.0	27141151
ECLASS-12.0	27141151
ECLASS-13.0	27250306

### ETIM

ETIM 9.0	EC002021
----------	----------

### UNSPSC

UNSPSC 21.0	39121400
-------------	----------

# PPC 6/3 - COMBI coupling

3000694

<https://www.phoenixcontact.com/us/products/3000694>



## Environmental product compliance

EU RoHS	
Fulfills EU RoHS substance requirements	Yes, No exemptions
China RoHS	
Environment friendly use period (EFUP)	EFUP-E
	No hazardous substances above the limits
EU REACH SVHC	
REACH candidate substance (CAS No.)	No substance above 0.1 wt%

# PPC 6/3 - COMBI coupling



3000694

<https://www.phoenixcontact.com/us/products/3000694>

## Mandatory accessories

### PP-H 6/ 1 - Plug

3061541

<https://www.phoenixcontact.com/us/products/3061541>



Plug, nom. voltage: 1000 V, nominal current: 41 A, number of connections: 1, number of positions: 1, connection method: Push-in connection, 1 level, Rated cross section: 6 mm<sup>2</sup>, cross section: 0.5 mm<sup>2</sup> - 10 mm<sup>2</sup>, color: gray

---

### PP-H 6/ 1 BU - Plug

3061554

<https://www.phoenixcontact.com/us/products/3061554>



Plug, nom. voltage: 1000 V, nominal current: 41 A, number of connections: 1, number of positions: 1, connection method: Push-in connection, 1 level, Rated cross section: 6 mm<sup>2</sup>, cross section: 0.5 mm<sup>2</sup> - 10 mm<sup>2</sup>, color: blue

## PPC 6/3 - COMBI coupling

3000694

<https://www.phoenixcontact.com/us/products/3000694>



## PP-H 6/ 1 GNYE - Plug

3061567

<https://www.phoenixcontact.com/us/products/3061567>



Plug, nom. voltage: 1000 V, nominal current: 41 A, number of connections: 1, number of positions: 1, connection method: Push-in connection, 1 level, Rated cross section: 6 mm<sup>2</sup>, cross section: 0.5 mm<sup>2</sup> - 10 mm<sup>2</sup>, color: green-yellow

---

## PP-H 6/10 - Plug

3061651

<https://www.phoenixcontact.com/us/products/3061651>



Plug, nom. voltage: 1000 V, nominal current: 41 A, number of connections: 10, number of positions: 10, connection method: Push-in connection, 1 level, Rated cross section: 6 mm<sup>2</sup>, cross section: 0.5 mm<sup>2</sup> - 10 mm<sup>2</sup>, color: gray

# PPC 6/3 - COMBI coupling

3000694

<https://www.phoenixcontact.com/us/products/3000694>



## PP-H 6/ 1-L - Plug

3061664

<https://www.phoenixcontact.com/us/products/3061664>



Plug, for self-assembly, nom. voltage: 1000 V, nominal current: 41 A, number of connections: 1, number of positions: 1, connection method: Push-in connection, 1 level, Rated cross section: 6 mm<sup>2</sup>, cross section: 0.5 mm<sup>2</sup> - 10 mm<sup>2</sup>, color: gray

---

## PP-H 6/ 1-L BU - Plug

3061677

<https://www.phoenixcontact.com/us/products/3061677>



Plug, for self-assembly, nom. voltage: 1000 V, nominal current: 41 A, number of connections: 1, number of positions: 1, connection method: Push-in connection, 1 level, Rated cross section: 6 mm<sup>2</sup>, cross section: 0.5 mm<sup>2</sup> - 10 mm<sup>2</sup>, color: blue

# PPC 6/3 - COMBI coupling

3000694

<https://www.phoenixcontact.com/us/products/3000694>



## PP-H 6/ 1-L GNYE - Plug

3061680

<https://www.phoenixcontact.com/us/products/3061680>



Plug, for self-assembly, nom. voltage: 1000 V, nominal current: 41 A, number of connections: 1, number of positions: 1, connection method: Push-in connection, 1 level, Rated cross section: 6 mm<sup>2</sup>, cross section: 0.5 mm<sup>2</sup> - 10 mm<sup>2</sup>, color: green/yellow

---

## PP-H 6/ 1-M - Plug

3061693

<https://www.phoenixcontact.com/us/products/3061693>



Plug, for self-assembly, nom. voltage: 1000 V, nominal current: 41 A, number of connections: 1, number of positions: 1, connection method: Push-in connection, 1 level, Rated cross section: 6 mm<sup>2</sup>, cross section: 0.5 mm<sup>2</sup> - 10 mm<sup>2</sup>, color: gray

# PPC 6/3 - COMBI coupling

3000694

<https://www.phoenixcontact.com/us/products/3000694>



## PP-H 6/ 1-M BU - Plug

3061703

<https://www.phoenixcontact.com/us/products/3061703>



Plug, for self-assembly, nom. voltage: 1000 V, nominal current: 41 A, number of connections: 1, number of positions: 1, connection method: Push-in connection, 1 level, Rated cross section: 6 mm<sup>2</sup>, cross section: 0.5 mm<sup>2</sup> - 10 mm<sup>2</sup>, color: blue

---

## PP-H 6/ 1-M GNYE - Plug

3061716

<https://www.phoenixcontact.com/us/products/3061716>



Plug, for self-assembly, nom. voltage: 1000 V, nominal current: 41 A, number of connections: 1, number of positions: 1, connection method: Push-in connection, 1 level, Rated cross section: 6 mm<sup>2</sup>, cross section: 0.5 mm<sup>2</sup> - 10 mm<sup>2</sup>, color: green/yellow

# PPC 6/3 - COMBI coupling

3000694

<https://www.phoenixcontact.com/us/products/3000694>



## PP-H 6/ 1-R - Plug

3061729

<https://www.phoenixcontact.com/us/products/3061729>



Plug, for self-assembly, nom. voltage: 1000 V, nominal current: 41 A, number of connections: 1, number of positions: 1, connection method: Push-in connection, 1 level, Rated cross section: 6 mm<sup>2</sup>, cross section: 0.5 mm<sup>2</sup> - 10 mm<sup>2</sup>, color: gray

---

## PP-H 6/ 1-R BU - Plug

3061732

<https://www.phoenixcontact.com/us/products/3061732>



Plug, for self-assembly, nom. voltage: 1000 V, nominal current: 41 A, number of connections: 1, number of positions: 1, connection method: Push-in connection, 1 level, Rated cross section: 6 mm<sup>2</sup>, cross section: 0.5 mm<sup>2</sup> - 10 mm<sup>2</sup>, color: blue

# PPC 6/3 - COMBI coupling

3000694

<https://www.phoenixcontact.com/us/products/3000694>



## PP-H 6/ 1-R GNYE - Plug

3061745

<https://www.phoenixcontact.com/us/products/3061745>



Plug, for self-assembly, nom. voltage: 1000 V, nominal current: 41 A, number of connections: 1, number of positions: 1, connection method: Push-in connection, 1 level, Rated cross section: 6 mm<sup>2</sup>, cross section: 0.5 mm<sup>2</sup> - 10 mm<sup>2</sup>, color: green/yellow

---

## PP-H 6/ 2 - Plug

3061570

<https://www.phoenixcontact.com/us/products/3061570>



Plug, nom. voltage: 1000 V, nominal current: 41 A, number of connections: 2, number of positions: 2, connection method: Push-in connection, 1 level, Rated cross section: 6 mm<sup>2</sup>, cross section: 0.5 mm<sup>2</sup> - 10 mm<sup>2</sup>, color: gray

# PPC 6/3 - COMBI coupling

3000694

<https://www.phoenixcontact.com/us/products/3000694>



## PP-H 6/ 3 - Plug

3061583

<https://www.phoenixcontact.com/us/products/3061583>



Plug, nom. voltage: 1000 V, nominal current: 41 A, number of connections: 3, number of positions: 3, connection method: Push-in connection, 1 level, Rated cross section: 6 mm<sup>2</sup>, cross section: 0.5 mm<sup>2</sup> - 10 mm<sup>2</sup>, color: gray

---

## PP-H 6/ 4 - Plug

3061596

<https://www.phoenixcontact.com/us/products/3061596>



Plug, nom. voltage: 1000 V, nominal current: 41 A, number of connections: 4, number of positions: 4, connection method: Push-in connection, 1 level, Rated cross section: 6 mm<sup>2</sup>, cross section: 0.5 mm<sup>2</sup> - 10 mm<sup>2</sup>, color: gray

# PPC 6/3 - COMBI coupling

3000694

<https://www.phoenixcontact.com/us/products/3000694>



## PP-H 6/ 5 - Plug

3061606

<https://www.phoenixcontact.com/us/products/3061606>



Plug, nom. voltage: 1000 V, nominal current: 41 A, number of connections: 5, number of positions: 5, connection method: Push-in connection, 1 level, Rated cross section: 6 mm<sup>2</sup>, cross section: 0.5 mm<sup>2</sup> - 10 mm<sup>2</sup>, color: gray

---

## PP-H 6/ 6 - Plug

3061619

<https://www.phoenixcontact.com/us/products/3061619>



Plug, nom. voltage: 1000 V, nominal current: 41 A, number of connections: 6, number of positions: 6, connection method: Push-in connection, 1 level, Rated cross section: 6 mm<sup>2</sup>, cross section: 0.5 mm<sup>2</sup> - 10 mm<sup>2</sup>, color: gray

# PPC 6/3 - COMBI coupling

3000694

<https://www.phoenixcontact.com/us/products/3000694>



## PP-H 6/ 7 - Plug

3061622

<https://www.phoenixcontact.com/us/products/3061622>



Plug, nom. voltage: 1000 V, nominal current: 41 A, number of connections: 7, number of positions: 7, connection method: Push-in connection, 1 level, Rated cross section: 6 mm<sup>2</sup>, cross section: 0.5 mm<sup>2</sup> - 10 mm<sup>2</sup>, color: gray

---

## PP-H 6/ 8 - Plug

3061635

<https://www.phoenixcontact.com/us/products/3061635>



Plug, nom. voltage: 1000 V, nominal current: 41 A, number of connections: 8, number of positions: 8, connection method: Push-in connection, 1 level, Rated cross section: 6 mm<sup>2</sup>, cross section: 0.5 mm<sup>2</sup> - 10 mm<sup>2</sup>, color: gray

## PPC 6/3 - COMBI coupling

3000694

<https://www.phoenixcontact.com/us/products/3000694>



### PP-H 6/ 9 - Plug

3061648

<https://www.phoenixcontact.com/us/products/3061648>



Plug, nom. voltage: 1000 V, nominal current: 41 A, number of connections: 9, number of positions: 9, connection method: Push-in connection, 1 level, Rated cross section: 6 mm<sup>2</sup>, cross section: 0.5 mm<sup>2</sup> - 10 mm<sup>2</sup>, color: gray

---

### PZ/2 - Strain relief

3040627

<https://www.phoenixcontact.com/us/products/3040627>



Strain relief, width: 9.3 mm, height: 48.7 mm, number of positions: 2, color: black

---

## Accessories

## PPC 6/3 - COMBI coupling

3000694

<https://www.phoenixcontact.com/us/products/3000694>



### D-PPC 6 - End cover

3000703

<https://www.phoenixcontact.com/us/products/3000703>

End cover, depth: 24.7 mm, width: 2.2 mm, height: 47 mm, color: gray



---

### PC - Coding star

3040588

<https://www.phoenixcontact.com/us/products/3040588>

Coding star, 4-section, depth: 6 mm, width: 3 mm, height: 3 mm, color: red



## PPC 6/3 - COMBI coupling

3000694

<https://www.phoenixcontact.com/us/products/3000694>



### ZBF 8:UNBEDRUCKT - Zack Marker strip, flat

0808781

<https://www.phoenixcontact.com/us/products/0808781>



Zack Marker strip, flat, Strip, white, unlabeled, can be labeled with: PLOTMARK, CMS-P1-PLOTTER, mounting type: snapped, for terminal block width: 8 mm, lettering field size: 5.15 x 8.15 mm, Number of individual labels: 10

---

### ZBF 8 CUS - Zack Marker strip, flat

0825030

<https://www.phoenixcontact.com/us/products/0825030>



Zack Marker strip, flat, can be ordered: Strip, white, labeled according to customer specifications, mounting type: snap into flat marker groove, for terminal block width: 8 mm, lettering field size: 5.15 x 8.15 mm, Number of individual labels: 10

## PPC 6/3 - COMBI coupling

3000694

<https://www.phoenixcontact.com/us/products/3000694>



## ZBF 8,LGS:FORTL.ZAHLEN - Zack Marker strip, flat

0808804

<https://www.phoenixcontact.com/us/products/0808804>



Zack Marker strip, flat, Strip, white, labeled, printed horizontally: consecutive numbers 1 ... 10, 11 ... 20, etc. up to 101 ... 110, mounting type: snapped, for terminal block width: 8 mm, lettering field size: 5.15 x 8.15 mm, Number of individual labels: 10

---

## UC-TMF 8 - Marker for terminal blocks

0818137

<https://www.phoenixcontact.com/us/products/0818137>



Marker for terminal blocks, Sheet, white, unlabeled, can be labeled with: BLUEMARK ID COLOR, BLUEMARK ID, BLUEMARK CLED, PLOTMARK, CMS-P1-PLOTTER, mounting type: snapped, for terminal block width: 8.2 mm, lettering field size: 7.6 x 5.1 mm, Number of individual labels: 56

## PPC 6/3 - COMBI coupling

3000694

<https://www.phoenixcontact.com/us/products/3000694>



## UC-TMF 8 CUS - Marker for terminal blocks

0824654

<https://www.phoenixcontact.com/us/products/0824654>



Marker for terminal blocks, can be ordered: by sheet, white, labeled according to customer specifications, mounting type: snap into flat marker groove, for terminal block width: 8.2 mm, lettering field size: 7.6 x 5.1 mm, Number of individual labels: 56

---

## UCT-TMF 8 - Marker for terminal blocks

0828748

<https://www.phoenixcontact.com/us/products/0828748>



Marker for terminal blocks, Sheet, white, unlabeled, can be labeled with: TOPMARK NEO, TOPMARK LASER, BLUEMARK ID COLOR, BLUEMARK ID, BLUEMARK CLED, THERMOMARK PRIME, THERMOMARK CARD 2.0, THERMOMARK CARD, mounting type: snapped, for terminal block width: 8.2 mm, lettering field size: 7.4 x 4.7 mm, Number of individual labels: 42

## PPC 6/3 - COMBI coupling

3000694

<https://www.phoenixcontact.com/us/products/3000694>



## UCT-TMF 8 CUS - Marker for terminal blocks

0829672

<https://www.phoenixcontact.com/us/products/0829672>



Marker for terminal blocks, can be ordered: by sheet, white, labeled according to customer specifications, mounting type: snap into flat marker groove, for terminal block width: 8.2 mm, lettering field size: 7.4 x 4.7 mm, Number of individual labels: 42

---

## MPS-MT - Test plug

0201744

<https://www.phoenixcontact.com/us/products/0201744>



Test plug, with solder connection up to 1 mm<sup>2</sup> conductor cross section, number of positions: 1, color: gray

## PPC 6/3 - COMBI coupling

3000694

<https://www.phoenixcontact.com/us/products/3000694>



### MPS-IH WH - Insulating sleeve

0201663

<https://www.phoenixcontact.com/us/products/0201663>

Insulating sleeve, color: white



---

### MPS-IH RD - Insulating sleeve

0201676

<https://www.phoenixcontact.com/us/products/0201676>

Insulating sleeve, color: red



## PPC 6/3 - COMBI coupling

3000694

<https://www.phoenixcontact.com/us/products/3000694>



### MPS-IH BU - Insulating sleeve

0201689

<https://www.phoenixcontact.com/us/products/0201689>

Insulating sleeve, color: blue

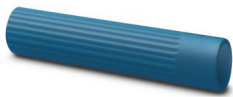

---

### MPS-IH YE - Insulating sleeve

0201692

<https://www.phoenixcontact.com/us/products/0201692>

Insulating sleeve, color: yellow



## PPC 6/3 - COMBI coupling

3000694

<https://www.phoenixcontact.com/us/products/3000694>



## MPS-IH GN - Insulating sleeve

0201702

<https://www.phoenixcontact.com/us/products/0201702>

Insulating sleeve, color: green



---

## MPS-IH GY - Insulating sleeve

0201728

<https://www.phoenixcontact.com/us/products/0201728>

Insulating sleeve, color: gray



## PPC 6/3 - COMBI coupling

3000694

<https://www.phoenixcontact.com/us/products/3000694>



## MPS-IH BK - Insulating sleeve

0201731

<https://www.phoenixcontact.com/us/products/0201731>

Insulating sleeve, color: black



---

## SZF 2-0,8X4,0 - Screwdriver

1204520

<https://www.phoenixcontact.com/us/products/1204520>

Actuation tool, for ST terminal blocks, also suitable for use as a bladed screwdriver, size: 0.8 x 4.0 x 100 mm, 2-component grip, with non-slip grip



---

Phoenix Contact 2024 © - all rights reserved  
<https://www.phoenixcontact.com>

Phoenix Contact USA  
586 Fulling Mill Road  
Middletown, PA 17057, United States  
(+717) 944-1300  
[info@phoenixcon.com](mailto:info@phoenixcon.com)