

1

2

3

4

5

6

7

A

A

Circuit 1

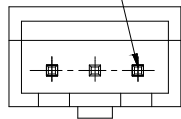

Circuit 1

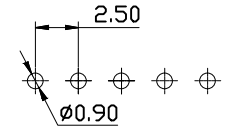
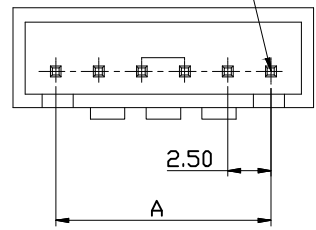

P.C.B LAYOUT

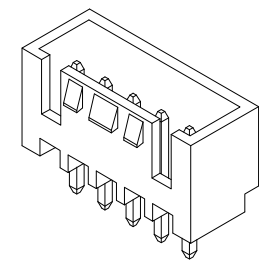

NOTE:

- 1.MATERIAL
  - 1.1 Insulator:Nylon 66,UL94V-0,White
  - 1.2 Contact:Brass,Tin over Nickel
- 2.ELECTRIC
  - 2.1 Voltage Rating:500V AC/DC
  - 2.2 Current Rating:3A AC/DC
  - 2.3 Withstanding Voltage:1000V AC/minute
  - 2.4 Insulation Resistance:500MQ Min.

- 3.Temperature Range:-40°C To +105°C
- 4.Packing:PE Bag
- Order Coder:A-WBP-L005EG-xxTB0x

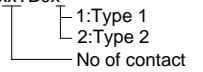

B

B

C

C

D

D

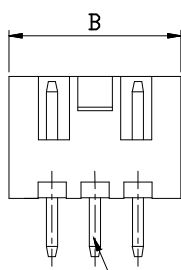

2P-5P

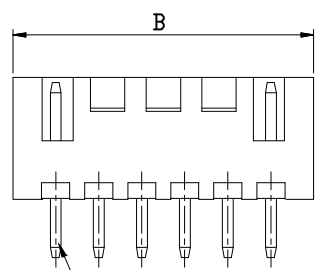

PIN 0.64 SQ

6P-15P

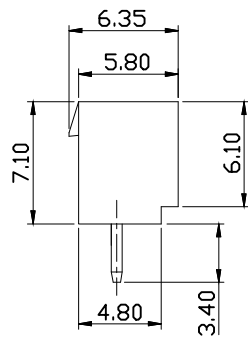

TYPE 1

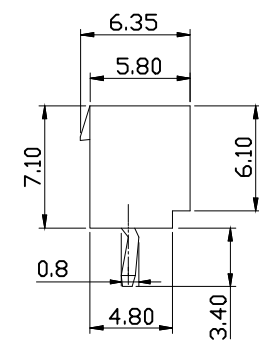

TYPE2

Poles	Part No.	Dimensions (mm)	
		A	B
02	A-WBP-L005EG-02TB0x	2.50	7.50
03	A-WBP-L005EG-03TB0x	5.00	10.00
04	A-WBP-L005EG-04TB0x	7.50	12.50
05	A-WBP-L005EG-05TB0x	10.00	15.00
06	A-WBP-L005EG-06TB0x	12.50	17.50
07	A-WBP-L005EG-07TB0x	15.00	20.00
08	A-WBP-L005EG-08TB0x	17.50	22.50
09	A-WBP-L005EG-09TB0x	20.00	25.00
10	A-WBP-L005EG-10TB0x	22.50	27.50
11	A-WBP-L005EG-11TB0x	25.00	30.00
12	A-WBP-L005EG-12TB0x	27.50	32.50
13	A-WBP-L005EG-13TB0x	30.00	35.00
14	A-WBP-L005EG-14TB0x	32.50	37.50
15	A-WBP-L005EG-15TB0x	35.00	40.00

E

E

F

F

G

G

RoHS compliant  
unit:mm



① File No.: E198287

Scale	Free
TOLERANCE	
X.	±0.35
X.X	±0.25
X.XX	±0.20
X.XXX	±0.15
DIM	TOL
Angle	TOL

①	Add UL E-No. on page 1,2	16.03.2023	Peter
②	Drawn	08.03.2022	Peter
Id.	modification	Date	Name

Date: 08.03.2022 Name: Peter  
 Drawn: 08.03.2022 Name: Peter  
 Approved: 03.16.2023 Name: Peter

Description: Wire to Board Wafer  
Pitch2.50mm 180° THT

ASSMANN WSW-NO.  
**A-WBP-L005EG-xxTB0x**

Drawing-No. ASS 9242 CO rev01  
Customer-No. SHEET 1 / 4

H

H

1

2

3

4

5

6

7

1

2

3

4

5

6

7

A

B

C

D

E

F

A

B

C

D

E

F

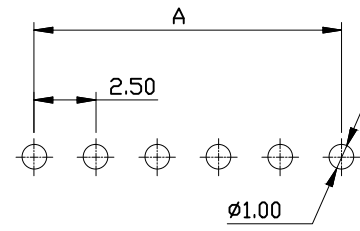
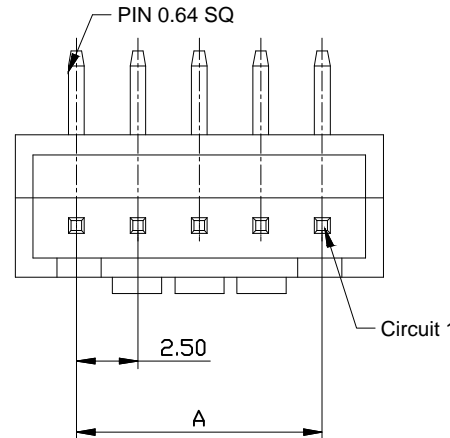
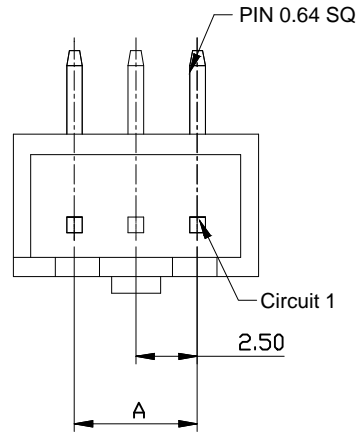

P.C.B LAYOUT

NOTE:

- 1.MATERIAL
  - 1.1 Insulator:Nylon 66,UL94V-0,White
  - 1.2 Contact:Brass,Tin over Nickel
- 2.ELECTRIC
  - 2.1 Voltage Rating:500V AC/DC
  - 2.2 Current Rating:3A AC/DC
  - 2.3 Withstanding Voltage:1000V AC/minute
  - 2.4 Insulation Resistance:500MQ Min.
- 3.Temperature Range:-40°C To +105°C
- 4.Packing:PE Bag

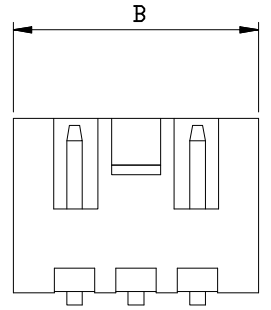
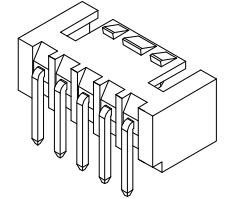

2P-4P

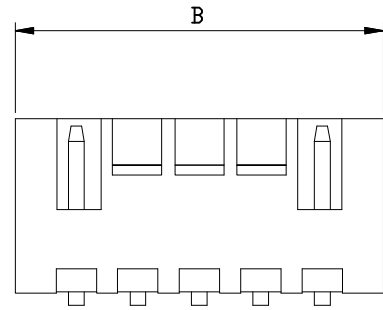

5P-15P

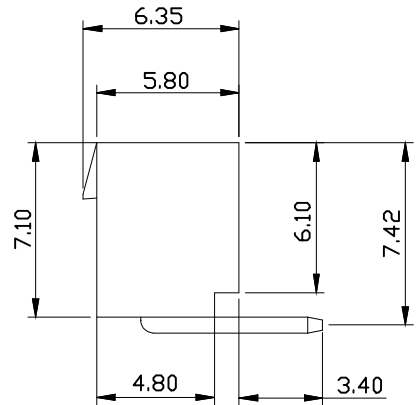

Poles	Part No.	Dimensions (mm)	
		A	B
02	A-WBP-L005EA-02TB01	2.50	7.50
03	A-WBP-L005EA-03TB01	5.00	10.00
04	A-WBP-L005EA-04TB01	7.50	12.50
05	A-WBP-L005EA-05TB01	10.00	15.00
06	A-WBP-L005EA-06TB01	12.50	17.50
07	A-WBP-L005EA-07TB01	15.00	20.00
08	A-WBP-L005EA-08TB01	17.50	22.50
09	A-WBP-L005EA-09TB01	20.00	25.00
10	A-WBP-L005EA-10TB01	22.50	27.50
11	A-WBP-L005EA-11TB01	25.00	30.00
12	A-WBP-L005EA-12TB01	27.50	32.50
13	A-WBP-L005EA-13TB01	30.00	35.00
14	A-WBP-L005EA-14TB01	32.50	37.50
15	A-WBP-L005EA-15TB01	35.00	40.00

G

H

RoHS compliant



① File No.: E198287

Scale	Free
TOLERANCE	
X.	±0.35
X.X	±0.25
X.XX	±0.20
X.XXX	±0.15
DIM	TOL
Angle	TOL

①	Add UL E-No. on page 1,2	16.03.2023	Peter
②	Drawn	08.03.2022	Peter
Id.	modification	Date	Name



Description: Wire to Board Wafer Pitch2.50mm 90° THT	
ASSMANN WSW-NO. <b>A-WBP-L005EA-xxTB01</b>	
Drawing-No. <b>ASS 9242 CO</b>	rev01
Customer-No.	SHEET 2 / 4

1

2

3

4

5

6

7

G

H

1

2

3

4

5

6

7

A

A

B

B

C

C

D

D

E

E

F

F

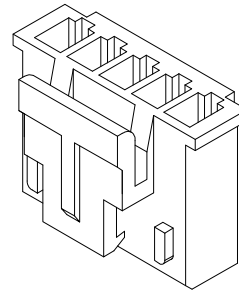
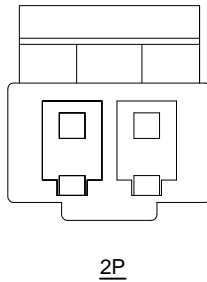
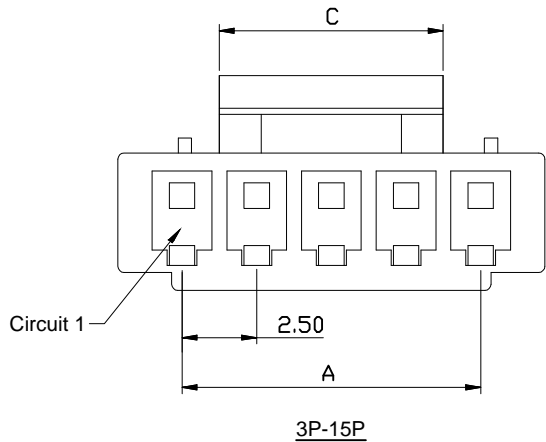

**NOTE:**

- 1.MATERIAL
  - 1.1 Insulator:Nylon 66,UL94V-0,White
- 2.ELECTRIC
  - 2.1 Voltage Rating:500V AC/DC
  - 2.2 Current Rating:3A AC/DC
  - 2.3 Withstanding Voltage:1000V AC/minute
  - 2.4 Insulation Resistance:500MQ Min.
- 3. Temperature Range:-40°C To +105°C
- 4.Packing:PE Bag

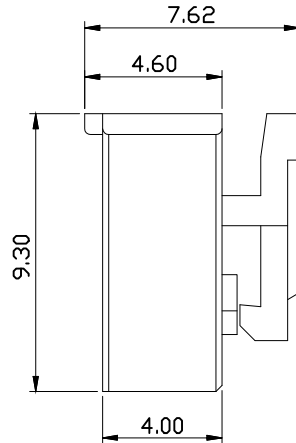
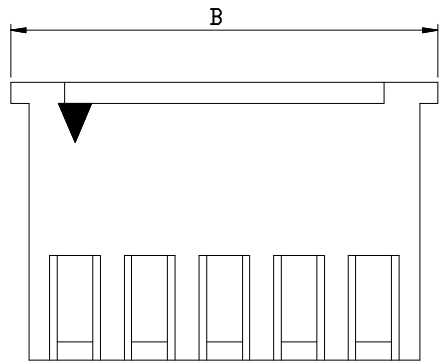

Poles	Part No.	Dimensions (mm)		
		A	B	C
02	A-WBH-L005EG-02CB01	2.50	6.80	5.00
03	A-WBH-L005EG-03CB01	5.00	9.30	5.00
04	A-WBH-L005EG-04CB01	7.50	11.80	5.00
05	A-WBH-L005EG-05CB01	10.00	14.30	7.50
06	A-WBH-L005EG-06CB01	12.50	16.80	10.00
07	A-WBH-L005EG-07CB01	15.00	19.30	12.50
08	A-WBH-L005EG-08CB01	17.50	21.80	15.00
09	A-WBH-L005EG-09CB01	20.00	24.30	17.50
10	A-WBH-L005EG-10CB01	22.50	26.80	20.00
11	A-WBH-L005EG-11CB01	25.00	29.30	22.00
12	A-WBH-L005EG-12CB01	27.50	31.80	22.50
13	A-WBH-L005EG-13CB01	30.00	34.30	22.50
14	A-WBH-L005EG-14CB01	32.50	36.80	25.00
15	A-WBH-L005EG-15CB01	35.00	39.30	27.50

RoHS compliant  
unit:mm

Scale	Free
TOLERANCE	
X.	±0.35
X.X	±0.25
X.XX	±0.20
X.XXX	±0.15
DIM	TOL
Angle	TOL

①	Add UL E-No. on page 1,2	16.03.2023	Peter
②	Drawn	08.03.2022	Peter
Id.	modification	Date	Name

Date: 08.03.2022  
Name: Peter  
Drawn

Date: 03.16.2023  
Name: Peter  
Approved

Description: Wire to Board Housing  
Pitch2.50mm

ASSMANN WSW-NO.  
**A-WBH-L005EG-xxCB01**

Drawing-No. ASS 9242 CO rev01

Customer-No. SHEET 3 / 4

1

2

3

4

5

6

7

H

H

1

2

3

4

5

6

7

A

A

B

B

C

C

D

D

E

E

F

F

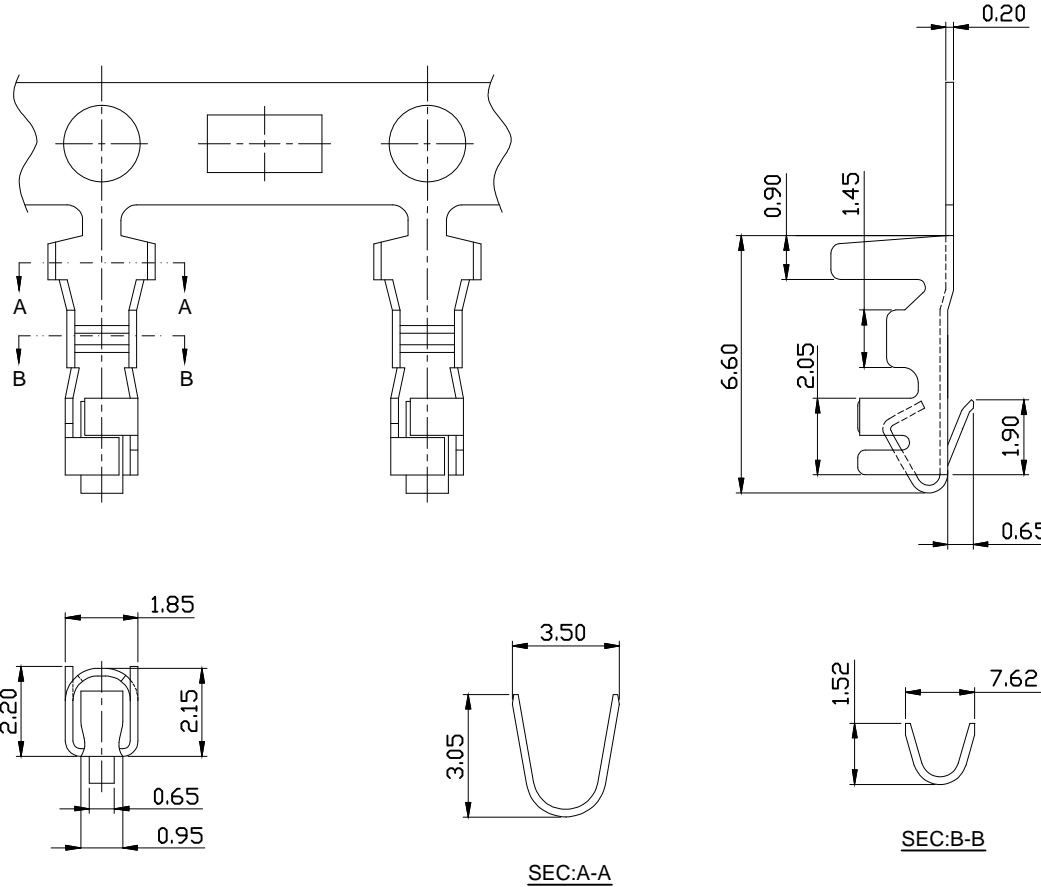
**NOTE:**

- 1.MATERIAL
  - 1.1 Contact:Phosphor Bronze,Tin oner Nickel
- 2.ELECTRIC
  - 2.1 Voltage Rating:500V AC/DC
  - 2.2 Current Rating:3A AC/DC
  - 2.3 Withstanding Voltage:1000V AC/minute
  - 2.4 Insulation Resistance:500MΩ Min.
  - 2.5 Contact Resisistance:20mΩ Max
- 3.Temperature Range:-40°C To +105°C
- 4.Applicable Wire:AWG22#-#28
- 5.Packing:Reel

G

G

RoHS compliant  
unit:mm

Scale Free

TOLERANCE

X. ±0.35

X.X ±0.25

X.XX ±0.20

X.XXX ±0.15

DIM TOL

Angle TOL

①

②

Id.

Add UL E-No. on page 1,2

Drawn

modification

16.03.2023

08.03.2022

Date

Peter

Peter

Name

Date

Name

Drawn

08.03.2022

Peter

Approved

03.16.2023

Peter

Description: Wire to Board Terminal  
Pitch2.50mm

ASSMANN WSW-NO.

A-WBT-L005EG-01CR01

Drawing-No.

ASS 9242 CO

rev01

Customer-No.

SHEET  
4 / 4

H

H

1

2

3

4

5

6

7