

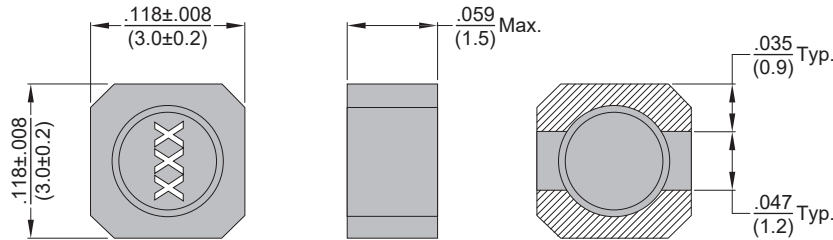

Shielded Power Inductor

PCS3X15

Dimensions: $\frac{\text{Inches}}{\text{(mm)}}$



| Allied Part Number | Inductance (μH) | Tolerance (±%) | Test Freq. (KHz) | DCR (Ω) Max | Isat (A) Max | Irms (A) Typ | Marking |
|--------------------|-----------------|----------------|------------------|-------------|--------------|--------------|---------|
| PCS3X15-1R0M | 1.0 | 20 | 100, 0.1V | .075 | 2.0 | 2.0 | 1R0 |
| PCS3X15-1R5M | 1.5 | 20 | 100, 0.1V | .100 | 1.8 | 1.7 | 1R5 |
| PCS3X15-1R8M | 1.8 | 20 | 100, 0.1V | .100 | 1.5 | 1.4 | 1R8 |
| PCS3X15-2R1M | 2.1 | 20 | 100, 0.1V | .110 | 1.5 | 1.4 | 2R1 |
| PCS3X15-2R2M | 2.2 | 20 | 100, 0.1V | .110 | 1.5 | 1.4 | 2R2 |
| PCS3X15-3R3M | 3.3 | 20 | 100, 0.1V | .130 | 1.3 | 1.4 | 3R3 |
| PCS3X15-4R7M | 4.7 | 20 | 100, 0.1V | .200 | 1.1 | 1.2 | 4R7 |
| PCS3X15-6R8M | 6.8 | 20 | 100, 0.1V | .300 | .91 | .90 | 6R8 |
| PCS3X15-100M | 10 | 20 | 100, 0.1V | .440 | .65 | .75 | 100 |
| PCS3X15-150M | 15 | 20 | 100, 0.1V | .700 | .55 | .59 | 150 |
| PCS3X15-180M | 18 | 20 | 100, 0.1V | .750 | .53 | .58 | 180 |
| PCS3X15-220M | 22 | 20 | 100, 0.1V | .825 | .49 | .57 | 220 |
| PCS3X15-330M | 33 | 20 | 100, 0.1V | 1.30 | .42 | .48 | 330 |
| PCS3X15-470M | 47 | 20 | 100, 0.1V | 1.55 | .32 | .40 | 470 |
| PCS3X15-680M | 68 | 20 | 100, 0.1V | 2.25 | .28 | .33 | 680 |
| PCS3X15-101M | 100 | 20 | 100, 0.1V | 3.40 | .23 | .26 | 101 |
| PCS3X15-471M | 470 | 20 | 100, 0.1V | 15.0 | .11 | .11 | 471 |

All specifications subject to change without notice.

Features

- SMD Power Inductor
- Magnetically shielded
- Low DC resistance
- MSL Level 1

Electrical

Inductance Range: 1.0μH to 470μH

Tolerance: ±20% throughout series

Operating Temp: -40°C to +125°C

Isat: Current at which Inductance drops by no more than 30% of initial value

Irms: Current that causes the temperature to rise (ΔT=40°C) from 25°C ambient.

Schematic

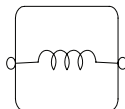

Recommended Pad Layout

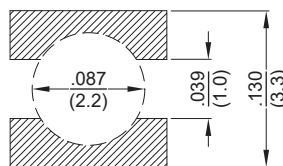

Physical

Packaging: 1000 pieces per 7 inch reel

Marking: EIA Code