

TOLERANCE UNLESS OTHERWISE SPECIFIED	
0-10	±0.20
10-30	±0.30
30-100	±0.40

THIS IS A C.A.D. GENERATED DRAWING  
DO NOT MAKE MANUAL REVISIONS TO MASTER.

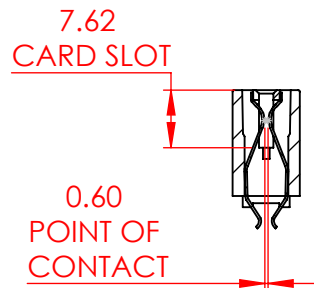

ISSUE NUMBER	
ORIGINAL	①

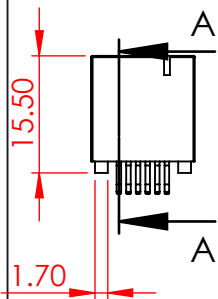
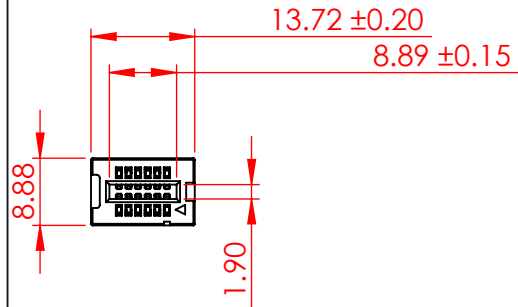

SECTION A-A  
SCALE 1 : 1

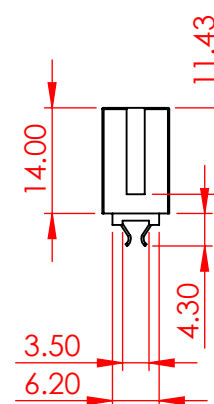

#### SPECIFICATIONS:

MATERIAL:

HOUSING:

CONTACT:

PLATING:

HI-TEMP THERMOPLASTIC, PPS

COPPER ALLOY

30μ" GOLD PLATING ON CONTACT AREA,

TIN PLATING ON SOLDERING AREA

#### ELECTRICAL

VOLTAGE RATING:

250 VAC RMS

CURRENT RATING:

1A

DIELECTRIC

WITHSTANDING VOLTAGE: 500VAC RMS 60Hz FOR 60s

INSULATION RESISTANCE: 1000 MEGA OHMS MIN AT 500VDC

CONTACT RESISTANCE: 30 mOHMS MAX

#### MECHANICAL

RETENTION FORCE:

460g MIN PER CONTACT

INSERTION FORCE:

230g MAX PER CONTACT PAIR

WITHDRAWAL FORCE:

15g MIN PER CONTACT PAIR

#### ENVIRONMENTAL

TEMPERATURE RANGE:

-55°C TO +105°C

#### NOTE:

4 TO 124 POSITIONS ARE AVAILABLE EXCEPT 18, 28, 34, 38, 42 TO 46,  
54 TO 58 POSITIONS



THIS SERIES FULLY CONFORMS TO  
THE EUROPEAN UNION DIRECTIVES  
2011/65/EU FOR RoHS COMPLIANCY.



YOUR CONNECTION TO QUALITY & SERVICE

EDAC INC  
TORONTO, ONTARIO  
CANADA

THESE DRAWINGS AND SPECIFICATIONS  
ARE THE PROPERTY OF EDAC INC., AND  
SHALL NOT BE REPRODUCED, OR COPIED  
OR USED AS THE BASIS FOR THE  
MANUFACTURE OR SALE OF APPARATUS  
WITHOUT WRITTEN PERMISSION.

802 SERIES CARD EDGE CONNECTOR		ACAD REFERENCE NO.: 802 Assembly	UNIT: MM
		DRAWN: J.L.	DATE: June 6, 2023
		CHECKED:	DATE:
		SCALE: 1:1	SHEET 1 OF 1
<div> <div>EDAC</div> <div>EDAC INC TORONTO, ONTARIO CANADA</div> <div>YOUR CONNECTION TO QUALITY &amp; SERVICE</div> </div>		DRAWING NUMBER: 802-012-656-201	ISSUE
		PART NUMBER: 802-012-656-201	1