

# UTTB 2,5-MT-P/P BU - Knife-disconnect terminal block



3044641

<https://www.phoenixcontact.com/us/products/3044641>

Please be informed that the data shown in this PDF document is generated from our online catalog. Please find the complete data in the user documentation. Our general terms of use for downloads are valid.

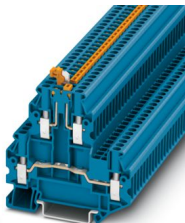

Knife-disconnect terminal block, With test socket screws for insertion of test plugs, nom. voltage: 400 V, nominal current: 22 A, connection method: Screw connection, Rated cross section: 2.5 mm<sup>2</sup>, cross section: 0.14 mm<sup>2</sup> - 4 mm<sup>2</sup>, connection method: Screw connection, Rated cross section: 2.5 mm<sup>2</sup>, cross section: 0.14 mm<sup>2</sup> - 4 mm<sup>2</sup>, mounting: NS 35/7,5, NS 35/15, color: blue

## Your advantages

- For a clear overview, each terminal point supports large-surface labeling
- Convenient separation of circuits, thanks to lever-type disconnect knife
- For example, two separate potentials can be routed side by side with the help of bridging between non-adjacent terminal blocks

## Commercial data

|                                      |                     |
|--------------------------------------|---------------------|
| Item number                          | 3044641             |
| Packing unit                         | 50 pc               |
| Minimum order quantity               | 50 pc               |
| Sales key                            | BE01                |
| Product key                          | BE1131              |
| Catalog page                         | Page 152 (C-1-2019) |
| GTIN                                 | 4046356894050       |
| Weight per piece (including packing) | 17.645 g            |
| Weight per piece (excluding packing) | 17.584 g            |
| Customs tariff number                | 85369010            |
| Country of origin                    | PL                  |

# UTTB 2,5-MT-P/P BU - Knife-disconnect terminal block



3044641

<https://www.phoenixcontact.com/us/products/3044641>

## Technical data

### Product properties

|                       |                           |
|-----------------------|---------------------------|
| Product type          | Disconnect terminal block |
| Number of connections | 4                         |
| Number of rows        | 2                         |
| Potentials            | 2                         |

### Insulation characteristics

|                      |     |
|----------------------|-----|
| Overvoltage category | III |
| Degree of pollution  | 3   |

### Electrical properties

|   |        |
|---|--------|
| Rated surge voltage                             | 6 kV   |
| Maximum power dissipation for nominal condition | 0.77 W |

### Connection data

|                                 |                     |
|---------------------------------|---------------------|
| Number of connections per level | 2                   |
| Nominal cross section           | 2.5 mm <sup>2</sup> |

#### Level 1

|   |  |
|---|--|
| Screw thread  | M3   |
| Tightening torque   | 0.5 ... 0.6 Nm   |
| Stripping length  | 9 mm   |
| Internal cylindrical gage   | A3   |
| Connection in acc. with standard  | IEC 60947-7-1  |
| Conductor cross section rigid   | 0.14 mm <sup>2</sup> ... 4 mm <sup>2</sup>   |
| Cross section AWG   | 26 ... 12 (converted acc. to IEC)  |
| Conductor cross section flexible  | 0.14 mm <sup>2</sup> ... 4 mm <sup>2</sup>   |
| Conductor cross section, flexible [AWG]   | 26 ... 12 (converted acc. to IEC)  |
| Conductor cross-section flexible (ferrule without plastic sleeve)                         | 0.14 mm <sup>2</sup> ... 2.5 mm <sup>2</sup>   |
| Flexible conductor cross section (ferrule with plastic sleeve)                            | 0.14 mm <sup>2</sup> ... 2.5 mm <sup>2</sup>   |
| 2 conductors with same cross section, solid   | 0.14 mm <sup>2</sup> ... 1.5 mm <sup>2</sup>   |
| 2 conductors with same cross section, flexible  | 0.14 mm <sup>2</sup> ... 1.5 mm <sup>2</sup>   |
| 2 conductors with same cross section, flexible, with ferrule without plastic sleeve       | 0.14 mm <sup>2</sup> ... 1.5 mm <sup>2</sup>   |
| 2 conductors with the same cross section, flexible, with TWIN ferrule with plastic sleeve | 0.5 mm <sup>2</sup> ... 1.5 mm <sup>2</sup>  |
| Nominal current   | 22 A   |
| Maximum load current  | 24 A (in case of a 4 mm <sup>2</sup> conductor cross section, the maximum load current must not be exceeded by the total current of all connected conductors.) |
| Nominal voltage   | 400 V  |
| Nominal cross section   | 2.5 mm <sup>2</sup>  |

#### Level 2

# UTTB 2,5-MT-P/P BU - Knife-disconnect terminal block



3044641

<https://www.phoenixcontact.com/us/products/3044641>

|   |  |
|---|--|
| Screw thread  | M3   |
| Tightening torque   | 0.5 ... 0.6 Nm   |
| Stripping length  | 9 mm   |
| Internal cylindrical gage   | A3   |
| Connection in acc. with standard                                  | IEC 60947-7-1  |
| Conductor cross section rigid                                     | 0.14 mm <sup>2</sup> ... 4 mm <sup>2</sup>   |
| Cross section AWG   | 26 ... 12 (converted acc. to IEC)  |
| Conductor cross section flexible                                  | 0.14 mm <sup>2</sup> ... 4 mm <sup>2</sup>   |
| Conductor cross section, flexible [AWG]                           | 26 ... 12 (converted acc. to IEC)  |
| Conductor cross-section flexible (ferrule without plastic sleeve) | 0.14 mm <sup>2</sup> ... 2.5 mm <sup>2</sup>   |
| Flexible conductor cross section (ferrule with plastic sleeve)    | 0.14 mm <sup>2</sup> ... 2.5 mm <sup>2</sup>   |
| 2 conductors with same cross section, solid                       | 0.14 mm <sup>2</sup> ... 1.5 mm <sup>2</sup>   |
| 2 conductors with same cross section, flexible                    | 0.14 mm <sup>2</sup> ... 1.5 mm <sup>2</sup>   |
| Nominal current   | 16 A   |
| Maximum load current  | 16 A (in case of a 4 mm <sup>2</sup> conductor cross section, the maximum load current must not be exceeded by the total current of all connected conductors.) |
| Nominal voltage   | 400 V  |
| Nominal cross section   | 2.5 mm <sup>2</sup>  |

## Dimensions

|                    |         |
|--------------------|---------|
| Width              | 5.2 mm  |
| End cover width    | 2.2 mm  |
| Height             | 69.9 mm |
| Depth              | 64.4 mm |
| Depth on NS 35/7,5 | 65 mm   |
| Depth on NS 35/15  | 72.5 mm |

## Material specifications

|   |             |
|---|-------------|
| Color   | blue        |
| Flammability rating according to UL 94                                  | V0          |
| Insulating material group   | I           |
| Insulating material   | PA          |
| Static insulating material application in cold                          | -60 °C      |
| Temperature index of insulation material (DIN EN 60216-1 (VDE 0304-21)) | 125 °C      |
| Relative insulation material temperature index (Elec., UL 746 B)        | 130 °C      |
| Fire protection for rail vehicles (DIN EN 45545-2) R22                  | HL 1 - HL 3 |
| Fire protection for rail vehicles (DIN EN 45545-2) R23                  | HL 1 - HL 3 |
| Fire protection for rail vehicles (DIN EN 45545-2) R24                  | HL 1 - HL 3 |
| Fire protection for rail vehicles (DIN EN 45545-2) R26                  | HL 1 - HL 3 |
| Calorimetric heat release NFPA 130 (ASTM E 1354)                        | 27,5 MJ/kg  |
| Surface flammability NFPA 130 (ASTM E 162)                              | passed      |
| Specific optical density of smoke NFPA 130 (ASTM E 662)                 | passed      |
| Smoke gas toxicity NFPA 130 (SMP 800C)                                  | passed      |

# UTTB 2,5-MT-P/P BU - Knife-disconnect terminal block



3044641

<https://www.phoenixcontact.com/us/products/3044641>

## Mechanical properties

### Mechanical data

|                 |     |
|-----------------|-----|
| Open side panel | Yes |
|-----------------|-----|

## Environmental and real-life conditions

### Ambient conditions

|  |  |
|--|--|
| Ambient temperature (operation)          | -60 °C ... 110 °C (Operating temperature range incl. self-heating; for max. short-term operating temperature, see RTI Elec.) |
| Ambient temperature (storage/transport)  | -25 °C ... 60 °C (for a short time, not exceeding 24 h, -60 °C to +70 °C)  |
| Ambient temperature (assembly)           | -5 °C ... 70 °C  |
| Ambient temperature (actuation)          | -5 °C ... 70 °C  |
| Permissible humidity (operation)         | 20 % ... 90 %  |
| Permissible humidity (storage/transport) | 30 % ... 70 %  |

## Standards and regulations

|                                  |               |
|----------------------------------|---------------|
| Connection in acc. with standard | IEC 60947-7-1 |
|                                  | IEC 60947-7-1 |

## Mounting

|               |           |
|---------------|-----------|
| Mounting type | NS 35/7,5 |
|               | NS 35/15  |

## Drawings

Circuit diagram



# UTTB 2,5-MT-P/P BU - Knife-disconnect terminal block



3044641

<https://www.phoenixcontact.com/us/products/3044641>

## Approvals

To download certificates, visit the product detail page: <https://www.phoenixcontact.com/us/products/3044641>

|  <b>CSA</b><br>Approval ID: 13631 |                       |                       |                   |                             |
|--|-----------------------|-----------------------|-------------------|-----------------------------|
|  | Nominal voltage $U_N$ | Nominal current $I_N$ | Cross section AWG | Cross section $\text{mm}^2$ |
| Use group B  |                       |                       |                   |                             |
| upper level  | 300 V                 | 16 A                  | 26 - 12           | -                           |
| lower level  | 300 V                 | 20 A                  | 26 - 12           | -                           |
| Use group C  |                       |                       |                   |                             |
| upper level  | 300 V                 | 16 A                  | 26 - 12           | -                           |
| lower level  | 300 V                 | 20 A                  | 26 - 12           | -                           |

|  <b>EAC</b><br>Approval ID: RU C-DE.BL08.B.00534 |  |  |  |  |
|---|--|--|--|--|
|---|--|--|--|--|

|  <b>cULus Recognized</b><br>Approval ID: E60425 |                       |                       |                   |                             |
|--|-----------------------|-----------------------|-------------------|-----------------------------|
|  | Nominal voltage $U_N$ | Nominal current $I_N$ | Cross section AWG | Cross section $\text{mm}^2$ |
| Use group B  |                       |                       |                   |                             |
| upper level  | 300 V                 | 16 A                  | 26 - 12           | -                           |
| lower level  | 300 V                 | 20 A                  | 26 - 12           | -                           |
| Use group C  |                       |                       |                   |                             |
| upper level  | 300 V                 | 16 A                  | 26 - 12           | -                           |
| lower level  | 300 V                 | 20 A                  | 26 - 12           | -                           |

# UTTB 2,5-MT-P/P BU - Knife-disconnect terminal block



3044641

<https://www.phoenixcontact.com/us/products/3044641>

## Classifications

### ECLASS

|             |          |
|-------------|----------|
| ECLASS-11.0 | 27141126 |
| ECLASS-12.0 | 27141126 |
| ECLASS-13.0 | 27250108 |

### ETIM

|          |          |
|----------|----------|
| ETIM 9.0 | EC000902 |
|----------|----------|

### UNSPSC

|             |          |
|-------------|----------|
| UNSPSC 21.0 | 39121400 |
|-------------|----------|

Environmental product compliance

|   |   |
|---|---|
| EU RoHS                                 |   |
| Fulfills EU RoHS substance requirements | Yes   |
| Exemption                               | 6(c)  |
| China RoHS                              |   |
| Environment friendly use period (EFUP)  | EFUP-50   |
|   | An article-related China RoHS declaration table can be found in the download area for the respective article under "Manufacturer declaration". For all articles with EFUP-E, no China RoHS declaration table issued and required. |
| EU REACH SVHC                           |   |
| REACH candidate substance (CAS No.)     | Lead(CAS: 7439-92-1)  |
| SCIP                                    | 73779f43-9d9e-4f24-8bf3-63b06b786436  |



# UTTB 2,5-MT-P/P BU - Knife-disconnect terminal block



3044641

<https://www.phoenixcontact.com/us/products/3044641>

## Accessories

**i** Note: Applying some accessories below might limit this product.

### FBS 2-5 - Plug-in bridge

3030161

<https://www.phoenixcontact.com/us/products/3030161>



Plug-in bridge, pitch: 5.2 mm, number of positions: 2, length: 23 mm, color: red

**i** Max. current carrying capacity: 22 A

---

### FBS 3-5 - Plug-in bridge

3030174

<https://www.phoenixcontact.com/us/products/3030174>



Plug-in bridge, pitch: 5.2 mm, number of positions: 3, length: 23 mm, color: red

**i** Max. current carrying capacity: 22 A

---

# UTTB 2,5-MT-P/P BU - Knife-disconnect terminal block



3044641

<https://www.phoenixcontact.com/us/products/3044641>

## FBS 4-5 - Plug-in bridge

3030187

<https://www.phoenixcontact.com/us/products/3030187>



Plug-in bridge, pitch: 5.2 mm, number of positions: 4, length: 23 mm, color: red

 Max. current carrying capacity: 22 A

---

## FBS 5-5 - Plug-in bridge

3030190

<https://www.phoenixcontact.com/us/products/3030190>



Plug-in bridge, pitch: 5.2 mm, number of positions: 5, length: 23 mm, color: red

 Max. current carrying capacity: 22 A

# UTTB 2,5-MT-P/P BU - Knife-disconnect terminal block



3044641

<https://www.phoenixcontact.com/us/products/3044641>

## FBS 10-5 - Plug-in bridge

3030213

<https://www.phoenixcontact.com/us/products/3030213>



Plug-in bridge, pitch: 5.2 mm, number of positions: 10, length: 23 mm, color: red

 Max. current carrying capacity: 22 A

---

## FBS 20-5 - Plug-in bridge

3030226

<https://www.phoenixcontact.com/us/products/3030226>



Plug-in bridge, pitch: 5.2 mm, number of positions: 20, color: red

 Max. current carrying capacity: 22 A

# UTTB 2,5-MT-P/P BU - Knife-disconnect terminal block



3044641

<https://www.phoenixcontact.com/us/products/3044641>

## FBS 50-5 - Plug-in bridge

3038930

<https://www.phoenixcontact.com/us/products/3038930>



Plug-in bridge, pitch: 5.2 mm, number of positions: 50, color: red

 Max. current carrying capacity: 22 A

---

## FBSR 2-5 - Plug-in bridge

3033702

<https://www.phoenixcontact.com/us/products/3033702>



Plug-in bridge, pitch: 5.2 mm, number of positions: 2, color: red

 Max. current carrying capacity: 17.5 A

# UTTB 2,5-MT-P/P BU - Knife-disconnect terminal block



3044641

<https://www.phoenixcontact.com/us/products/3044641>

## FBSR 3-5 - Plug-in bridge

3001591

<https://www.phoenixcontact.com/us/products/3001591>



Plug-in bridge, pitch: 5.2 mm, number of positions: 3, color: red

 Max. current carrying capacity: 17.5 A

---

## FBSR 4-5 - Plug-in bridge

3001592

<https://www.phoenixcontact.com/us/products/3001592>



Plug-in bridge, pitch: 5.2 mm, number of positions: 4, color: red

 Max. current carrying capacity: 17.5 A

# UTTB 2,5-MT-P/P BU - Knife-disconnect terminal block



3044641

<https://www.phoenixcontact.com/us/products/3044641>

## FBSR 5-5 - Plug-in bridge

3001593

<https://www.phoenixcontact.com/us/products/3001593>



Plug-in bridge, pitch: 5.2 mm, number of positions: 5, color: red

 Max. current carrying capacity: 17.5 A

---

## FBSR 10-5 - Plug-in bridge

3033710

<https://www.phoenixcontact.com/us/products/3033710>



Plug-in bridge, pitch: 5.2 mm, number of positions: 10, color: red

 Max. current carrying capacity: 17.5 A

# UTTB 2,5-MT-P/P BU - Knife-disconnect terminal block



3044641

<https://www.phoenixcontact.com/us/products/3044641>

## FBS 2-5 BU - Plug-in bridge

3036877

<https://www.phoenixcontact.com/us/products/3036877>



Plug-in bridge, pitch: 5.2 mm, number of positions: 2, color: blue

 Max. current carrying capacity: 22 A

---

## FBS 3-5 BU - Plug-in bridge

3036880

<https://www.phoenixcontact.com/us/products/3036880>



Plug-in bridge, pitch: 5.2 mm, number of positions: 3, color: blue

 Max. current carrying capacity: 22 A

# UTTB 2,5-MT-P/P BU - Knife-disconnect terminal block



3044641

<https://www.phoenixcontact.com/us/products/3044641>

## FBS 4-5 BU - Plug-in bridge

3036893

<https://www.phoenixcontact.com/us/products/3036893>



Plug-in bridge, pitch: 5.2 mm, number of positions: 4, color: blue

 Max. current carrying capacity: 22 A

---

## FBS 5-5 BU - Plug-in bridge

3036903

<https://www.phoenixcontact.com/us/products/3036903>



Plug-in bridge, pitch: 5.2 mm, number of positions: 5, color: blue

 Max. current carrying capacity: 22 A



# UTTB 2,5-MT-P/P BU - Knife-disconnect terminal block



3044641

<https://www.phoenixcontact.com/us/products/3044641>

## FBS 10-5 BU - Plug-in bridge

3036916

<https://www.phoenixcontact.com/us/products/3036916>



Plug-in bridge, pitch: 5.2 mm, number of positions: 10, color: blue

 Max. current carrying capacity: 22 A

---

## FBS 20-5 BU - Plug-in bridge

3036929

<https://www.phoenixcontact.com/us/products/3036929>



Plug-in bridge, pitch: 5.2 mm, number of positions: 20, color: blue

 Max. current carrying capacity: 22 A

# UTTB 2,5-MT-P/P BU - Knife-disconnect terminal block



3044641

<https://www.phoenixcontact.com/us/products/3044641>

## FBS 50-5 BU - Plug-in bridge

3032114

<https://www.phoenixcontact.com/us/products/3032114>



Plug-in bridge, pitch: 5.2 mm, number of positions: 50, color: blue

 Max. current carrying capacity: 22 A

---

## D-UTTB 2,5/4 - End cover

3047293

<https://www.phoenixcontact.com/us/products/3047293>



End cover, depth: 57.5 mm, width: 2.2 mm, height: 69.9 mm, color: gray

## UTTB 2,5-MT-P/P BU - Knife-disconnect terminal block



3044641

<https://www.phoenixcontact.com/us/products/3044641>

### DP-UTTB 2,5/4 - Spacer plate

3047303

<https://www.phoenixcontact.com/us/products/3047303>

Spacer plate, depth: 33 mm, width: 2.6 mm, height: 69.9 mm, color: gray



---

### S-MT - Switching lock

3247954

<https://www.phoenixcontact.com/us/products/3247954>

Switching lock, depth: 23.1 mm, width: 3.5 mm, height: 10.5 mm, color: white



# UTTB 2,5-MT-P/P BU - Knife-disconnect terminal block



3044641

<https://www.phoenixcontact.com/us/products/3044641>

## P-CO 2-5 R47K - Component connector

3032447

<https://www.phoenixcontact.com/us/products/3032447>



Component connector, with 47 kOhm resistance for wire-break monitoring, pitch: 5.2 mm, depth: 34.8 mm, width: 4.1 mm, height: 8.9 mm, number of positions: 2, color: black

---

## LPO 2,5/E - Pick-off plug

3270516

<https://www.phoenixcontact.com/us/products/3270516>



Pick-off plug, nom. voltage: 800 V, nominal current: 24 A, number of positions: 1, connection method: Push-in connection, Rated cross section: 2.5 mm<sup>2</sup>, cross section: 0.14 mm<sup>2</sup> - 4 mm<sup>2</sup>, color: gray

# UTTB 2,5-MT-P/P BU - Knife-disconnect terminal block



3044641

<https://www.phoenixcontact.com/us/products/3044641>

## LPO 2,5 - Pick-off plug

3270517

<https://www.phoenixcontact.com/us/products/3270517>



Pick-off plug, nom. voltage: 800 V, nominal current: 24 A, number of positions: 1, connection method: Push-in connection, Rated cross section: 2.5 mm<sup>2</sup>, cross section: 0.14 mm<sup>2</sup>- 4 mm<sup>2</sup>, color: gray

---

## LPS-5/E - Service connector

3270520

<https://www.phoenixcontact.com/us/products/3270520>



Service connector, nom. voltage: 800 V, nominal current: 24 A, number of positions: 1, connection method: Push-in connection, Rated cross section: 2.5 mm<sup>2</sup>, cross section: 0.14 mm<sup>2</sup>- 4 mm<sup>2</sup>, color: red

## UTTB 2,5-MT-P/P BU - Knife-disconnect terminal block



3044641

<https://www.phoenixcontact.com/us/products/3044641>

## LPS-5 - Service connector

3270521

<https://www.phoenixcontact.com/us/products/3270521>



Service connector, nom. voltage: 800 V, nominal current: 24 A, number of positions: 1, connection method: Push-in connection, Rated cross section: 2.5 mm<sup>2</sup>, cross section: 0.14 mm<sup>2</sup>- 4 mm<sup>2</sup>, color: red

---

## NS 35/ 7,5 PERF 2000MM - DIN rail perforated

0801733

<https://www.phoenixcontact.com/us/products/0801733>



DIN rail perforated, Pack of 25 (50 m), acc. to EN 60715, material: Steel, galvanized, passivated with a thick layer, Standard profile, color: silver

# UTTB 2,5-MT-P/P BU - Knife-disconnect terminal block



3044641

<https://www.phoenixcontact.com/us/products/3044641>

## NS 35/ 7,5 UNPERF 2000MM - DIN rail, unperforated

0801681

<https://www.phoenixcontact.com/us/products/0801681>



DIN rail, unperforated, Pack of 25 (50 m), acc. to EN 60715, material: Steel, galvanized, passivated with a thick layer, Standard profile, color: silver

---

## NS 35/ 7,5 WH PERF 2000MM - DIN rail perforated

1204119

<https://www.phoenixcontact.com/us/products/1204119>



DIN rail perforated, Pack of 25 (50 m), acc. to EN 60715, material: Steel, Galvanized, white passivated, Standard profile, color: silver

# UTTB 2,5-MT-P/P BU - Knife-disconnect terminal block



3044641

<https://www.phoenixcontact.com/us/products/3044641>

## NS 35/ 7,5 WH UNPERF 2000MM-VPE 10 - DIN rail, unperforated

1204122

<https://www.phoenixcontact.com/us/products/1204122>



DIN rail, unperforated, Pack of 10 (20 m), acc. to EN 60715, material: Steel, Galvanized, white passivated, Standard profile, color: silver

---

## NS 35/ 7,5 AL UNPERF 2000MM - DIN rail, unperforated

0801704

<https://www.phoenixcontact.com/us/products/0801704>



DIN rail, unperforated, Pack of 25 (50 m), acc. to EN 60715, material: Aluminum, uncoated, Standard profile, color: silver



# UTTB 2,5-MT-P/P BU - Knife-disconnect terminal block



3044641

<https://www.phoenixcontact.com/us/products/3044641>

## NS 35/ 7,5 ZN PERF 2000MM - DIN rail perforated

1206421

<https://www.phoenixcontact.com/us/products/1206421>



DIN rail perforated, Pack of 25 (50 m), acc. to EN 60715, material: Steel, galvanized, Standard profile, color: silver

---

## NS 35/ 7,5 ZN UNPERF 2000MM - DIN rail, unperforated

1206434

<https://www.phoenixcontact.com/us/products/1206434>



DIN rail, unperforated, Pack of 25 (50 m), acc. to EN 60715, material: Steel, galvanized, Standard profile, color: silver

# UTTB 2,5-MT-P/P BU - Knife-disconnect terminal block



3044641

<https://www.phoenixcontact.com/us/products/3044641>

## NS 35/ 7,5 CU UNPERF 2000MM-VPE 10 - DIN rail, unperforated

0801762

<https://www.phoenixcontact.com/us/products/0801762>



DIN rail, unperforated, Pack of 10 (20 m), acc. to EN 60715, material: Copper, uncoated, Standard profile, color: copper-colored

---

## NS 35/ 7,5 CAP - End cap

1206560

<https://www.phoenixcontact.com/us/products/1206560>



DIN rail end piece, for DIN rail NS 35/7.5

# UTTB 2,5-MT-P/P BU - Knife-disconnect terminal block



3044641

<https://www.phoenixcontact.com/us/products/3044641>

## ZB 5 :UNBEDRUCKT - Zack marker strip

1050004

<https://www.phoenixcontact.com/us/products/1050004>



Zack marker strip, Strip, white, unlabeled, can be labeled with: PLOTMARK, CMS-P1-PLOTTER, mounting type: snapped, for terminal block width: 5.2 mm, lettering field size: 5.1 x 10.5 mm, Number of individual labels: 10

---

## ZB 5 CUS - Zack marker strip

0824962

<https://www.phoenixcontact.com/us/products/0824962>



Zack marker strip, can be ordered: Strip, white, labeled according to customer specifications, mounting type: snap into tall marker groove, for terminal block width: 5.2 mm, lettering field size: 5.15 x 10.5 mm, Number of individual labels: 10

# UTTB 2,5-MT-P/P BU - Knife-disconnect terminal block



3044641

<https://www.phoenixcontact.com/us/products/3044641>

## ZB 5,LGS:FORTL.ZAHLEN - Zack marker strip

1050017

<https://www.phoenixcontact.com/us/products/1050017>



Zack marker strip, Strip, white, labeled, printed horizontally: consecutive numbers 1 ... 10, 11 ... 20, etc. up to 491 ... 500, mounting type: snapped, for terminal block width: 5.2 mm, lettering field size: 5.15 x 10.5 mm, Number of individual labels: 10

---

## ZB 5,QR:FORTL.ZAHLEN - Zack marker strip

1050020

<https://www.phoenixcontact.com/us/products/1050020>



Zack marker strip, white, Printed vertically: consecutive numbers 1 ... 10, 11 ... 20, etc. up to 491 ... 500, mounting type: snapped, for terminal block width: 5.2 mm, lettering field size: 5.15 x 10.5 mm

# UTTB 2,5-MT-P/P BU - Knife-disconnect terminal block



3044641

<https://www.phoenixcontact.com/us/products/3044641>

## ZB 5,LGS:GLEICHE ZAHLEN - Zack marker strip

1050033

<https://www.phoenixcontact.com/us/products/1050033>



Zack marker strip, Strip, white, labeled, can be labeled with: CMS-P1-PLOTTER, printed horizontally: Identical numbers 1 or 2, etc. up to 100, mounting type: snapped, for terminal block width: 5.2 mm, lettering field size: 5.15 x 10.5 mm, Number of individual labels: 10

---

## ZB 5,LGS:L1-N,PE - Zack marker strip

1050415

<https://www.phoenixcontact.com/us/products/1050415>



Zack marker strip, Strip, white, labeled, horizontal: L1, L2, L3, N, PE, L1, L2, L3, N, PE, mounting type: snapped, for terminal block width: 5.2 mm, lettering field size: 5.15 x 10.5 mm, Number of individual labels: 10

# UTTB 2,5-MT-P/P BU - Knife-disconnect terminal block



3044641

<https://www.phoenixcontact.com/us/products/3044641>

## UC-TM 5 - Marker for terminal blocks

0818108

<https://www.phoenixcontact.com/us/products/0818108>



Marker for terminal blocks, Sheet, white, unlabeled, can be labeled with: BLUEMARK ID COLOR, BLUEMARK ID, BLUEMARK CLED, PLOTMARK, CMS-P1-PLOTTER, mounting type: snapped, for terminal block width: 5.2 mm, lettering field size: 4.6 x 10.5 mm, Number of individual labels: 96

---

## UC-TM 5 CUS - Marker for terminal blocks

0824581

<https://www.phoenixcontact.com/us/products/0824581>



Marker for terminal blocks, can be ordered: by sheet, white, labeled according to customer specifications, mounting type: snap into tall marker groove, for terminal block width: 5.2 mm, lettering field size: 10.5 x 4.6 mm, Number of individual labels: 96

# UTTB 2,5-MT-P/P BU - Knife-disconnect terminal block



3044641

<https://www.phoenixcontact.com/us/products/3044641>

## UCT-TM 5 - Marker for terminal blocks

0828734

<https://www.phoenixcontact.com/us/products/0828734>



Marker for terminal blocks, Sheet, white, unlabeled, can be labeled with: TOPMARK NEO, TOPMARK LASER, BLUEMARK ID COLOR, BLUEMARK ID, BLUEMARK CLED, THERMOMARK PRIME, THERMOMARK CARD 2.0, THERMOMARK CARD, mounting type: snapped, for terminal block width: 5.2 mm, lettering field size: 4.6 x 10.5 mm, Number of individual labels: 72

---

## UCT-TM 5 CUS - Marker for terminal blocks

0829595

<https://www.phoenixcontact.com/us/products/0829595>



Marker for terminal blocks, can be ordered: by sheet, white, labeled according to customer specifications, mounting type: snap into tall marker groove, for terminal block width: 5.2 mm, lettering field size: 4.6 x 10.5 mm, Number of individual labels: 72

# UTTB 2,5-MT-P/P BU - Knife-disconnect terminal block



3044641

<https://www.phoenixcontact.com/us/products/3044641>

## GBS 5-25X12 - Group marker label for terminal marking

0810588

<https://www.phoenixcontact.com/us/products/0810588>



Group marker label, snaps onto terminal center for screw, spring-cage and quick connection terminal blocks, labeled with a 25 x 12 mm label or manually with the B-STIFT, in the foot part with ZB 5

---

## GBS 5-25X5 - Group marker label for terminal marking

0829126

<https://www.phoenixcontact.com/us/products/0829126>



Group marking label, can be snapped into terminal center for screw, spring-cage, push-in, and fast connection terminal blocks, can be labeled with a 24 x 4 mm label or manually using B-STIFT, in the foot part with ZB 5



# UTTB 2,5-MT-P/P BU - Knife-disconnect terminal block



3044641

<https://www.phoenixcontact.com/us/products/3044641>

## STP 5-2-ZB - Marker carriers

3037643

<https://www.phoenixcontact.com/us/products/3037643>



Marker carriers, snaps into ST 2,5 spring-cage terminal blocks, can be marked with UC-TM 5, UC-TMF 5, UCT-TM 5, UCT-TMF 5, ZB 5, or ZBF 5, gray, unlabeled, mounting type: snapped

---

## MPS-MT - Test plug

0201744

<https://www.phoenixcontact.com/us/products/0201744>



Test plug, with solder connection up to 1 mm<sup>2</sup> conductor cross section, number of positions: 1, color: gray

# UTTB 2,5-MT-P/P BU - Knife-disconnect terminal block



3044641

<https://www.phoenixcontact.com/us/products/3044641>

## MPS-IH WH - Insulating sleeve

0201663

<https://www.phoenixcontact.com/us/products/0201663>

Insulating sleeve, color: white



---

## MPS-IH RD - Insulating sleeve

0201676

<https://www.phoenixcontact.com/us/products/0201676>

Insulating sleeve, color: red



# UTTB 2,5-MT-P/P BU - Knife-disconnect terminal block



3044641

<https://www.phoenixcontact.com/us/products/3044641>

## MPS-IH BU - Insulating sleeve

0201689

<https://www.phoenixcontact.com/us/products/0201689>

Insulating sleeve, color: blue

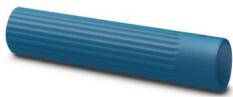

---

## MPS-IH YE - Insulating sleeve

0201692

<https://www.phoenixcontact.com/us/products/0201692>

Insulating sleeve, color: yellow



# UTTB 2,5-MT-P/P BU - Knife-disconnect terminal block



3044641

<https://www.phoenixcontact.com/us/products/3044641>

## MPS-IH GN - Insulating sleeve

0201702

<https://www.phoenixcontact.com/us/products/0201702>

Insulating sleeve, color: green



---

## MPS-IH GY - Insulating sleeve

0201728

<https://www.phoenixcontact.com/us/products/0201728>

Insulating sleeve, color: gray



## UTTB 2,5-MT-P/P BU - Knife-disconnect terminal block

3044641

<https://www.phoenixcontact.com/us/products/3044641>



## MPS-IH BK - Insulating sleeve

0201731

<https://www.phoenixcontact.com/us/products/0201731>

Insulating sleeve, color: black



---

## PAI-4-FIX-5/6 BU - Test adapter

3035975

<https://www.phoenixcontact.com/us/products/3035975>

4 mm test adapter, for terminal blocks with 5.2 mm and 6.2 mm pitch



# UTTB 2,5-MT-P/P BU - Knife-disconnect terminal block



3044641

<https://www.phoenixcontact.com/us/products/3044641>

## PAI-4-FIX-5/6 OG - Test adapter

3035974

<https://www.phoenixcontact.com/us/products/3035974>



4 mm test adapter, for terminal blocks with 5.2 mm and 6.2 mm pitch

---

## PAI-4-FIX-5/6 YE - Test adapter

3035977

<https://www.phoenixcontact.com/us/products/3035977>



4 mm test adapter, for terminal blocks with 5.2 mm and 6.2 mm pitch

# UTTB 2,5-MT-P/P BU - Knife-disconnect terminal block



3044641

<https://www.phoenixcontact.com/us/products/3044641>

## PAI-4-FIX-5/6 RD - Test adapter

3035976

<https://www.phoenixcontact.com/us/products/3035976>



4 mm test adapter, for terminal blocks with 5.2 mm and 6.2 mm pitch

---

## PAI-4-FIX-5/6 GN - Test adapter

3035978

<https://www.phoenixcontact.com/us/products/3035978>



4 mm test adapter, for terminal blocks with 5.2 mm and 6.2 mm pitch

# UTTB 2,5-MT-P/P BU - Knife-disconnect terminal block



3044641

<https://www.phoenixcontact.com/us/products/3044641>

## PAI-4-FIX-5/6 BK - Test adapter

3035980

<https://www.phoenixcontact.com/us/products/3035980>



4 mm test adapter, for terminal blocks with 5.2 mm and 6.2 mm pitch

---

## PAI-4-FIX-5/6 GY - Test adapter

3035982

<https://www.phoenixcontact.com/us/products/3035982>



4 mm test adapter, for terminal blocks with 5.2 mm and 6.2 mm pitch



# UTTB 2,5-MT-P/P BU - Knife-disconnect terminal block



3044641

<https://www.phoenixcontact.com/us/products/3044641>

## PAI-4-FIX-5/6 VT - Test adapter

3035979

<https://www.phoenixcontact.com/us/products/3035979>



4 mm test adapter, for terminal blocks with 5.2 mm and 6.2 mm pitch

---

## PAI-4-FIX-5/6 BN - Test adapter

3035981

<https://www.phoenixcontact.com/us/products/3035981>



4 mm test adapter, for terminal blocks with 5.2 mm and 6.2 mm pitch

# UTTB 2,5-MT-P/P BU - Knife-disconnect terminal block



3044641

<https://www.phoenixcontact.com/us/products/3044641>

## PAI-4-FIX-5/6 WH - Test adapter

3035983

<https://www.phoenixcontact.com/us/products/3035983>



4 mm test adapter, for terminal blocks with 5.2 mm and 6.2 mm pitch

---

## PS-5 - Test plug

3030983

<https://www.phoenixcontact.com/us/products/3030983>



Test plug, Modular test plug, number of positions: 1, color: red

# UTTB 2,5-MT-P/P BU - Knife-disconnect terminal block



3044641

<https://www.phoenixcontact.com/us/products/3044641>

## DP PS-5 - Spacer plate

3036725

<https://www.phoenixcontact.com/us/products/3036725>



Spacer plate, depth: 29 mm, width: 5.2 mm, height: 22.4 mm, number of positions: 1, color: red

---

## PS-5/2,3MM RD - Test plug

3038723

<https://www.phoenixcontact.com/us/products/3038723>



Test plug, number of positions: 1, color: red

# UTTB 2,5-MT-P/P BU - Knife-disconnect terminal block



3044641

<https://www.phoenixcontact.com/us/products/3044641>

## CLIPFIX 35 - End bracket

3022218

<https://www.phoenixcontact.com/us/products/3022218>

Quick mounting end clamp for NS 35/7,5 DIN rail or NS 35/15 DIN rail, with marking option, width: 9.5 mm, color: gray



---

## CLIPFIX 35-5 - End bracket

3022276

<https://www.phoenixcontact.com/us/products/3022276>

Quick mounting end clamp for NS 35/7,5 DIN rail or NS 35/15 DIN rail, with marking option, with parking option for FBS...5, FBS...6, KSS 5, KSS 6, width: 5.15 mm, color: gray



# UTTB 2,5-MT-P/P BU - Knife-disconnect terminal block



3044641

<https://www.phoenixcontact.com/us/products/3044641>

## E/NS 35 N - End bracket

0800886

<https://www.phoenixcontact.com/us/products/0800886>

End clamp, width: 9.5 mm, color: gray

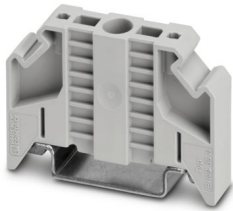

---

## SZG 0,6X3,5 VDE - Screwdriver

1205121

<https://www.phoenixcontact.com/us/products/1205121>

Screwdriver, slot-headed, graded, for test socket screws, size: 0.6 x 3.5 x 100 mm, 2-component grip, with non-slip grip



---

Phoenix Contact 2024 © - all rights reserved  
<https://www.phoenixcontact.com>

Phoenix Contact USA  
586 Fulling Mill Road  
Middletown, PA 17057, United States  
(+717) 944-1300  
[info@phoenixcon.com](mailto:info@phoenixcon.com)