



SSMB Plug Connector Crimp/Solder Attachment for RG188-DS, RG316-DS

RF Connectors Technical Data Sheet

PE45153

Configuration

- SSMB Plug Connector
- MIL-STD-348A
- 50 Ohms
- Straight Body Geometry
- Connector Interface Types: RG188-DS, RG316-DS

Features

- Max. Operating Frequency 6 GHz
- Good VSWR of 1.3:1
- Gold Plated Beryllium Copper Contact
- 30μ in. minimum contact plating

Applications

- General Purpose Test
- Custom Cable Assemblies

Description

Pasternack's PE45153 SSMB plug connector with crimp/solder attachment for RG188-DS and RG316-DS is part of our full line of RF components available for same-day shipping. Our SSMB plug connector operates up to a maximum frequency of 6 GHz and offers good VSWR of 1.3:1.

Our SSMB plug connector PE45153 datasheet specifications and drawing with dimensions are shown below in this PDF. Pasternack's broad catalog of RF, microwave and millimeter wave connectors allows designers to configure and customize their signal connections however they like. Whether the need is to provide an I/O for a board design, or simply create a custom cable assembly configuration, Pasternack has the right connector for the job. Pasternack can also expertly build your custom cable assemblies for you and ship same-day.

Electrical Specifications

Description	Minimum	Typical	Maximum	Units
Frequency Range	DC		6	GHz
VSWR			1.3:1	
Operating Voltage (AC)			250	Vrms
Dielectric Withstanding Voltage (AC)			500	Vrms

Mechanical Specifications

Size	
Length	0.9 in [22.86 mm]
Width/Dia.	0.184 in [4.67 mm]
Weight	0.01 lbs [4.54 g]

Click the following link (or enter part number in "SEARCH" on website) to obtain additional part information including price, inventory and certifications: [SSMB Plug Connector Crimp/Solder Attachment for RG188-DS, RG316-DS PE45153](#)



SSMB Plug Connector Crimp/Solder Attachment for RG188-DS, RG316-DS

RF Connectors Technical Data Sheet

PE45153

Material Specifications

Description	Material	Plating
Contact	Beryllium Copper	Gold 30μ in. minimum
Insulation	Teflon	
Body	Beryllium Copper	Gold 30μ in. minimum

Environmental Specifications

Temperature

Operating Range -65 to +165 deg C

Compliance Certifications (see [product page](#) for current document)

Plotted and Other Data

Notes:

SSMB Plug Connector Crimp/Solder Attachment for RG188-DS, RG316-DS from Pasternack Enterprises has same day shipment for domestic and International orders. Our RF, microwave and millimeter wave products maintain a 99.4% availability and are part of the broadest selection in the industry.

Click the following link (or enter part number in "SEARCH" on website) to obtain additional part information including price, inventory and certifications: [SSMB Plug Connector Crimp/Solder Attachment for RG188-DS, RG316-DS PE45153](#)

URL: <https://www.pasternack.com/ssmb-plug-rg316-ds-rg188-ds-connector-pe45153-p.aspx>

The information contained in this document is accurate to the best of our knowledge and representative of the part described herein. It may be necessary to make modifications to the part and/or the documentation of the part, in order to implement improvements. Pasternack reserves the right to make such changes as required. Unless otherwise stated, all specifications are nominal. Pasternack does not make any representation or warranty regarding the suitability of the part described herein for any particular purpose, and Pasternack does not assume any liability arising out of the use of any part or documentation.

REVISIONS			
REV.	DESCRIPTION	DATE	APPROVED
B	PCR PE45153 20220706	07/21/2022	GUTTADAURO

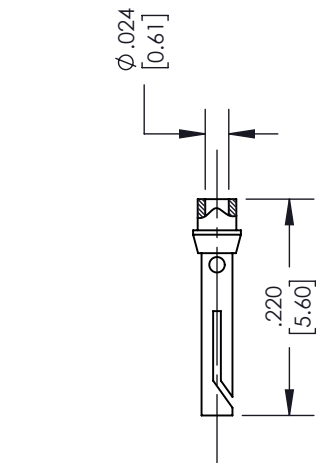

CONTACT

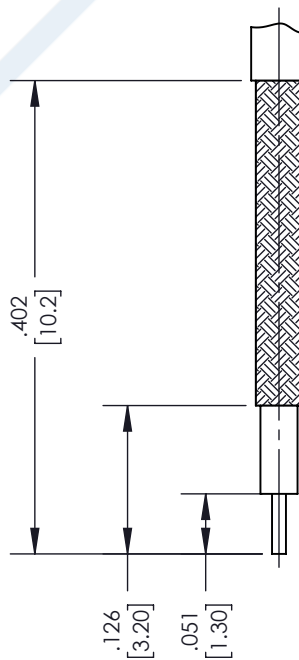
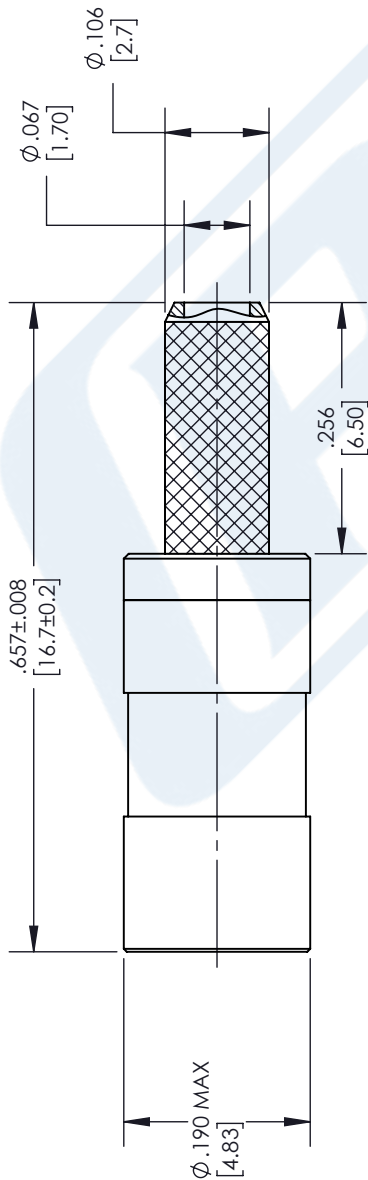

STRIPPING DIMENSIONS

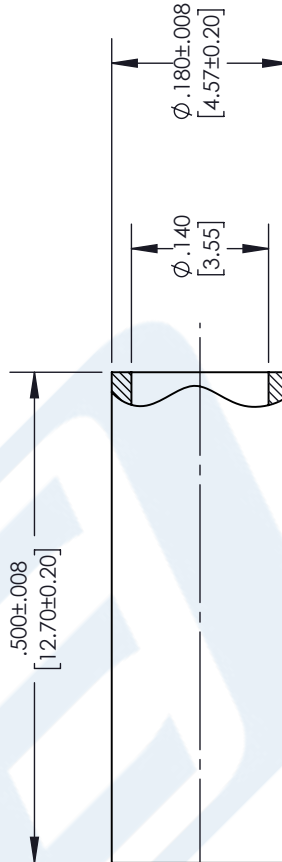

FERRULE

UNLESS OTHERWISE SPECIFIED
LEADING DIMENSIONS ARE INCHES
DIMENSIONS IN [] ARE MILLIMETERS

TOLERANCES:

X = ± 2 [5.08] FRACTIONS
.XX = ± 0.02 [0.51] ANGLES ± 1°
.XXX = ± 0.005 [0.13]

CABLE LENGTH (L) TOLERANCES:

L ≤ 12 [305] = +1 [25] / -0
12 [305] < L ≤ 60 [1524] = +2 [51] / -0
60 [1524] < L ≤ 120 [3048] = +4 [102] / -0
120 [3048] < L ≤ 300 [7620] = +6 [152] / -0
300 [7620] < L = +5% / -0

ALL DIMENSIONS SHOWN
ARE FOR REFERENCE ONLY.

THIRD-ANGLE PROJECTION

THE INFORMATION AND
DESIGN IN THIS DOCUMENT
IS THE PROPERTY OF
PASTERNAK CORPORATION
ALL RIGHTS RESERVED.

SHEET 1 OF 1

SCALE N/A

REV B



Pasternack Enterprises, Inc.
P.O. Box 16759, Irvine, CA 92623.
Phone: 1.949.261.1920 | 1.866.727.8376

Fax: 1.949.261.7451
Website: www.pasternack.com
E-mail: sales@pasternack.com

ITEM NO. PE45153

AKRESOWSK

53919

DRAWN BY

CAGE CODE

53919

AKRESOWSK

53919

DRAWN BY

CAGE CODE

53919

AKRESOWSK

53919

DRAWN BY

CAGE CODE

53919

AKRESOWSK

53919

DRAWN BY

CAGE CODE

53919

AKRESOWSK

53919

DRAWN BY

CAGE CODE

53919

AKRESOWSK

53919

DRAWN BY

CAGE CODE

53919

AKRESOWSK

53919

DRAWN BY

CAGE CODE

53919

AKRESOWSK

53919

DRAWN BY

CAGE CODE

53919

AKRESOWSK

53919

DRAWN BY

CAGE CODE

53919

AKRESOWSK

53919

DRAWN BY

CAGE CODE

53919

AKRESOWSK

53919

DRAWN BY

CAGE CODE

53919

AKRESOWSK

53919

DRAWN BY

CAGE CODE

53919

AKRESOWSK

53919

DRAWN BY

CAGE CODE

53919

AKRESOWSK

53919

DRAWN BY

CAGE CODE

53919

AKRESOWSK

53919

DRAWN BY

CAGE CODE

53919

AKRESOWSK

53919

DRAWN BY

CAGE CODE

53919

AKRESOWSK

53919

DRAWN BY

CAGE CODE

53919

AKRESOWSK

53919

DRAWN BY

CAGE CODE

53919

AKRESOWSK

53919

DRAWN BY

CAGE CODE

53919

AKRESOWSK

53919

DRAWN BY

CAGE CODE

53919

AKRESOWSK

53919

DRAWN BY

CAGE CODE

53919

AKRESOWSK

53919

DRAWN BY

CAGE CODE

53919

AKRESOWSK

53919

DRAWN BY

CAGE CODE

53919

AKRESOWSK

53919

DRAWN BY

CAGE CODE

53919

AKRESOWSK

53919

DRAWN BY

CAGE CODE

53919

AKRESOWSK

53919

DRAWN BY

CAGE CODE

53919

AKRESOWSK

53919

DRAWN BY

CAGE CODE

53919

AKRESOWSK

53919

DRAWN BY

CAGE CODE

53919

AKRESOWSK

53919

DRAWN BY

CAGE CODE

53919

AKRESOWSK

53919

DRAWN BY

CAGE CODE

53919

AKRESOWSK

53919

DRAWN BY

CAGE CODE

53919

AKRESOWSK

53919

DRAWN BY

CAGE CODE

53919

AKRESOWSK

53919

DRAWN BY

CAGE CODE

53919

AKRESOWSK

53919

DRAWN BY

CAGE CODE

53919

AKRESOWSK

53919

DRAWN BY

CAGE CODE

53919

AKRESOWSK

53919

DRAWN BY

CAGE CODE

53919

AKRESOWSK

53919

DRAWN BY

CAGE CODE

53919

AKRESOWSK

53919

DRAWN BY

CAGE CODE

53919

AKRESOWSK

53919

DRAWN BY

CAGE CODE

53919

AKRESOWSK

53919

DRAWN BY

CAGE CODE

53919

AKRESOWSK

53919

DRAWN BY

CAGE CODE

53919

AKRESOWSK

53919

DRAWN BY

CAGE CODE

53919

AKRESOWSK

53919

DRAWN BY

CAGE CODE

53919

AKRESOWSK

53919

DRAWN BY

CAGE CODE

53919

AKRESOWSK

53919

DRAWN BY

CAGE CODE

53919

AKRESOWSK

53919

DRAWN BY

CAGE CODE

53919

AKRESOWSK

53919

DRAWN BY

CAGE CODE

53919

AKRESOWSK

53919

DRAWN BY

CAGE CODE

53919

AKRESOWSK

53919

DRAWN BY

CAGE CODE

53919

AKRESOWSK

53919

DRAWN BY

CAGE CODE

53919

AKRESOWSK

53919

DRAWN BY

CAGE CODE

53919

AKRESOWSK

53919

DRAWN BY