



## SMA Male to 1.0/2.3 Plug Adapter

### RF Adapters Technical Data Sheet

PE9692

#### Configuration

- SMA Male Connector 1
- 1.0/2.3 Plug Connector 2
- 50 Ohms
- Straight Body Geometry

#### Features

- SMA Interface compliant with MIL-STD-348
- 1.0/2.3 Interface compliant with MIL-C-39012
- Gold Plated Contact
- Contact Plating per MIL-G-45204

#### Applications

- Allows Connection Between Series
- General Purpose Test

#### Description

Pasternack's PE9692 SMA male to 1.0/2.3 plug adapter is part of our full line of RF components available for same-day shipping. The SMA connector mates mechanically with commercially available 3.5mm and 2.92mm (K) connectors. Our SMA to 1.0/2.3 adapter has a male to plug gender configuration.

RF adapters are often used to enable connections between two connector types that would otherwise not mate. Certain adapter configurations can also be used to protect connectors on expensive equipment where the number of connect/disconnect cycles is high. An RF, microwave or millimeter wave adapter is connected to the equipment, and the commonly changed connection is made with the adapter which can be easily replaced when it wears out after high usage; such adapters are referred to as connector savers. Pasternack also offers bulkhead, panel mount, hermetically sealed, reverse polarity, and isolated ground adapter varieties to serve all of your RF, microwave and millimeter wave needs.

#### Mechanical Specifications

##### Size

|        |                     |
|--------|---------------------|
| Length | 0.872 in [22.15 mm] |
| Width  | 0.312 in [7.92 mm]  |
| Weight | 0.011 lbs [4.99 g]  |

| Description             | Connector 1                     | Connector 2  |
|-------------------------|---------------------------------|--------------|
| Type                    | SMA Male                        | 1.0/2.3 Plug |
| Polarity                | Standard                        | Standard     |
| Interface Specification | MIL-STD-348                     | MIL-C-39012  |
| Hex Size                | 5/16 in.                        |              |
| Mating Torque           | 3 to 5 in-lbs [0.34 to 0.57 Nm] |              |

Click the following link (or enter part number in "SEARCH" on website) to obtain additional part information including price, inventory and certifications: [SMA Male to 1.0/2.3 Plug Adapter PE9692](#)



## SMA Male to 1.0/2.3 Plug Adapter

### RF Adapters Technical Data Sheet

PE9692

#### Material Specifications

| Description  | Connector 1 |                     | Connector 2  |                     |
|--------------|-------------|---------------------|--------------|---------------------|
|              | Material    | Plating             | Material     | Plating             |
| Type         | SMA Male    |                     | 1.0/2.3 Plug |                     |
| Contact      |             | Gold<br>MIL-G-45204 |              | Gold<br>MIL-G-45204 |
| Insulation   | PTFE        |                     | PTFE         |                     |
| Body         | Brass       | Nickel<br>QQ-N-290  | Brass        | Nickel<br>QQ-N-290  |
| Coupling Nut | Brass       | Nickel<br>QQ-N-290  |              |                     |

#### Environmental Specifications

##### Temperature

Operating Range

-65 to +165 deg C

#### Compliance Certifications (see [product page](#) for current document)

#### Plotted and Other Data

Notes:

SMA Male to 1.0/2.3 Plug Adapter from Pasternack Enterprises has same day shipment for domestic and International orders. Our RF, microwave and millimeter wave products maintain a 99% availability and are part of the broadest selection in the industry.

Click the following link (or enter part number in "SEARCH" on website) to obtain additional part information including price, inventory and certifications: [SMA Male to 1.0/2.3 Plug Adapter PE9692](#)

URL: <https://www.pasternack.com/1.0-2.3-plug-sma-male-straight-adapter-pe9692-p.aspx>

The information contained in this document is accurate to the best of our knowledge and representative of the part described herein. It may be necessary to make modifications to the part and/or the documentation of the part, in order to implement improvements. Pasternack reserves the right to make such changes as required. Unless otherwise stated, all specifications are nominal. Pasternack does not make any representation or warranty regarding the suitability of the part described herein for any particular purpose, and Pasternack does not assume any liability arising out of the use of any part or documentation.

PE9692 CAD Drawing  
SMA Male to 1.0/2.3 Plug Adapter

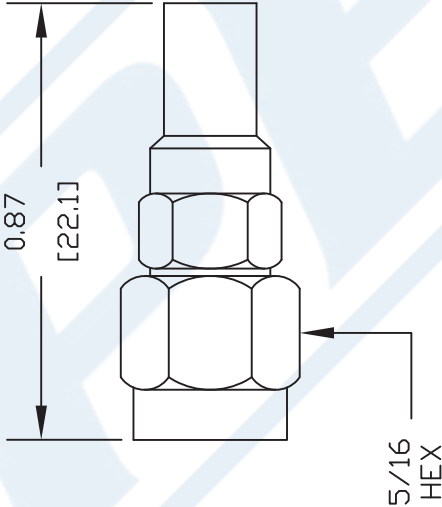

NOTES:  
1. UNLESS OTHERWISE SPECIFIED ALL DIMENSIONS ARE NOMINAL.  
2. ALL SPECIFICATIONS ARE SUBJECT TO CHANGE WITHOUT NOTICE AT ANY TIME.  
3. DIMENSIONS ARE IN INCHES [mm].

DWG TITLE  
**PE9692**

FSCM NO. 53919

CAD FILE 101502

SCALE N/A

SIZE A

127

**PASTERNAK ENTERPRISES, INC.**  
P.O. BOX 16759, IRVINE, CA 92623  
PHONE (949) 261-1920 FAX (949) 261-7451  
WEB ADDRESS: [www.pasternack.com](http://www.pasternack.com)  
E-MAIL ADDRESS: [sales@pasternack.com](mailto:sales@pasternack.com)  
**COAXIAL & FIBER OPTICS**

