



## Summary

[Request a quote](#)[Catalog](#)

Coax	1
Size	3S
Series	S - Indoor Stepped Insert

## Technical details

### Electrical Configuration

Coax	1
Rated current	26 Amps
Cable type	Cable type: A RG 213/U, RG 115 A/U, RG 11 A/U, RG 144/U, RG 165 /U S

### Form & Material

Shell style / Model id	GBA - Locking washer
Housing material	Bronze (nickel plated [SAE AMS QQ N 290]) washer
Keying	No keying
Weight	1.43 g

[https://www.lemo.com/int\\_en/solutions/originals/s-indoor-stepped-insert/gba-3s-250-fn.html](https://www.lemo.com/int_en/solutions/originals/s-indoor-stepped-insert/gba-3s-250-fn.html)

LEMO products and services are provided "as is". LEMO makes no warranties or representations with regard to LEMO product & services or use of them, express, implied or statutory, including for accuracy, completeness, or security. The user is fully responsible for his products and applications using LEMO components.

## Environment

Technical domain	Audio Video, Energy and Industrial, Semiconductor, Test and Measurement
Environmental protection (IP rating)	No IP rating
Minimal temperature	-55°C / +250°C
Climatical Category	50/175/21
Humidity (max)	<=95% [at 60 deg C /140 F]
Shielding (min)	75 dB (10 MHz)
Shielding (min)	40 dB (1 GHz)
Shock Resistance	100 g [ 6 ms]
Vibration	15 g [10 Hz - 2000 Hz]

## Drawings

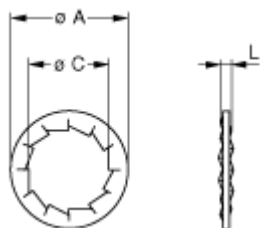

No keying

## Dimensions

	A	C	L
mm.	25	18.1	1.4
in.	0.98	0.71	0.06

[https://www.lemo.com/int\\_en/solutions/originals/s-indoor-stepped-insert/gba-3s-250-fn.html](https://www.lemo.com/int_en/solutions/originals/s-indoor-stepped-insert/gba-3s-250-fn.html)

LEMO products and services are provided "as is". LEMO makes no warranties or representations with regard to LEMO product & services or use of them, express, implied or statutory, including for accuracy, completeness, or security. The user is fully responsible for his products and applications using LEMO components.