

REVISIONS					
P	LTR	DESCRIPTION	DATE	DWN	APVD
A1		REVISED PER ECR-23-193507	04AUG2023	SSM	WH

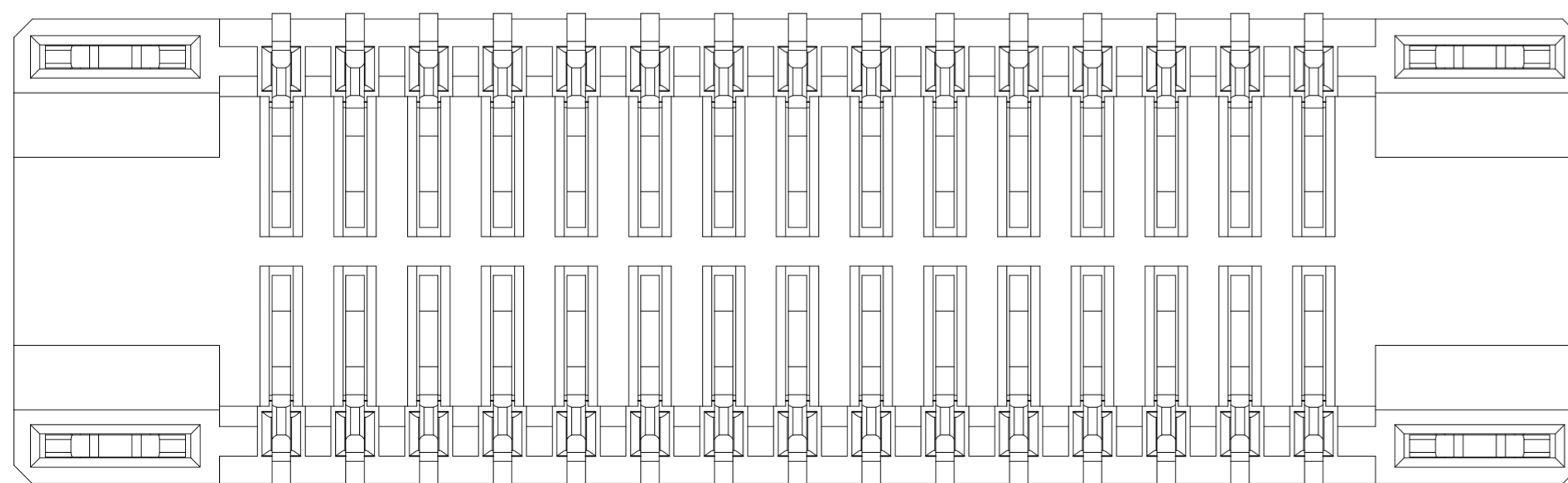
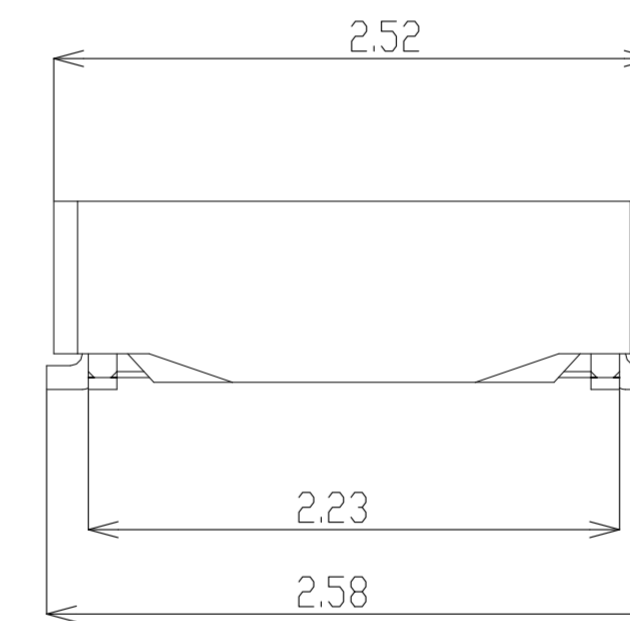
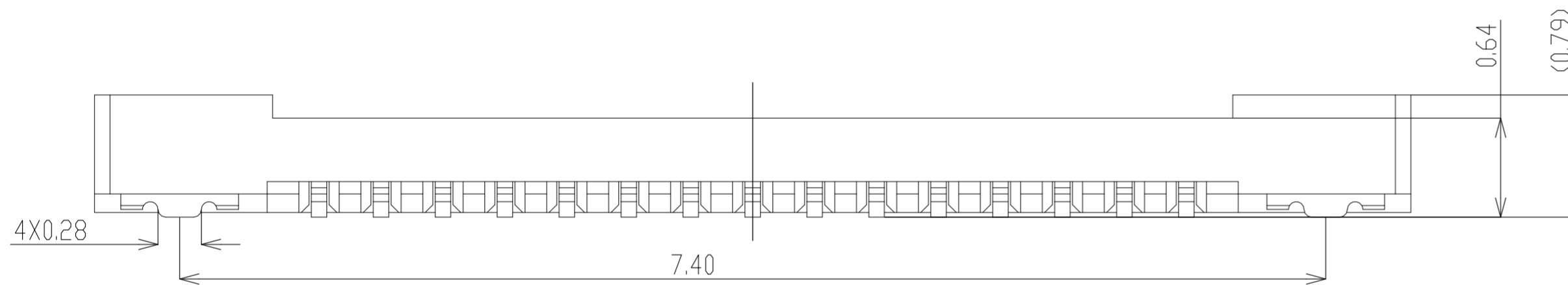
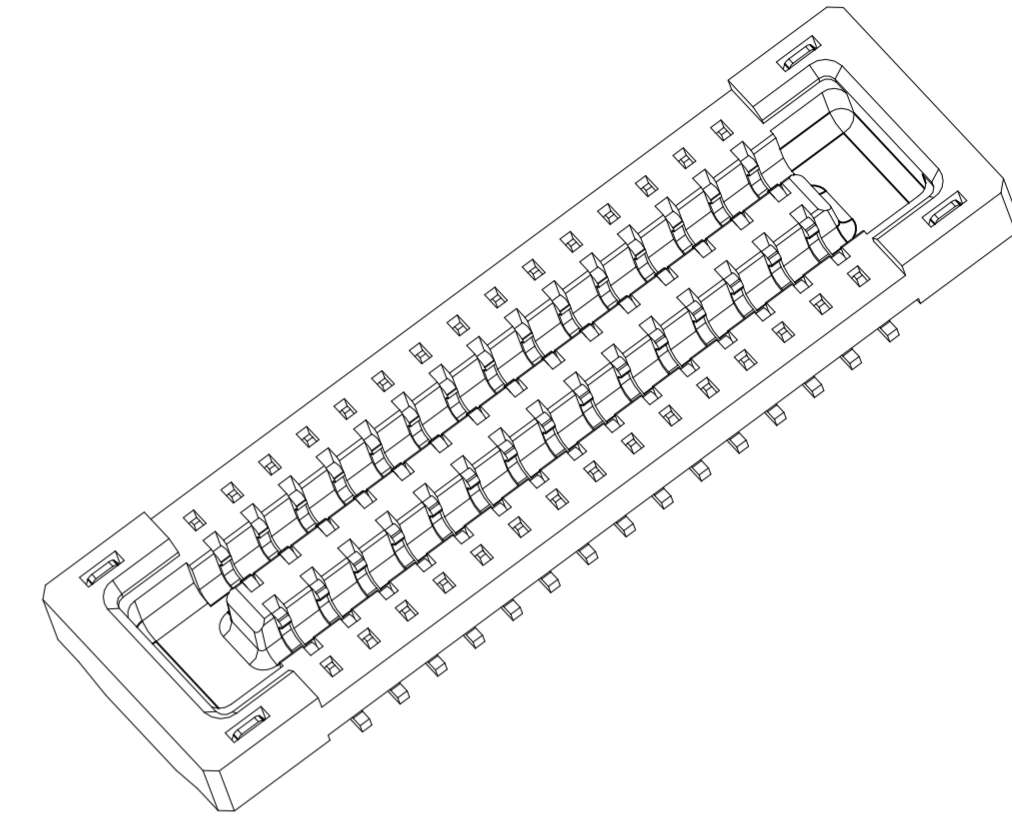
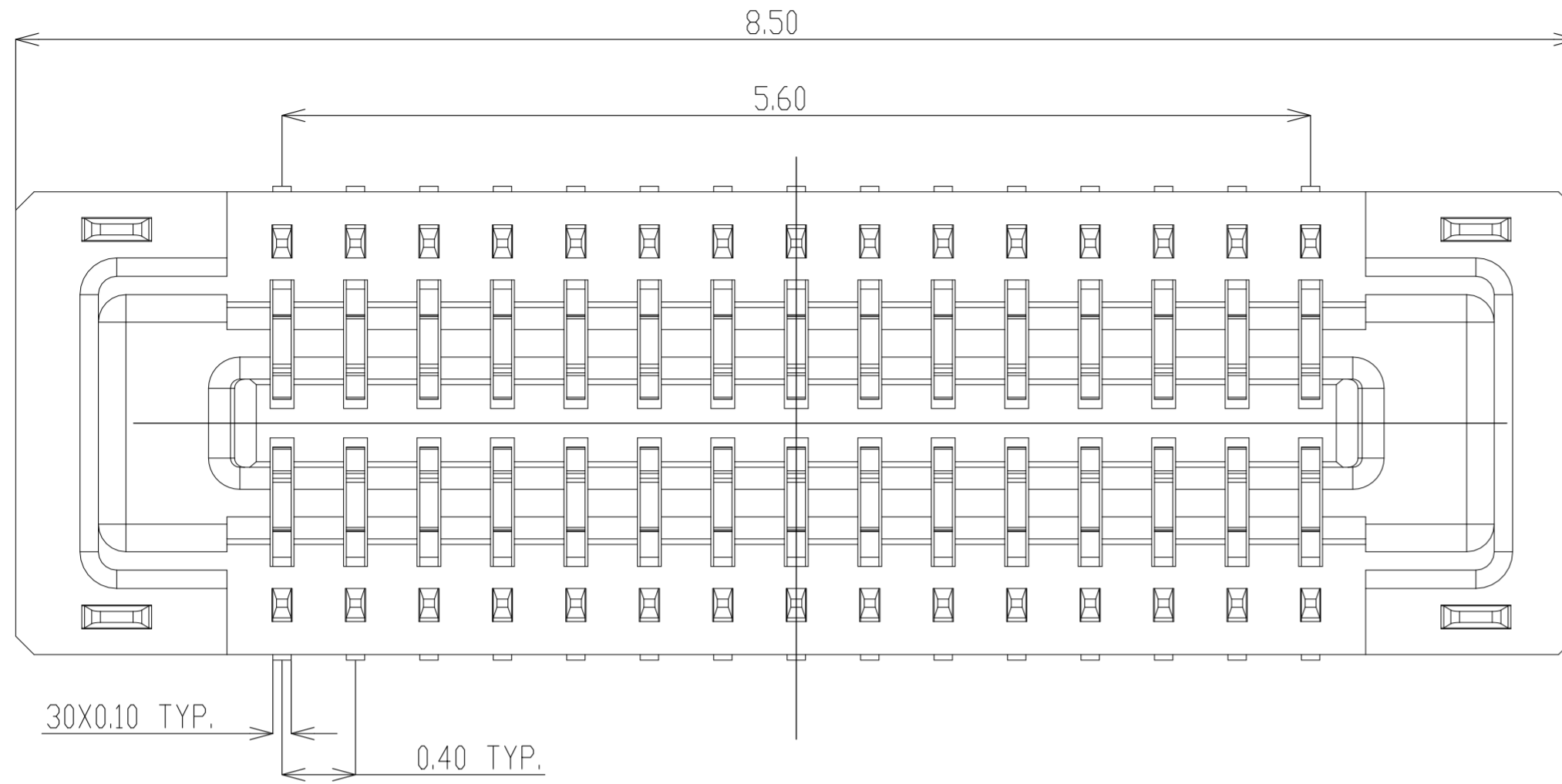

3-2363961-0  
PART NUMBER

THIS DRAWING IS A CONTROLLED DOCUMENT.		DWN H.X 26SEP2019	TE Connectivity Ltd.		
		CHK W.H 26SEP2019			
DIMENSIONS: mm		APVD -	NAME 0.4mm PITCH BTB CONN. HO.8 REC ASSEMBLY		
TOLERANCES UNLESS OTHERWISE SPECIFIED:		PRODUCT SPEC SEE NOTE 5	SIZE A2		
0 PLC ± -		APPLICATION SPEC 114-115040	CAGE CODE 00779	DRAWING NO C=2363961	RESTRICTED TO -
1 PLC ± 0.3		WEIGHT -	SCALE 12:1		
2 PLC ± 0.20		CUSTOMER DRAWING			
3 PLC ± 0.15		SHEET 1 of 9			
4 PLC ± -		REV A1			
ANGLES ± -					
FINISH					

P	LTR	DESCRIPTION	DATE	DWN	APVD
-	-	SEE SHEET 1	-	-	-

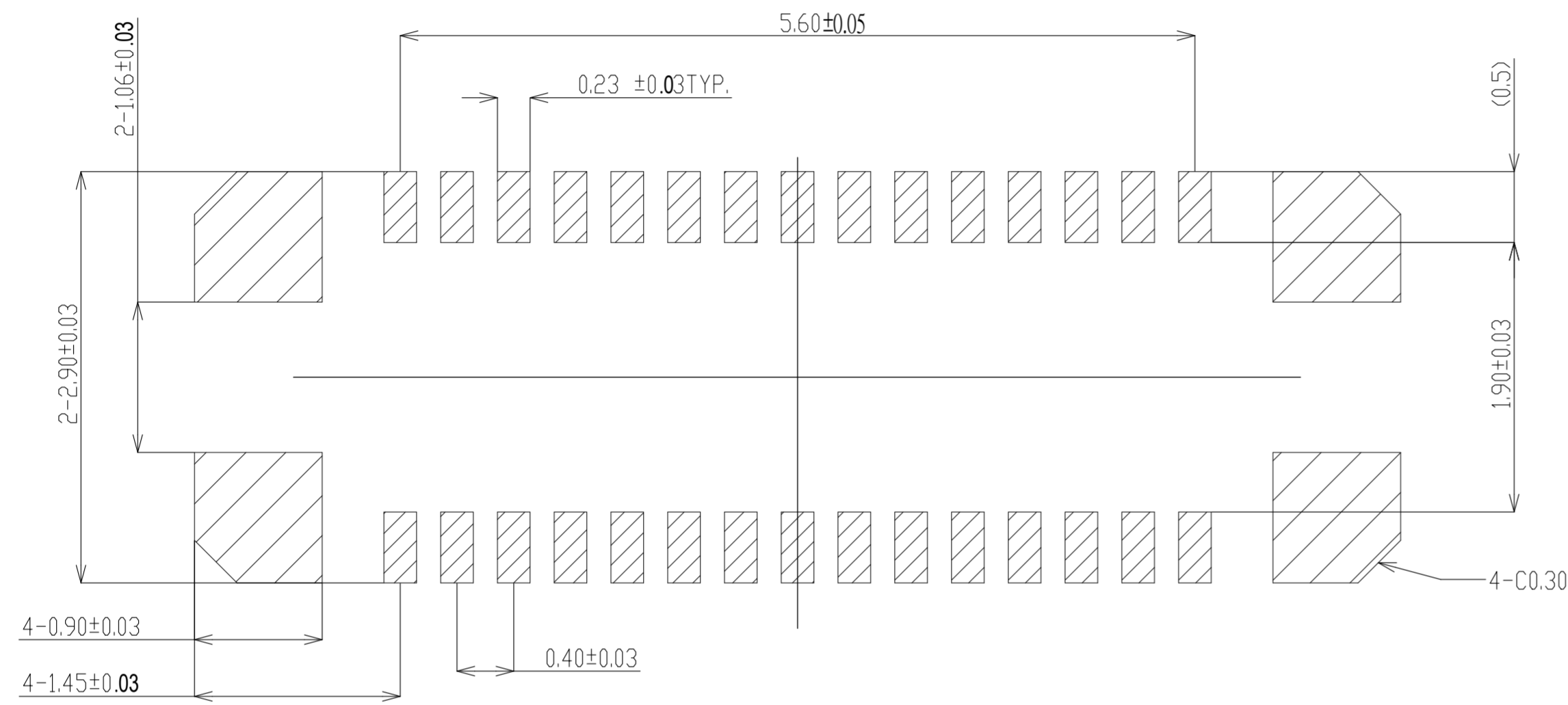

RECOMMENDED P.C.BOARD PATTERN DIMENSION (WITH HOLD DOWN)

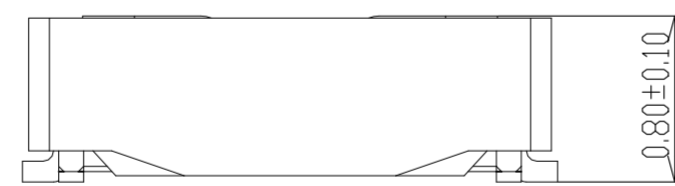

MATING HIGHT

NOTES:

1.MATERIAL:

- 1.1 HOUSING: LCP, UL 94 V-0, COLOR: BLACK.
- 1.2 CONTACT: COPPER ALLOY.
- 1.3 HOLD DOWN: COPPER ALLOY.

2. FINISH:

- 2.1 CONTACT:  
GOLD FLASH ON CONTACT AND SOLDERING AREA.  
NICKEL UNDER PLATING OVERALL.
- 2.2 HOLD DOWN:  
TIN PLATING OVER NICKEL UNDER PLATING.

3.REFLOW SOLDER CAPABLE TO 260 °C.

4.MATING PLUG PART NUMBER:3-2363962-0.

5.PRODUCT SPECIFICATION 108-115166

THIS DRAWING IS A CONTROLLED DOCUMENT.		DWN	26SEP2019	<b>TE</b> TE Connectivity Ltd.	
		CHK	26SEP2019		
DIMENSIONS: mm		TOLERANCES UNLESS OTHERWISE SPECIFIED		NAME	
		0 PLC	±	0.4mm PITCH BTB CONN.	
		1 PLC	± 0.3	H0.8 REC ASSEMBLY	
		2 PLC	± 0.20	-	
		3 PLC	± -	-	
MATERIAL		FINISH		SIZE	CAGE CODE
-		-	-	A2	00779
		APVD		DRAWING NO	
		-		114-115040	
		PRODUCT SPEC		SCALE	
		SEE NOTE 5		12:1	
		APPLICATION SPEC		SHEET	
		114-115040		2 of 9	
		WEIGHT		REV	
		-		A1	
		CUSTOMER DRAWING		RESTRICTED TO	
				-	

REVISIONS					
P	LTR	DESCRIPTION	DATE	DWN	APVD
-	-	SEE SHEET 1	-	-	-

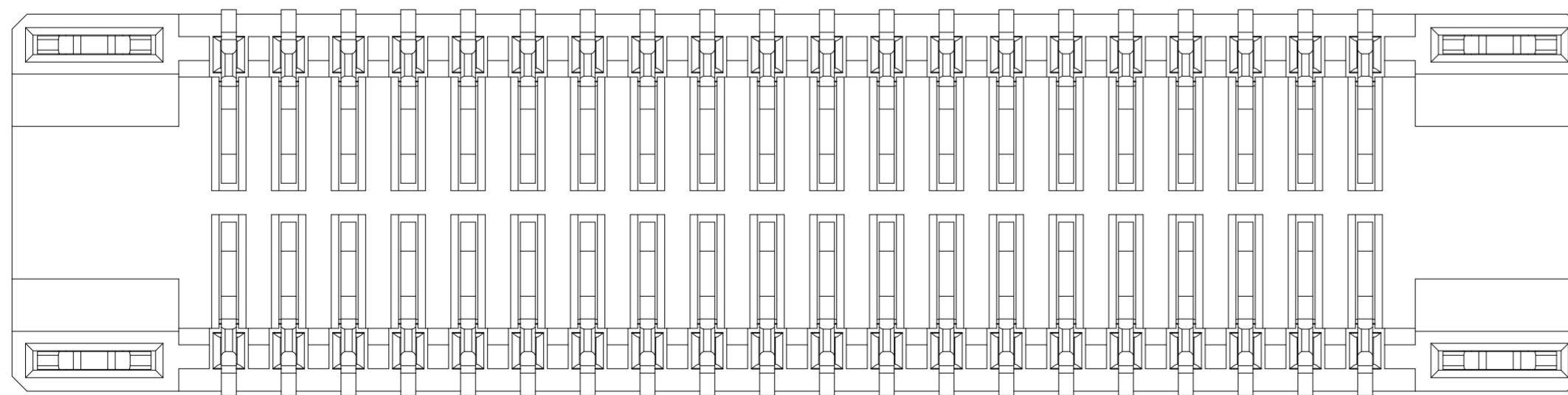
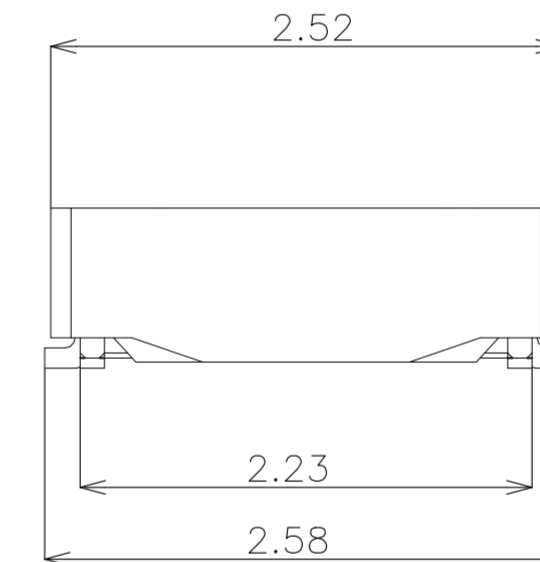
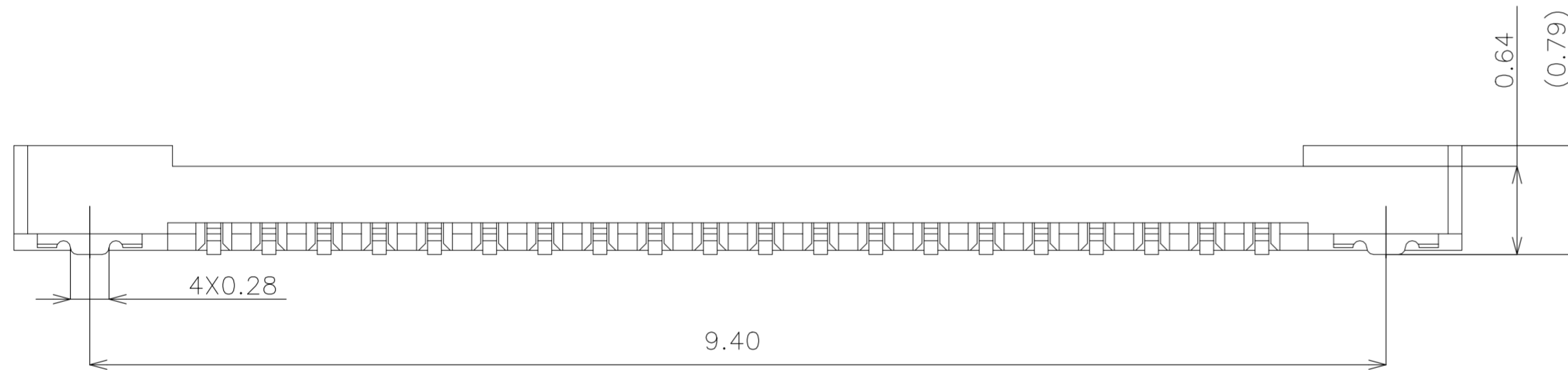
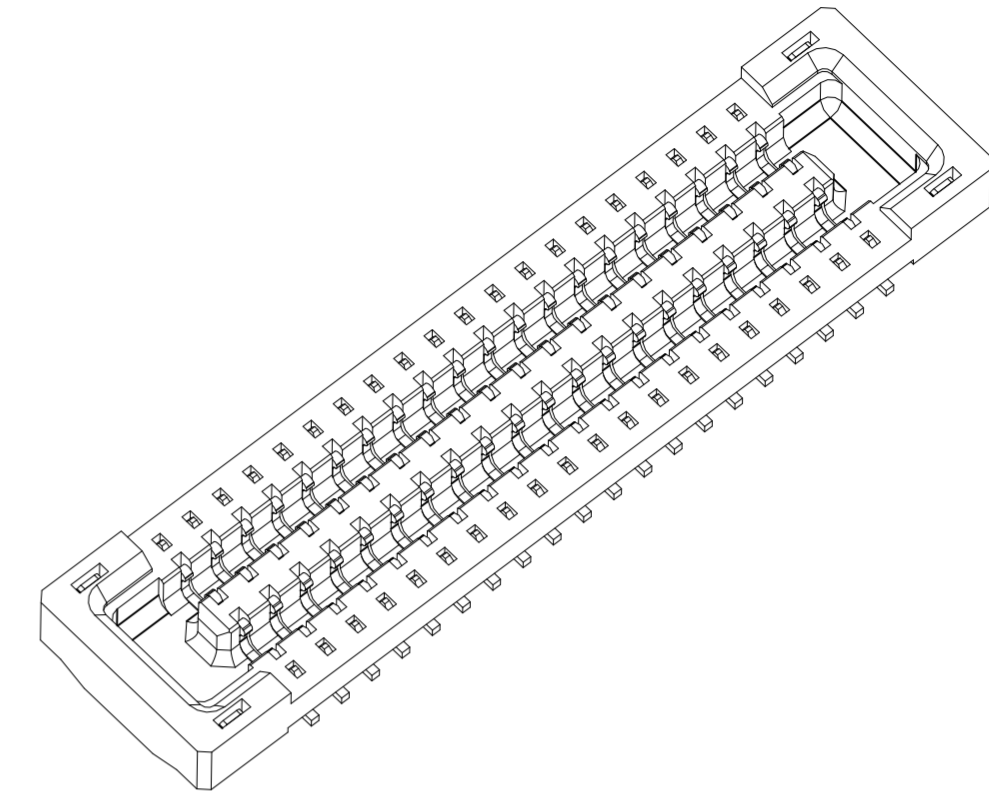
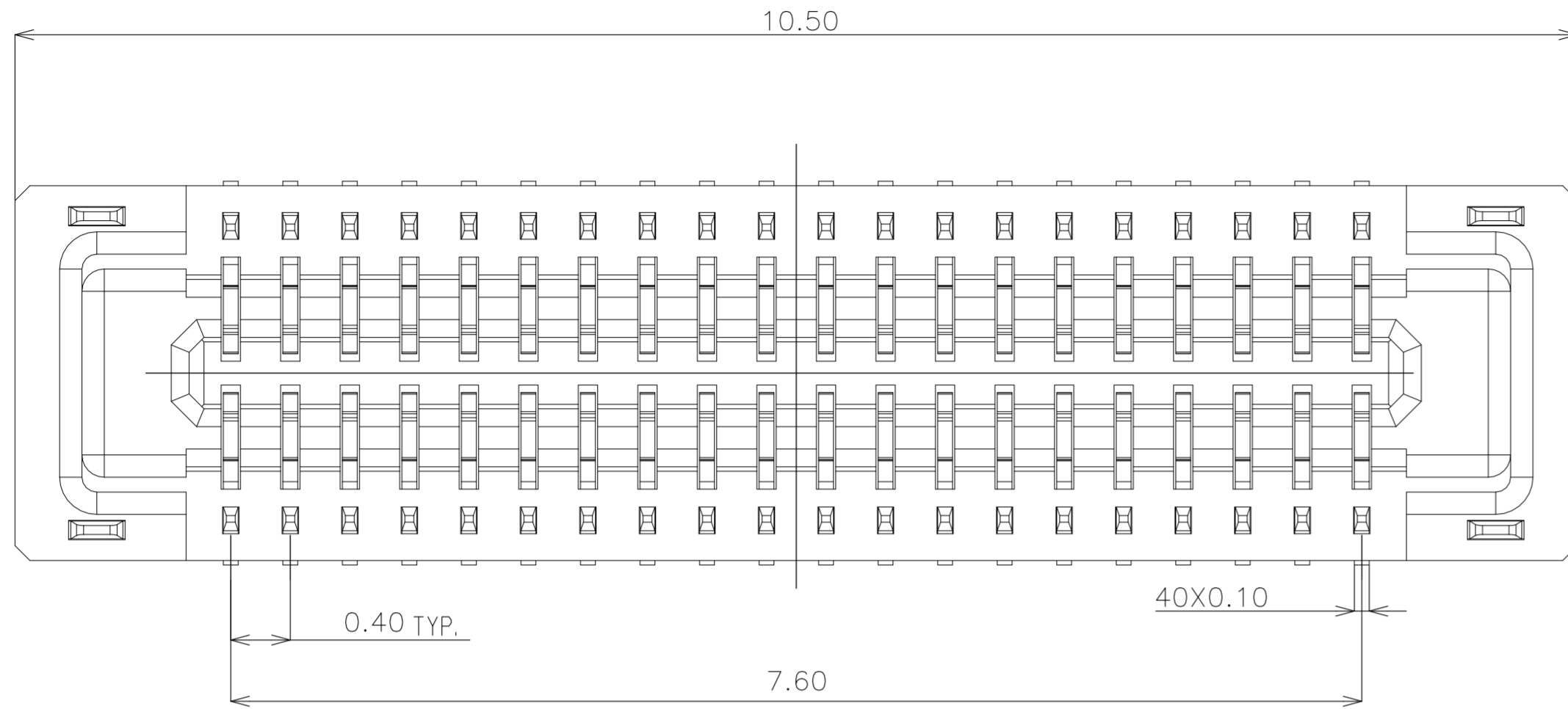

4-2363961-0  
PART NUMBER

THIS DRAWING IS A CONTROLLED DOCUMENT.		DWN H.X 26SEP2019	TE Connectivity Ltd.		
DIMENSIONS: mm		CHK W.H 26SEP2019	0.4mm PITCH BTB CONN. H0.8 REC ASSEMBLY		
TOLERANCES UNLESS OTHERWISE SPECIFIED: 0 PLC ± - 1 PLC ± 0.3 2 PLC ± 0.20 3 PLC ± 0.15 4 PLC ± - ANGLES ± -		APVD -	NAME		
MATERIAL -		FINISH -	PRODUCT SPEC SEE NOTE 5		
		WEIGHT 0	SIZE A2	CAGE CODE 00779	DRAWING NO C=2363961
		CUSTOMER DRAWING		SCALE 12:1	SHEET 3 of 9
				RESTRICTED TO -	REV A1

2363961

P	LTR	DESCRIPTION	DATE	DWN	APVD
-	-	SEE SHEET 1	-	-	-

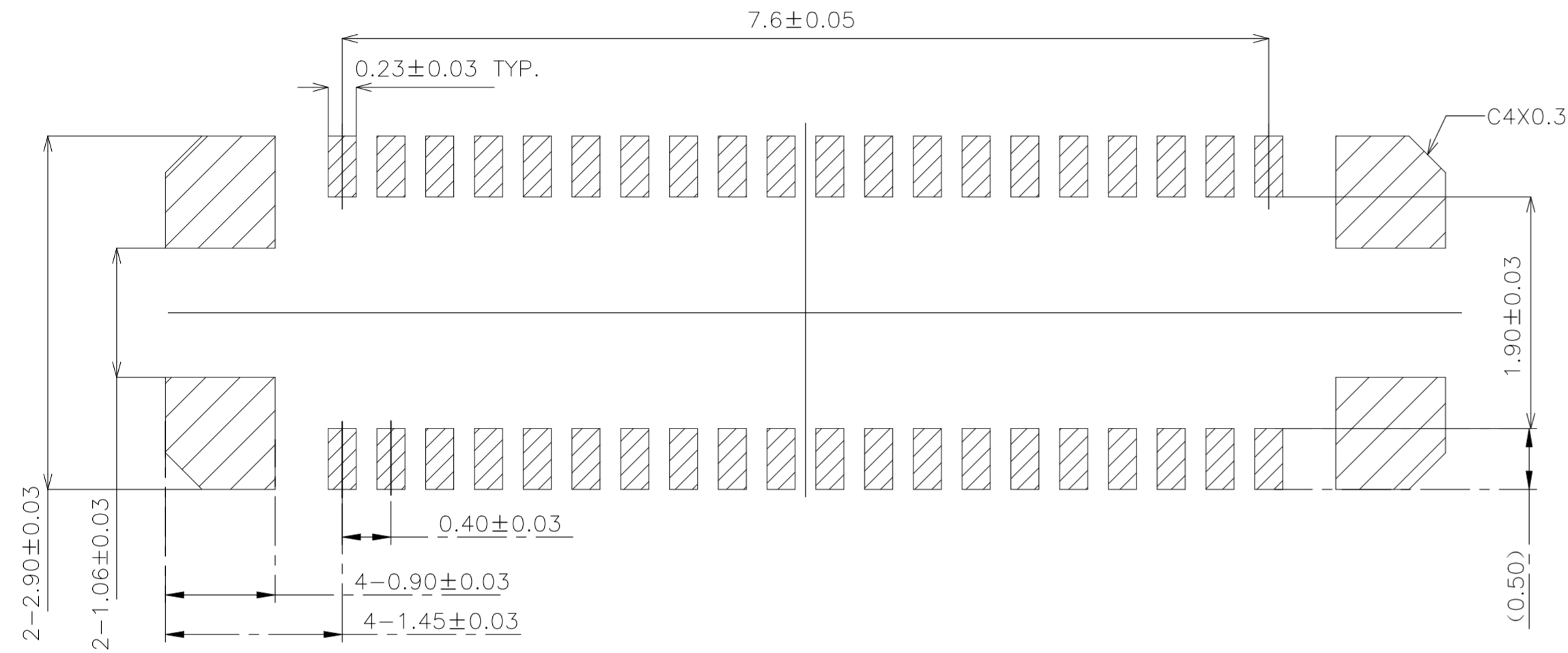

- NOTES:
- MATERIAL:
    - HOUSING: LCP, UL 94 V-0, COLOR: BLACK.
    - CONTACT: COPPER ALLOY.
    - HOLD DOWN: COPPER ALLOY.
  - FINISH:
    - CONTACT: GOLD FLASH ON CONTACT AND SOLDERING AREA. NICKEL UNDER PLATING OVERALL.
    - HOLD DOWN: TIN PLATING OVER NICKEL UNDER PLATING.
  - REFLOW SOLDER CAPABLE TO 260 °C.
  - MATING PLUG PART NUMBER: 4-2363962-0.
  - PRODUCT SPECIFICATION 108-115166

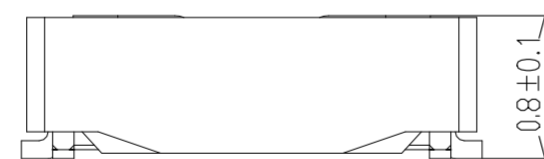

MATING HIGHT

THIS DRAWING IS A CONTROLLED DOCUMENT.		DWN H.X	26SEP2019	TE Connectivity Ltd.			
		CHK W.H	26SEP2019				
		APVD -	-	NAME			
DIMENSIONS: mm		TOLERANCES UNLESS OTHERWISE SPECIFIED		PRODUCT SPEC			
		0 PLC	±	SEE NOTE 5			
		1 PLC	± 0.3	APPLICATION SPEC			
		2 PLC	± 0.20	114-115040			
		3 PLC	± -	SIZE	CAGE CODE	DRAWING NO	RESTRICTED TO
		4 PLC	± -	A2	00779	C=2363961	-
MATERIAL		FINISH		WEIGHT	SCALE		
-		-		-	12:1		
CUSTOMER DRAWING				SHEET	REV		
				4 of 9	A1		

P	LTR	DESCRIPTION	DATE	DWN	APVD
-	-	SEE SHEET 1	-	-	-

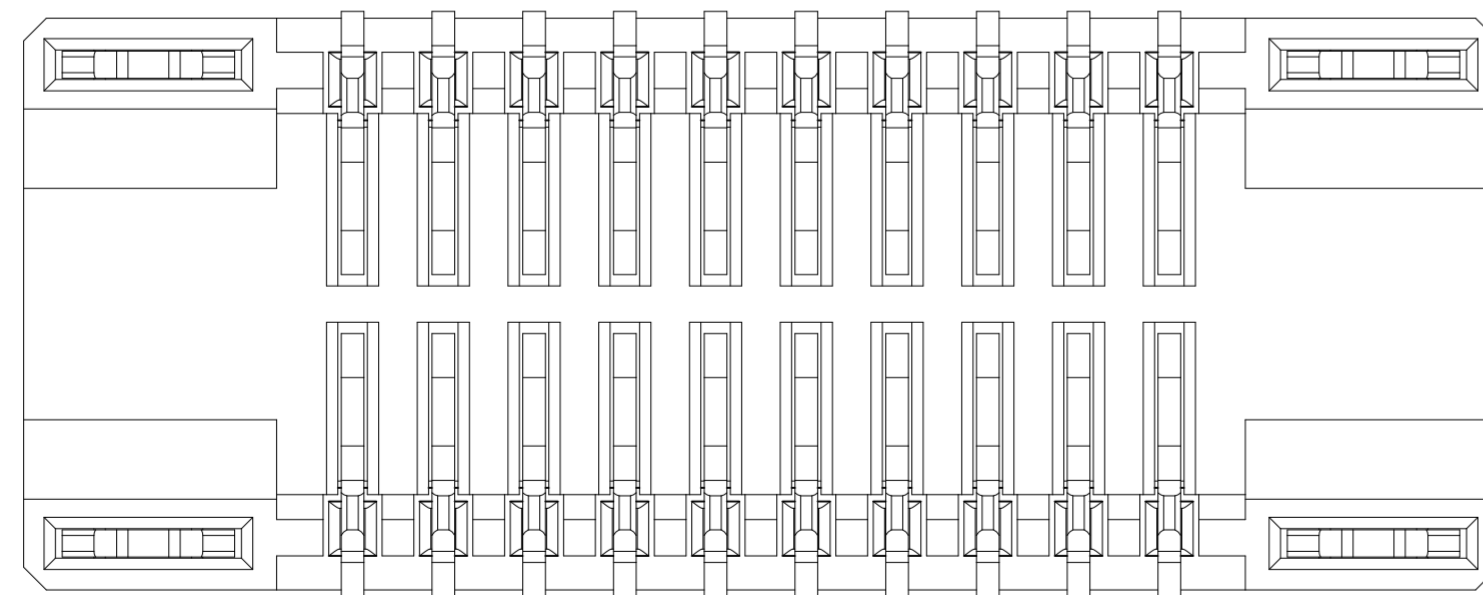
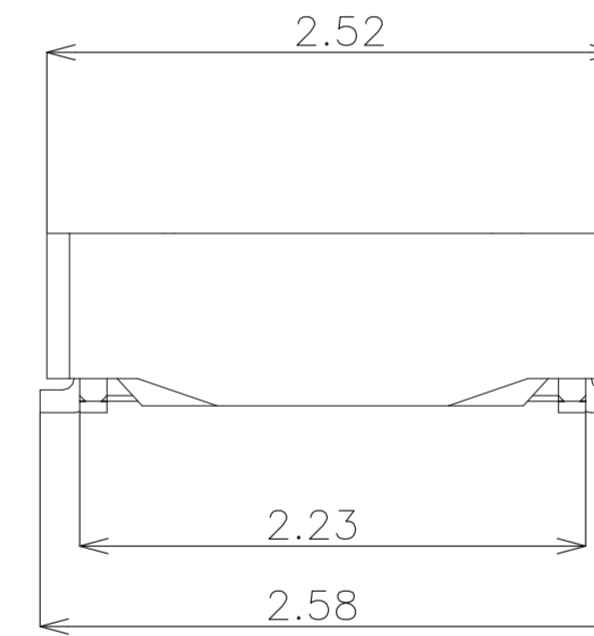
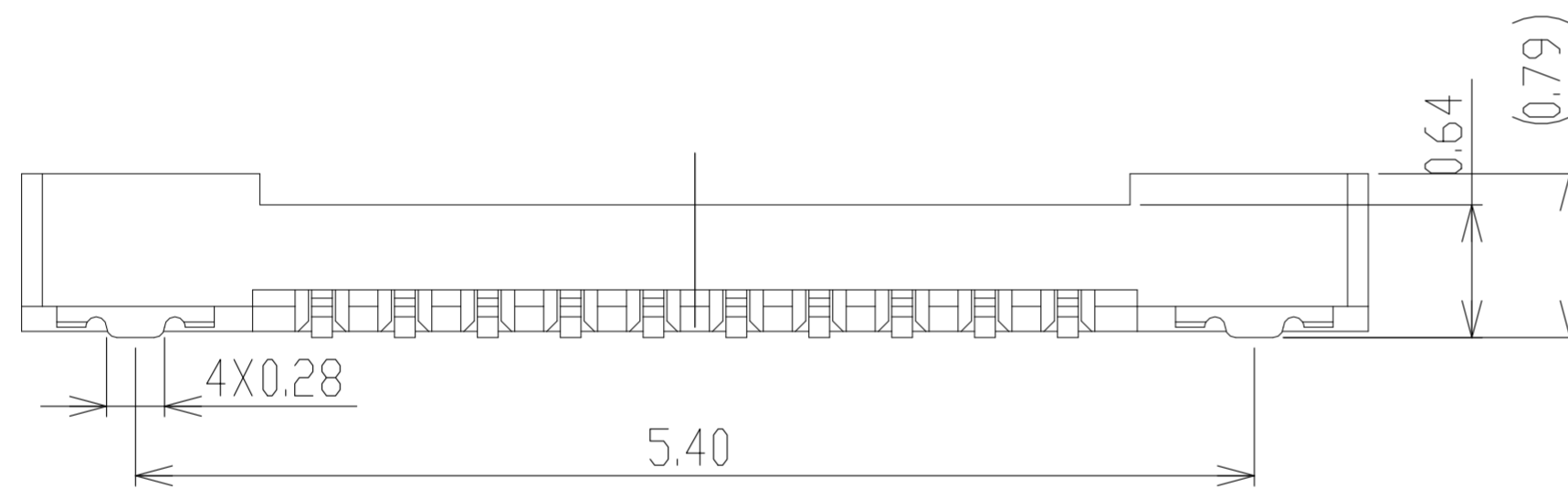
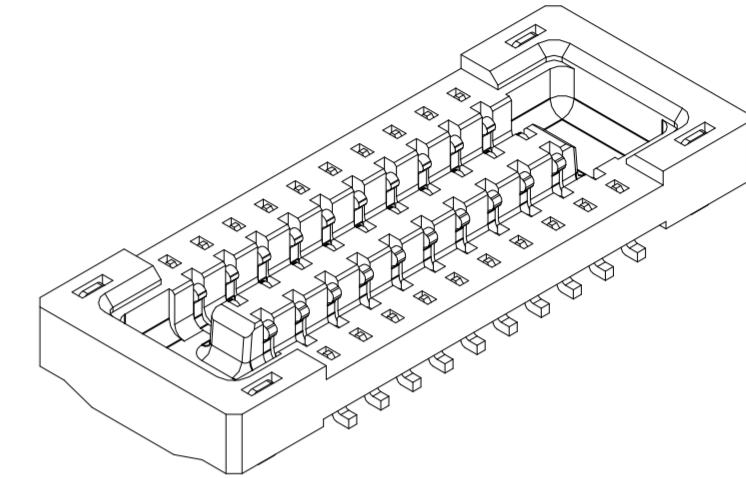
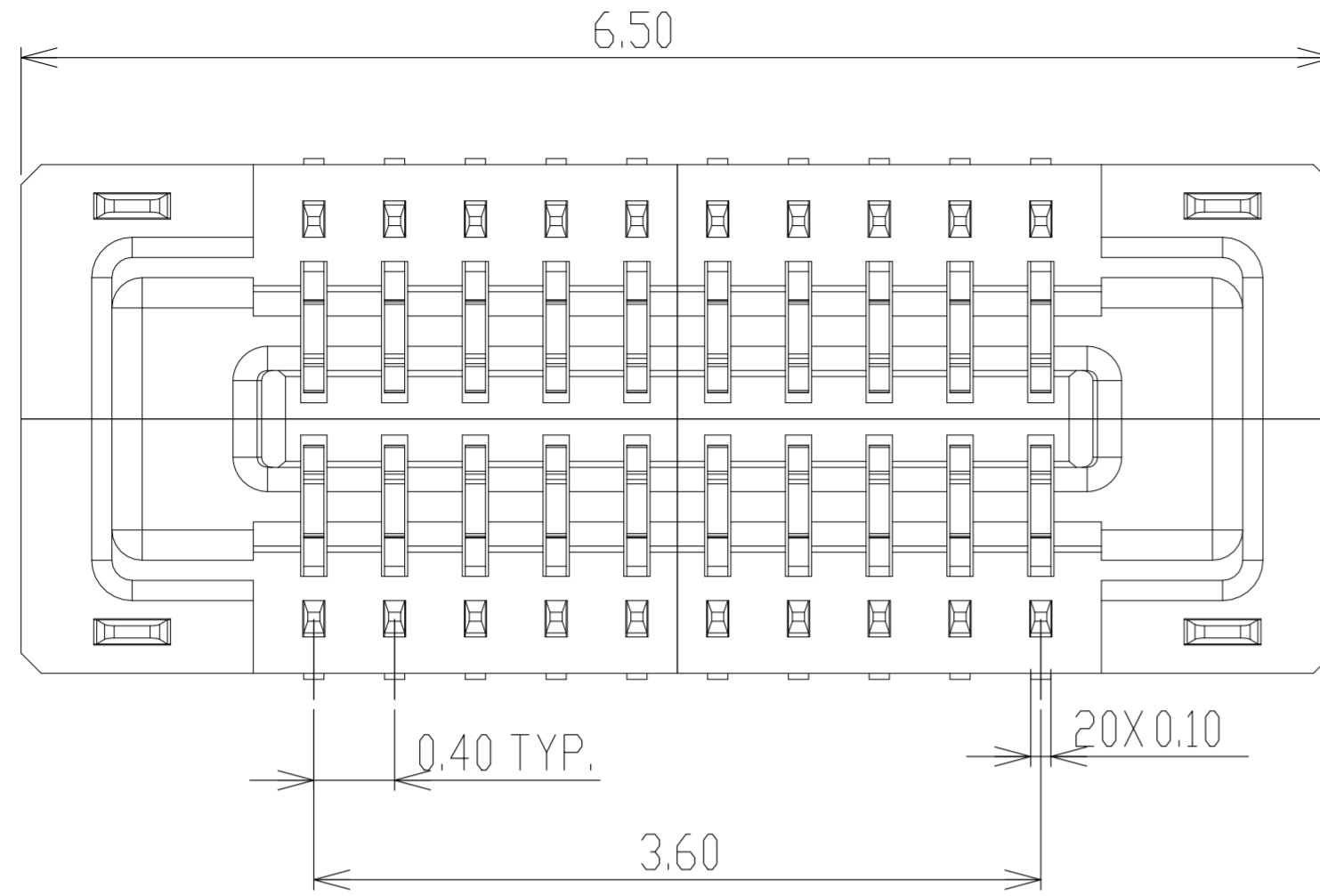

2-2363961-0  
PART NUMBER

THIS DRAWING IS A CONTROLLED DOCUMENT.		DWN H.X 26SEP2019	TE Connectivity Ltd.	
DIMENSIONS: mm		CHK W.H 26SEP2019	0.4mm PITCH BTB CONN. H0.8 REC ASSEMBLY	
TOLERANCES UNLESS OTHERWISE SPECIFIED:		APVD -	NAME	
0 PLC ± -		PRODUCT SPEC	114-115040	
1 PLC ± 0.3		APPLICATION SPEC	SEE NOTE 5	
2 PLC ± 0.20		SIZE	CAGE CODE	DRAWING NO
3 PLC ± -		A2	00779	C=2363961
4 PLC ± -		WEIGHT	-	
ANGLES ± -		CUSTOMER DRAWING		
FINISH		SCALE 12:1		SHEET 5 of 9
-		REV A1		RESTRICTED TO

REVISIONS					
P	LTR	DESCRIPTION	DATE	DWN	APVD
-	-	SEE SHEET 1	-	-	-

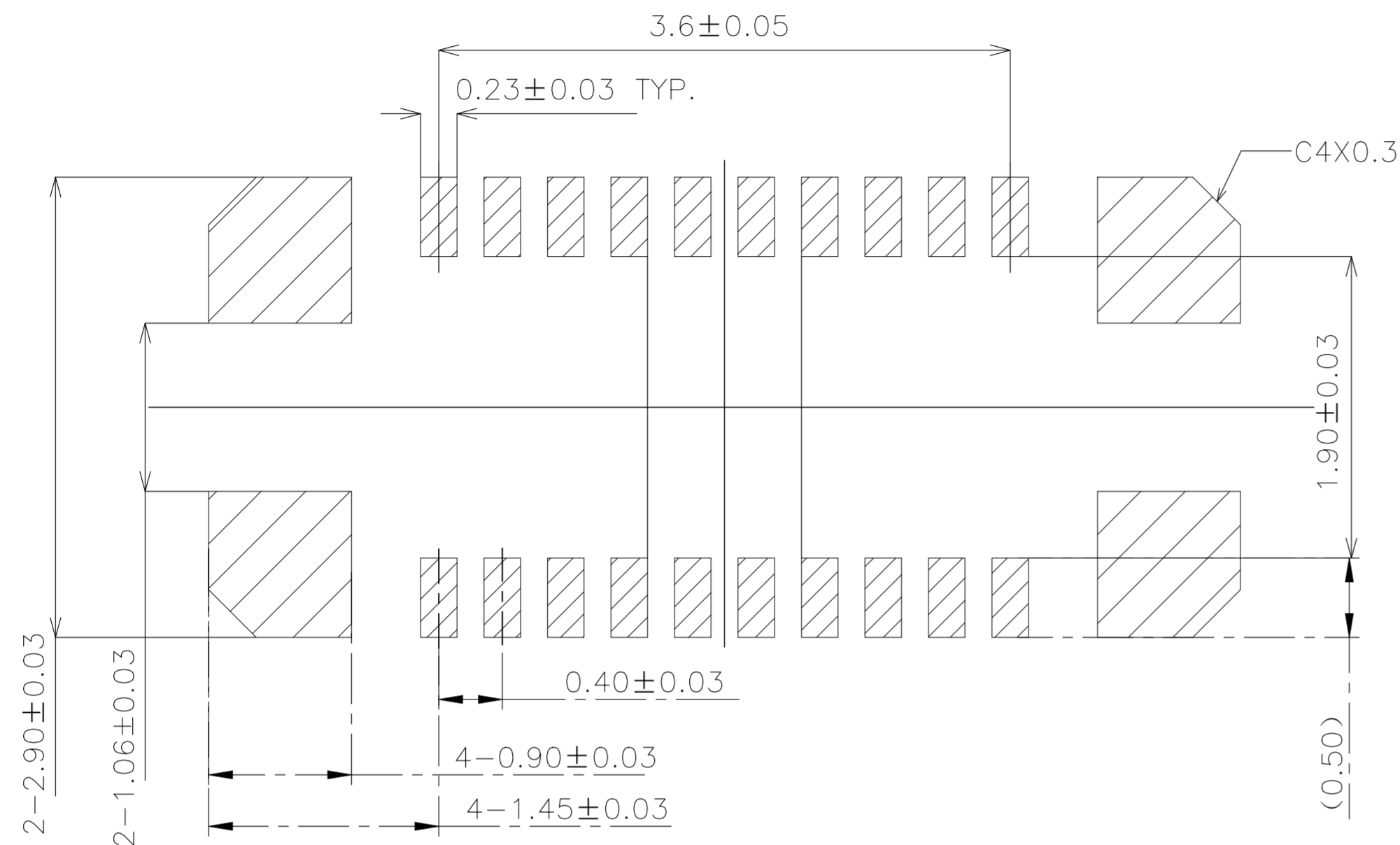

RECOMMENDED P.C.BOARD PATTERN DIMENSION (WITH HOLD DOWN)



MATING HIGHT

NOTES:

1.MATERIAL:

- 1.1 HOUSING: LCP, UL 94 V-0, COLOR: BLACK.
- 1.2 CONTACT: COPPER ALLOY.
- 1.3 HOLD DOWN: COPPER ALLOY.

2. FINISH:

- 2.1 CONTACT:  
GOLD FLASH ON CONTACT AND SOLDERING AREA.  
NICKEL UNDER PLATING OVERALL.
- 2.2 HOLD DOWN:  
TIN PLATING OVER NICKEL UNDER PLATING.

3. REFLOW SOLDER CAPABLE TO 260 °C.

4. MATING PLUG PART NUMBER: 2-2363962-0.

5. PRODUCT SPECIFICATION 108-161052

THIS DRAWING IS A CONTROLLED DOCUMENT.		DWN H.X	26SEP2019	TE Connectivity Ltd.	
		CHK W.H	26SEP2019		
		APVD -	-	NAME	
DIMENSIONS: mm		TOLERANCES UNLESS OTHERWISE SPECIFIED:		PRODUCT SPEC	
		0 PLC	± -	SEE NOTE 5	
		1 PLC	± 0.3	APPLICATION SPEC	
		2 PLC	± 0.20	114-115040	
		3 PLC	± -	SIZE CAGE CODE DRAWING NO	
MATERIAL		FINISH		RESTRICTED TO	
				A2 00779 C=2363961	
		CUSTOMER DRAWING		SCALE 12:1	SHEET 6 of 9 REV A1

P	LTR	DESCRIPTION	DATE	DWN	APVD
-	-	SEE SHEET 1	-	-	-

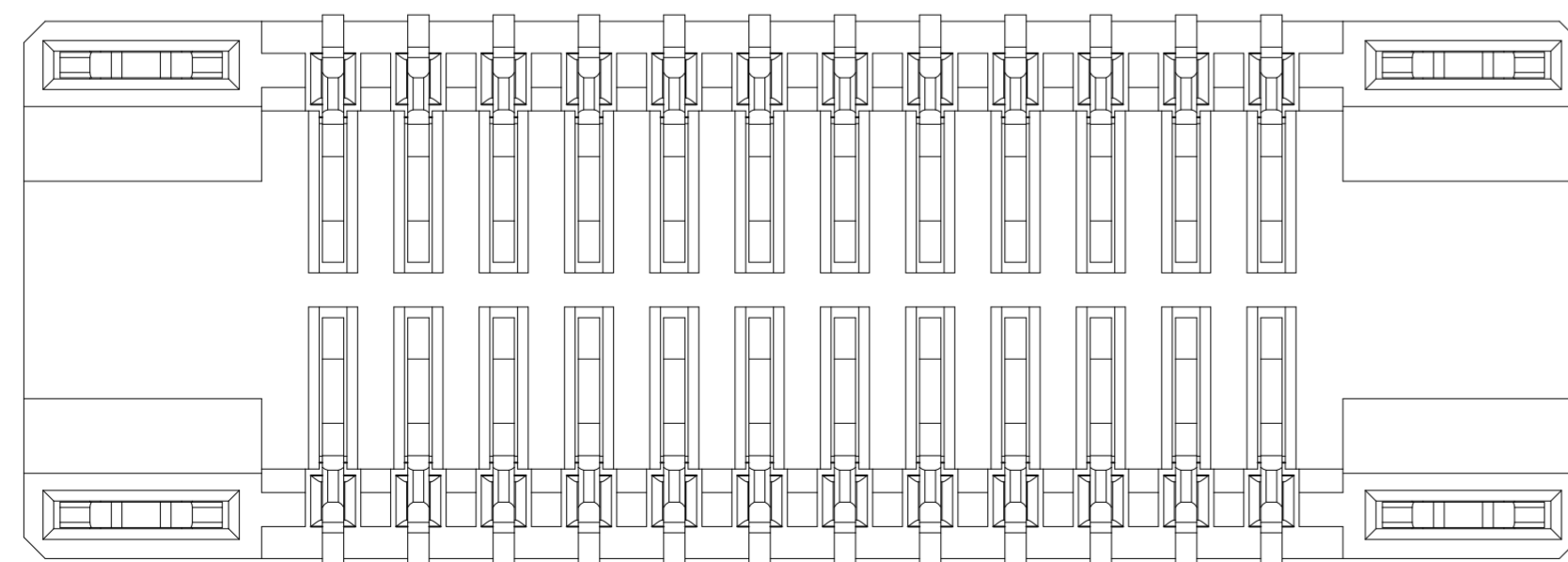
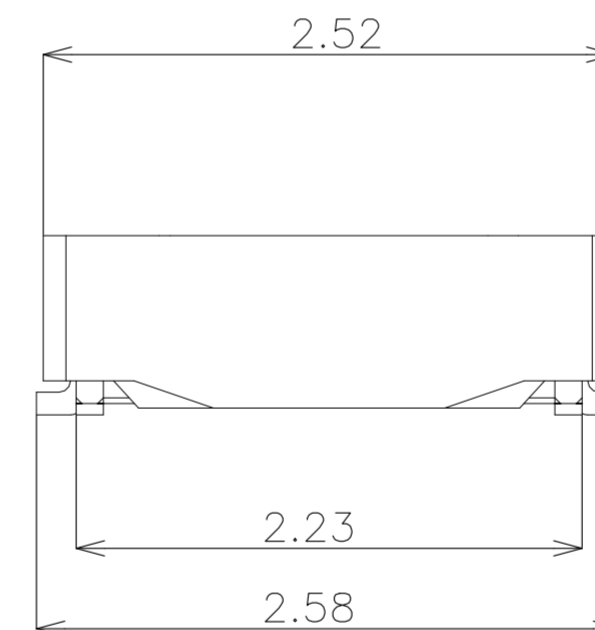
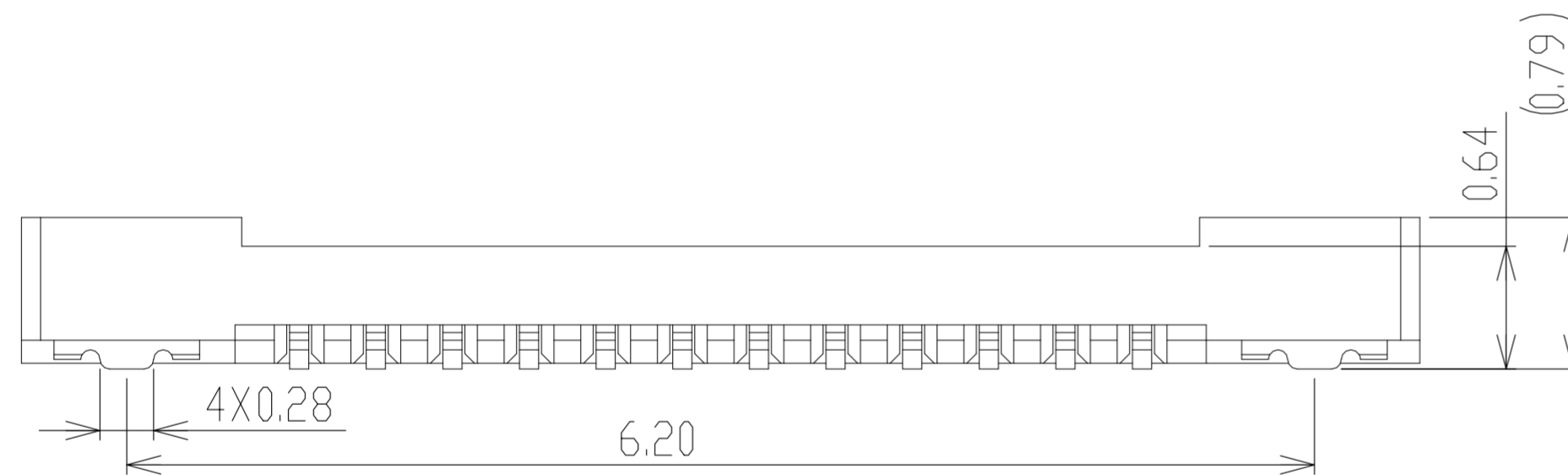
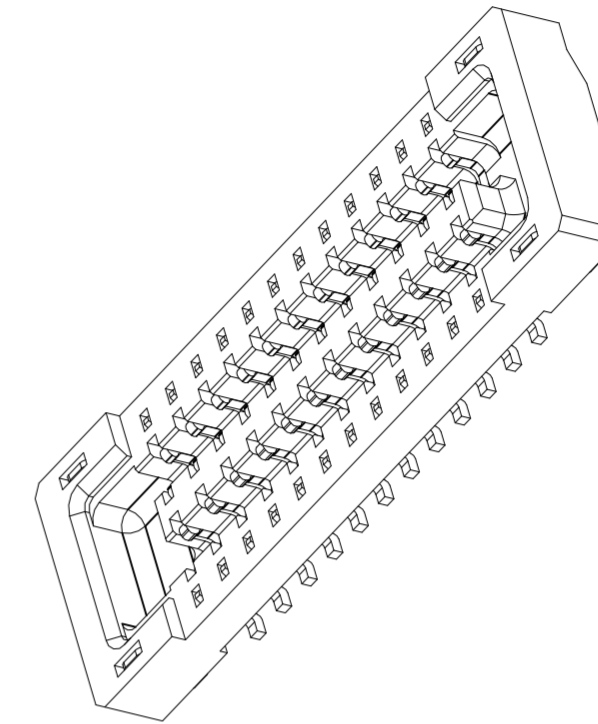
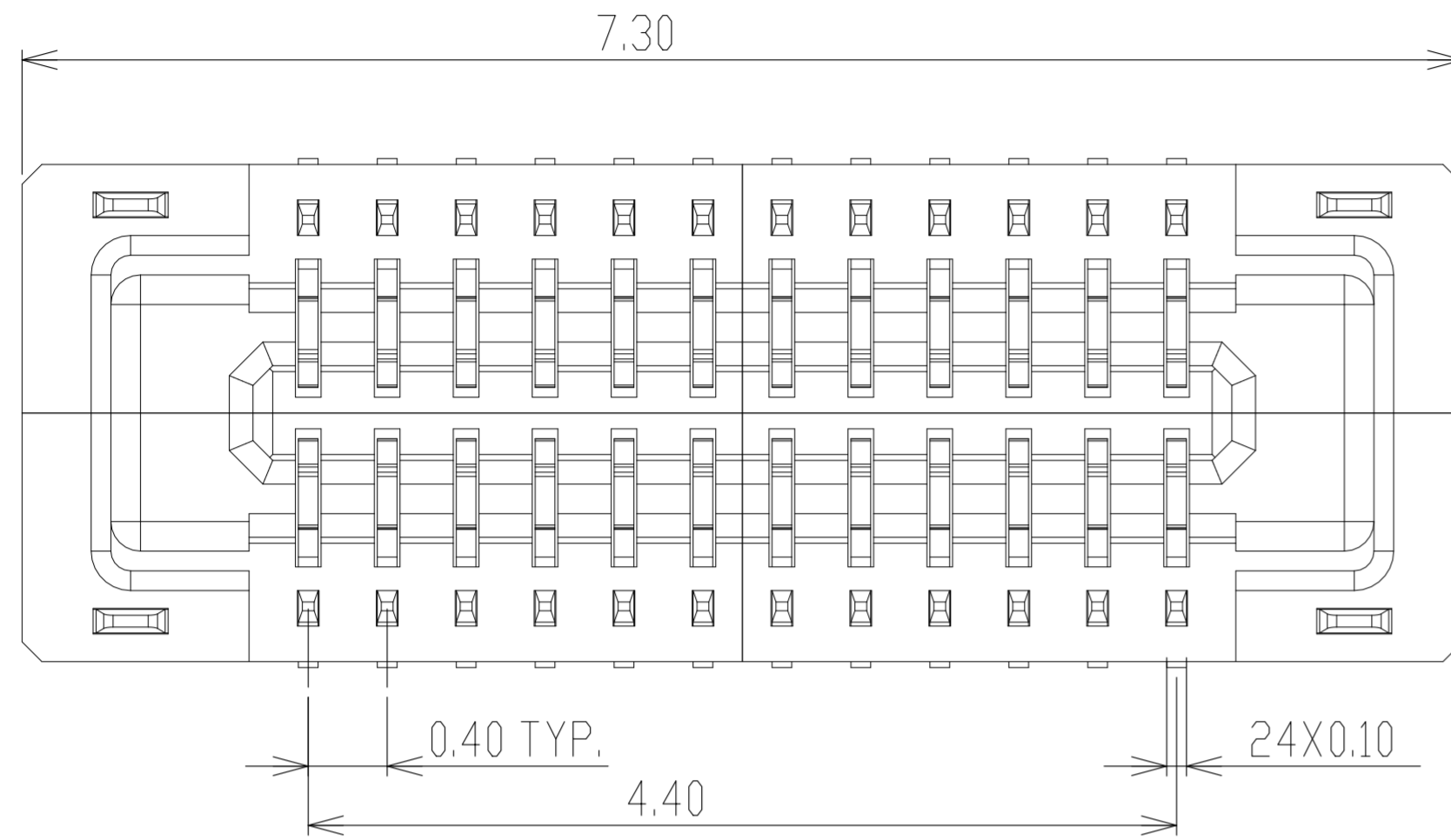

2-2363961-4  
PART NUMBER

THIS DRAWING IS A CONTROLLED DOCUMENT.		DWN H.X 26SEP2019	TE Connectivity Ltd.		
DIMENSIONS: mm		CHK W.H 26SEP2019			
TOLERANCES UNLESS OTHERWISE SPECIFIED: 0 PLC ± - 1 PLC ± 0.3 2 PLC ± 0.20 3 PLC ± - 4 PLC ± - ANGLES ± -		APVD -	NAME 0.4mm PITCH BTB CONN. H0.8 REC ASSEMBLY		
		PRODUCT SPEC SEE NOTE 5	SIZE A2	CAGE CODE 00779	DRAWING NO C=2363961
MATERIAL -		FINISH -	WEIGHT -	RESTRICTED TO -	SCALE 12:1
CUSTOMER DRAWING			SHEET 7 of 9	REV A1	

2363961

REVISIONS					
P	LTR	DESCRIPTION	DATE	DWN	APVD
-	-	SEE SHEET 1	-	-	-

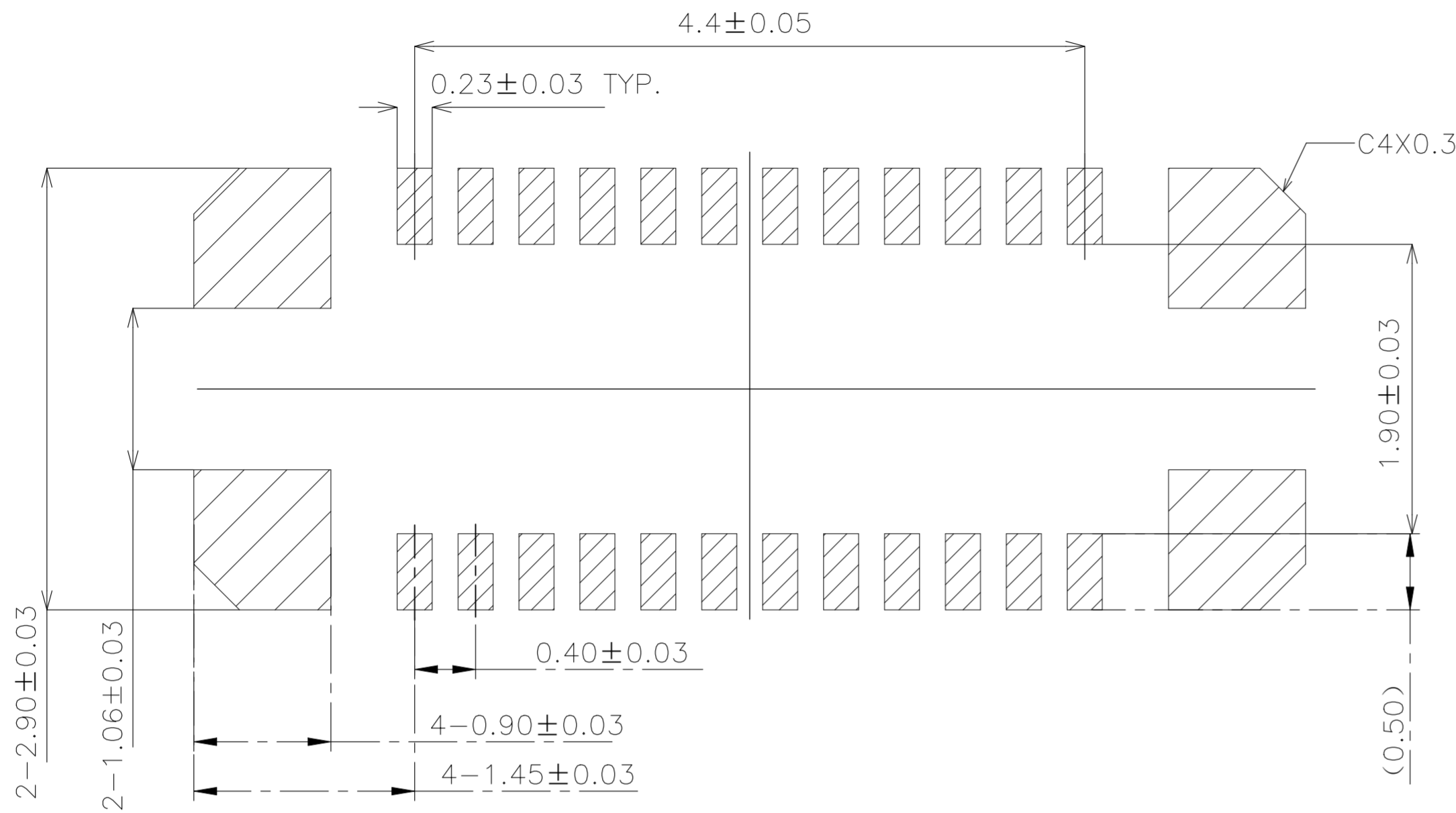

RECOMMENDED P.C.BOARD PATTERN DIMENSION (WITH HOLD DOWN)

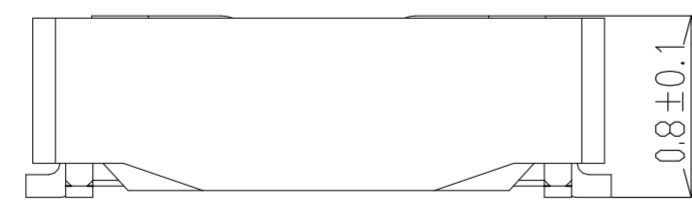

MATING HIGHT

NOTES:

1.MATERIAL:

- 1.1 HOUSING: LCP, UL 94 V-0, COLOR: BLACK.
- 1.2 CONTACT: COPPER ALLOY.
- 1.3 HOLD DOWN: COPPER ALLOY.

2. FINISH:

- 2.1 CONTACT:  
GOLD FLASH ON CONTACT AND SOLDERING AREA.  
NICKEL UNDER PLATING OVERALL.
- 2.2 HOLD DOWN:  
TIN PLATING OVER NICKEL UNDER PLATING.

3. REFLOW SOLDER CAPABLE TO 260 °C.

4. MATING PLUG PART NUMBER: 2-2363962-0.

5. PRODUCT SPECIFICATION 108-161052

THIS DRAWING IS A CONTROLLED DOCUMENT.		DWN	26SEP2019		TE Connectivity Ltd.
		CHK	26SEP2019		
		APVD	-		NAME
		PRODUCT SPEC	114-115040		0.4mm PITCH BTB CONN. H0.8 REC ASSEMBLY
		APPLICATION SPEC	SEE NOTE 5		RESTRICTED TO
		MATERIAL	-		SIZE
		FINISH	-		CAGE CODE
		WEIGHT	-		DRAWING NO
		CUSTOMER DRAWING	SCALE 12:1		REV A1
			SHEET 8 of 9		

2363961



REVISIONS					
P	LTR	DESCRIPTION	DATE	DWN	APVD
-	-	SEE SHEET 1	-	-	-

- NOTES :
- PACKAGING MATERIAL IN PLASTIC, RUBBER, INK, PIGMENT AND PAINT MUST MEET CONTROLLED SUBSTANCES SPEC PER 230-702.
  - \* CADMIUM AND CADMIUM COMPOUNDS NOT TO EXCEED: 5 PPM.
  - \* LEAD, CADMIUM, CHROM VI AND MERCURY NOT TO EXCEED: 100 PPM (COMBINED).
  - \* CARRIER TAPES, COVER TAPES, REELS AND TAPED COMPONENTS MUST MEET THE REQUIREMENTS DEFINED PER EIA-481-C.
- MATERIAL :  
COVER TAPE : PET, COLOR: TRANSPARENT.  
CARRIER TAPE : POLYSTYRENES, BLACK COLOR.  
REEL : POLYSTYRENES, BLUE COLOR.  
SHIPPING BOX: CORRUGATED FIBER
  - DIMENSION :  
REEL : SEE DRAWING  
SHIPPING BOX : SEE DRAWING
  - QUANTITY : SEE TABLE
  - WEIGHT : SEE TABLE
  - PEELING RESISTANCE : 10gf~130gf
  - PEELING SPEED : 300mm/MINUTES

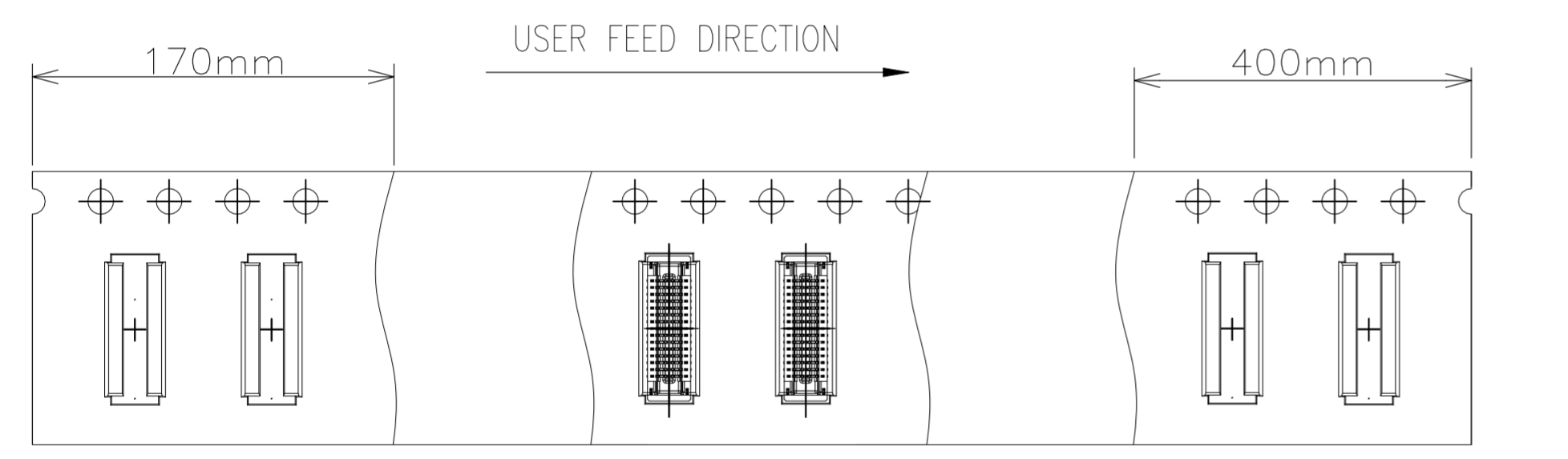
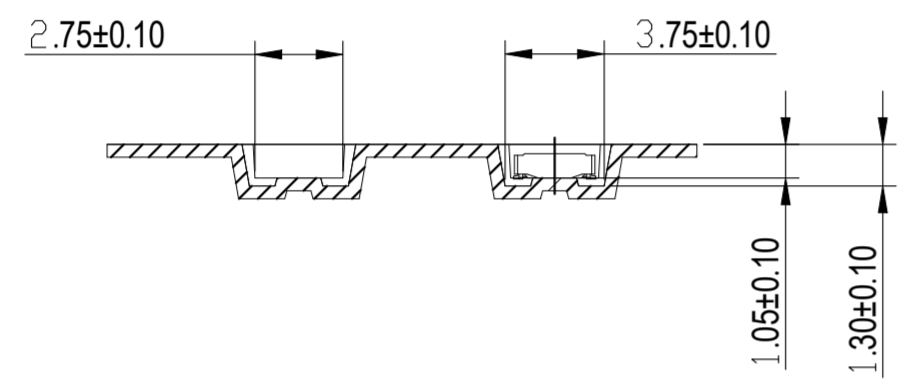
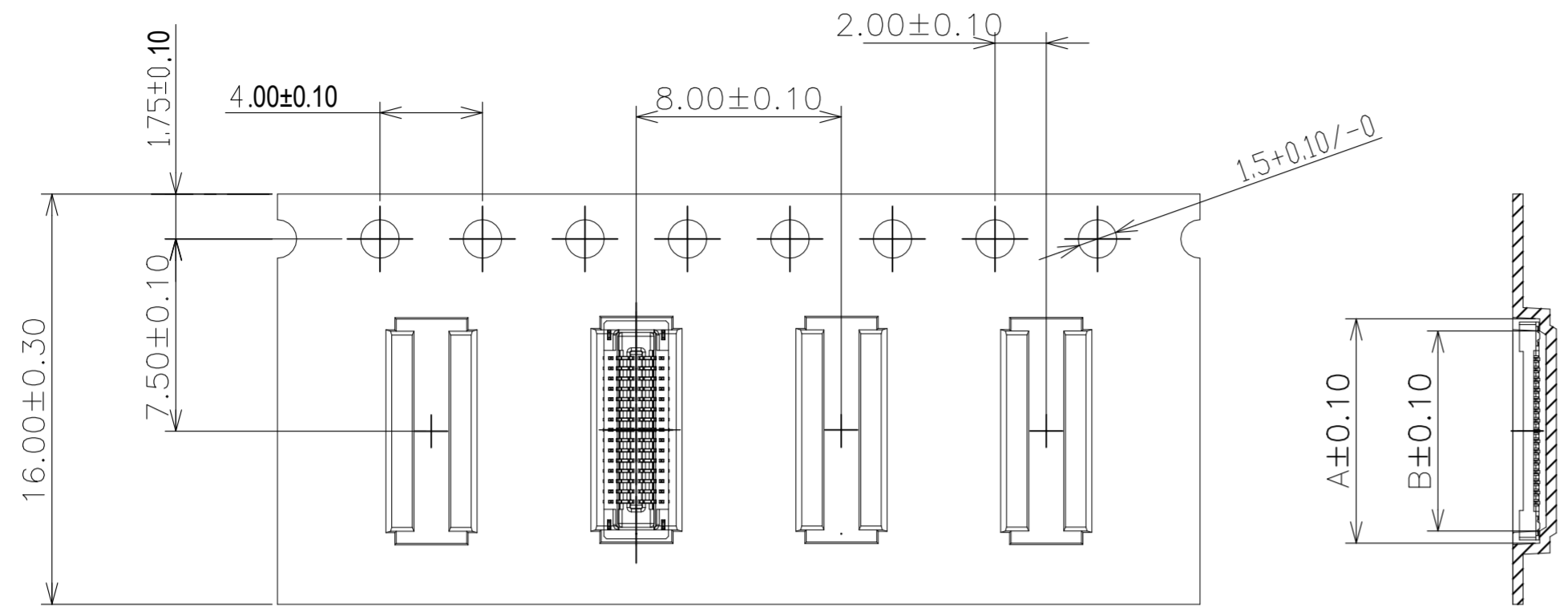

5.95	7.55	4.024KG	0.54KG	5000	6	30000	2-2363961-4
5.15	6.75	3.964KG	0.48KG	5000	6	30000	2-2363961-0
7.15	8.75	4.114KG	0.63KG	5000	6	30000	3-2363961-0
9.15	10.75	6.018KG	0.81KG	5000	6	30000	4-2363961-0
DIM B	DIM A	GROSS WEIGHT	NET WEIGHT	PCS/ REEL	REEL/ BOX	PCS/ BOX	PART NUMBER

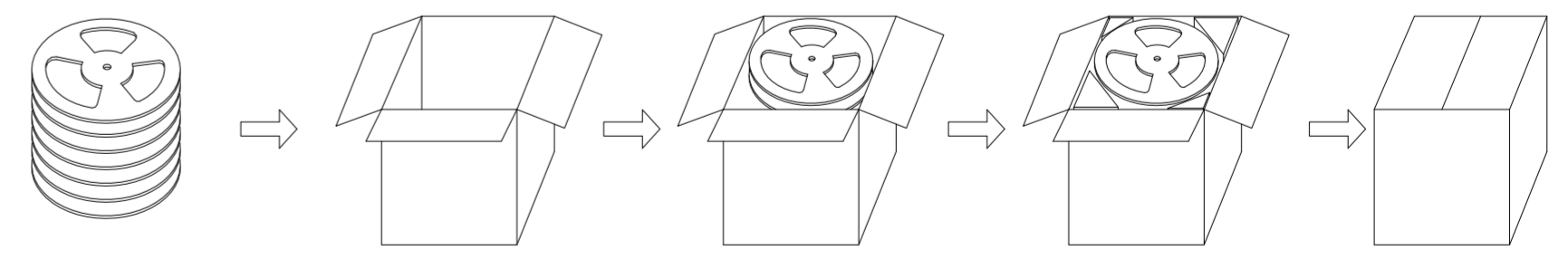
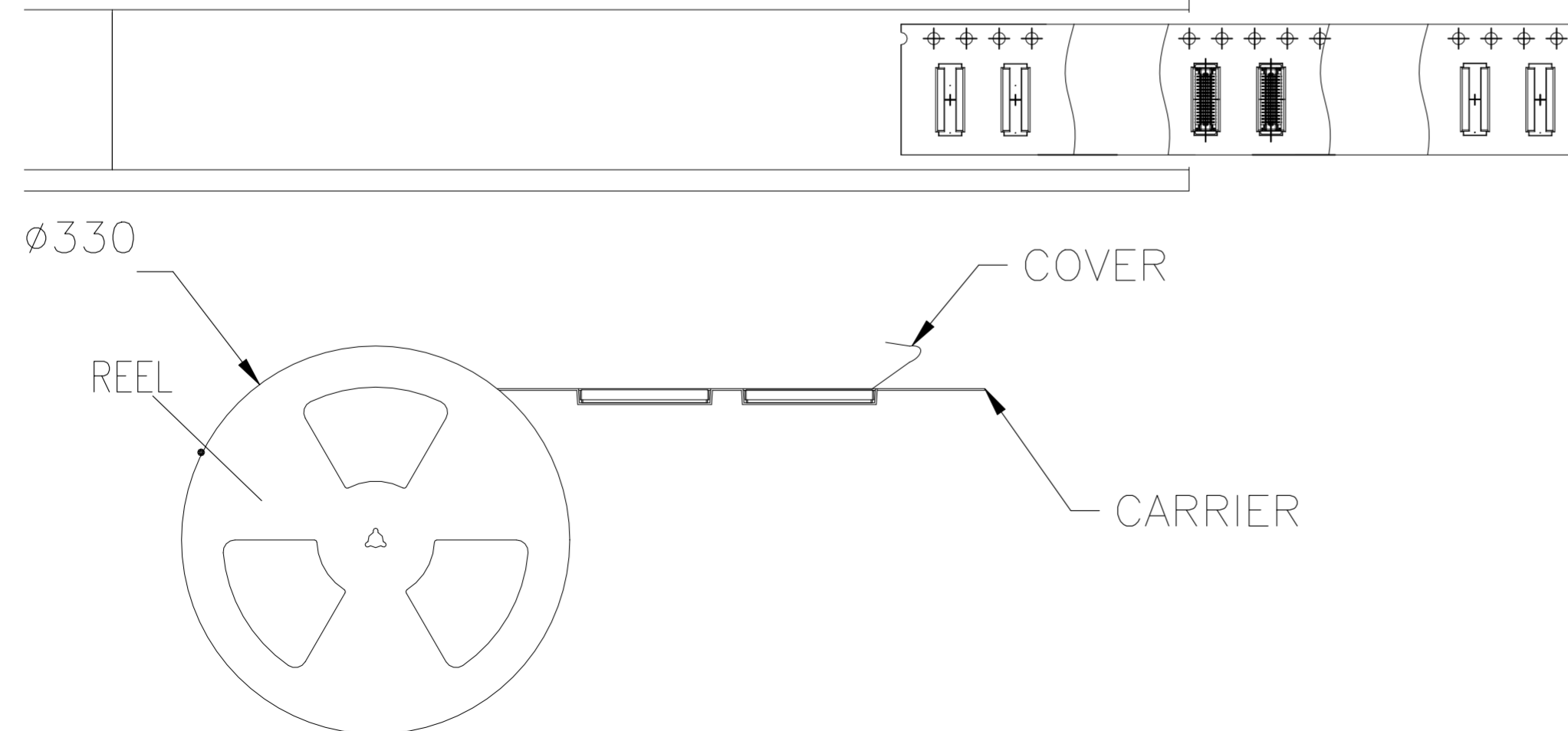

OUT BOX PACKAGE DIAGRAM DRAWING

THIS DRAWING IS A CONTROLLED DOCUMENT.		DWN	26SEP2019	<b>TE</b> TE Connectivity Ltd.	
		CHK	26SEP2019		
DIMENSIONS: mm		TOLERANCES UNLESS OTHERWISE SPECIFIED		NAME	
0 PLC ±		1 PLC ± 0.3		PRODUCT SPEC	
2 PLC ± 0.20		3 PLC ±		APPLICATION SPEC	
4 PLC ±		ANGLES ±		114-115040	
MATERIAL		FINISH		SIZE	CAGE CODE
				A2	00779
				DRAWING NO	
				RESTRICTED TO	
				C=2363961	
				SCALE	SHEET
				12:1	9 of 9
				REV	A1
				CUSTOMER DRAWING	

2363961