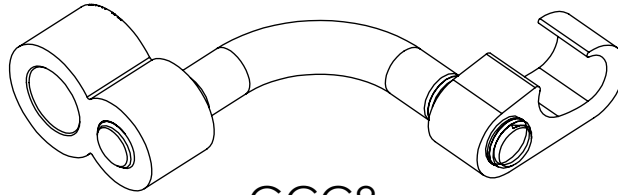
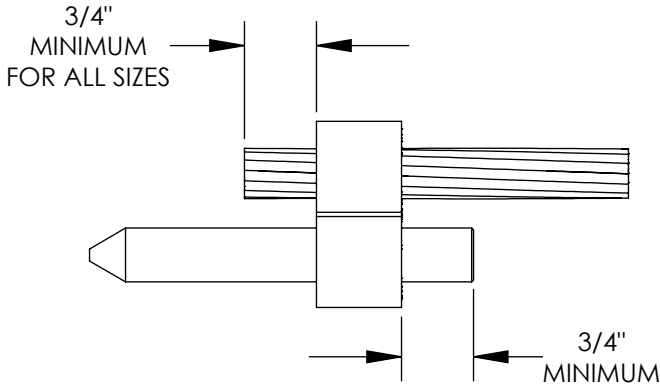
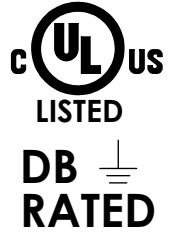

FIG8



GCC8



NOTE: BRUSH CABLE & ROD CLEAN BEFORE INSTALL

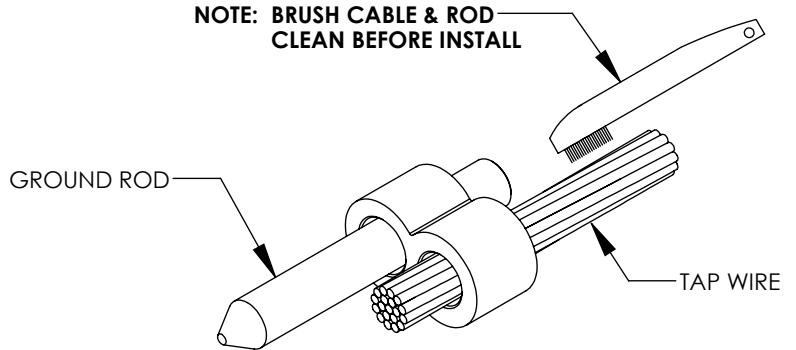

NOTE: GALVANIZED GROUND RODS MUST USE TIN PLATED CONNECTORS

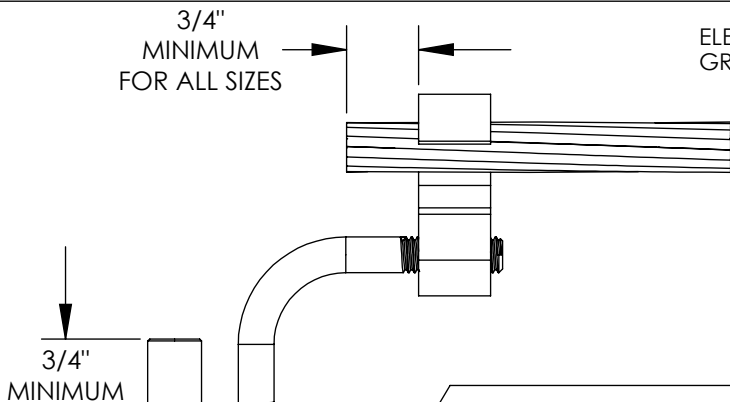

ELEMENT 8: GROUND ROD

ELEMENT 6: TAP WIRE

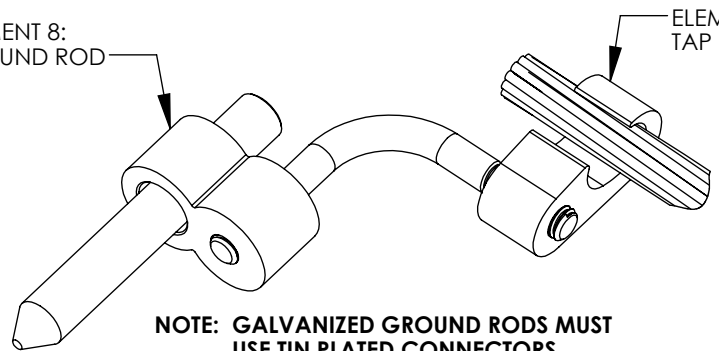

NOTE: GALVANIZED GROUND RODS MUST USE TIN PLATED CONNECTORS

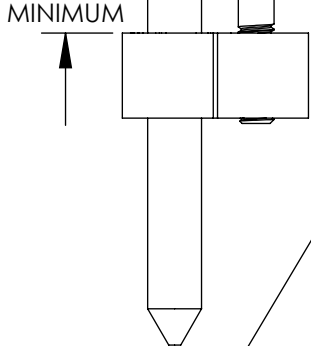
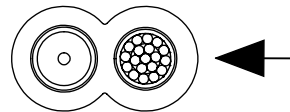

FIG8 & GCC8 ELEMENT 8

BEFORE CRIMP



FIXED SIDE OF CRIMP TOOL

PISTON SIDE OF CRIMP TOOL

GCC8 ELEMENT 6

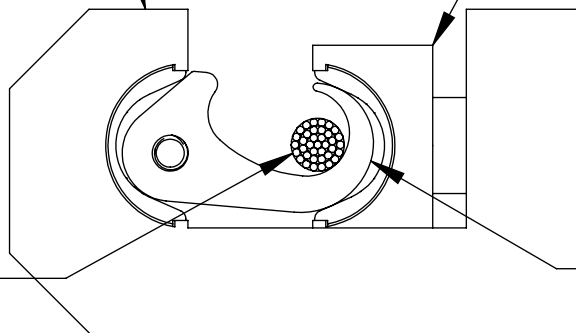

AFTER CRIMP

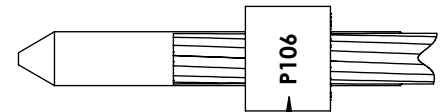

NOTE: DIE INDEX SHOWN FOR INSPECTION

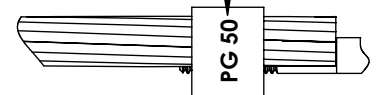

NOTE: START CRIMP WITH CONDUCTOR TOWARD OUTSIDE OF POCKET AS SHOWN

NOTE: FOR OPEN CRIMP HEADS, ORIENT HOOK SIDE OF ELEMENT 6 TOWARD PISTON AS SHOWN

## TOOL CHART FOR FIG8 AND GCC8 SERIES DIRECT BURIAL GROUNDING CONNECTORS

PANDUIT Part Number (Element Number)	PANDUIT Tool			Thomas & Betts Corporation Tool			Burndy Corporation Tool		
	12-Ton	14-Ton	15-Ton	12-Ton	14-Ton	15-Ton	12-Ton	15-Ton	15-Ton
	<b>A</b> SEE TOOL LIST BELOW	CT-930 CT-930CH CT-2930 CT-2930/L CT-2930/LE	<b>B</b> SEE TOOL LIST BELOW	TBM12PCR-LI	TBM14M TBM14MC TBM14RH TBM14BSCR TBM14CR-LI 13100A BPLT14BSCR BPLT4BSERI	TBM15 TBM15I TBM15CR-LI BPLT15BSCR  with die adaptor 15500-TB	<b>C</b> SEE TOOL LIST BELOW	Y45  with die adaptor PT6515	<b>D</b> SEE TOOL LIST BELOW
Die Part Number Die Index (Quantity of Compressions)			Die Part Number Die Index (Quantity of Compressions)			Die Part Number Die Index (Quantity of Compressions)			
GCC8-1/2-250 (Element 6)	CD-930G-250 BLACK PG25 (1)			15G86R G86 (1)			U997 997 (1)		
GCC8-5/8-250 (Element 6)									
GCC8-3/4-250 (Element 6)									
GCC8-1-250 (Element 6)									
**GCC8-1/2-500 (Element 6)	CD-930G-500 BLUE PG50 (1)			15G126R G126 (1)			PU998 998 (1)		
**GCC8-5/8-500 (Element 6)									
**GCC8-3/4-500 (Element 6)									
**GCC8-1-500 (Element 6)									
GCC8-1/2-250 (Element 8)	CD-920-750 BLACK P106 (1)			15G121R G121 (2)			U1011 1011 (2)      or      U39RT BLACK 24 (1)		
GCC8-5/8-250 (Element 8)									
*GCC8-3/4-250 (Element 8)									
***GCC8-1-250 (Element 8)									
GCC8-1/2-500 (Element 8)									
GCC8-5/8-500 (Element 8)									
*GCC8-3/4-500 (Element 8)									
***GCC8-1-500 (Element 8)									
FIG8-1/2-2/0									
FIG8-5/8-2/0									
*FIG8-3/4-2/0									
***FIG8-1-2/0									
FIG8-1/2-250									
FIG8-5/8-250									
*FIG8-3/4-250									
***FIG8-1-250									
*FIG8-5/8-500									
*FIG8-3/4-500									
***FIG8-1-500									
*FIG8-5/8-32									

Note: Suffix "TP" may be applied to any part number above to denote Tin Plated version.

\*These parts do not fit Panduit CT-2920 series. Burndy Y35 series, Burndy Y39 series, and Burndy BAT35 series do not fit with U39RT die, U1011 die must be used instead.

\*\*These parts do not fit in crimp tool series: Panduit CT-2920, Burndy Y35, Burndy BAT35, or Burndy Y39.

\*\*\*These parts do not fit in crimp tool series: Panduit CT-2920, Panduit CT-930, Panduit CT-930CH, Burndy Y35, Burndy BAT35, or Burndy Y39.

**A** CT-920, CT-920/CV, CT-920CH, CT-920CH/CV, CT-920CH/CCP, CT-2920, CT-2920/CCP, CT-2920/CCPINT, CT-2920/CCPUK, CT-2920/CCPAUS, CT-2920/CCPTO, CT-2931, CT-2931/ST, CT-2931/STINT, CT-2931/STUK, CT-2931/STAUS, CT-2931/TO, CT-2931/STCV, CT-2931/STCVINT, CT-2931/STCVUK, CT-2931/STCVAUS, CT-2931/CVTO

**B** Use die adaptor **CD-940-920DA**: CT-940CH, CT-2940, CT-2940/ST, CT-2940/STINT, CT-2940/STUK, CT-2940/STAUS, CT-2940/TO  
 Use die adaptor **CT-940-DA**: CT-940CH/BJO, CT-2940/L, CT-2940/LE

**C** Y35, Y35BH, Y35BH4, Y352, Y39, Y39BH, Y750, Y750HS, Y750HSXT, Y750CHSXT, Y750BH, Y750BHXT, Y750CBHXT, PAT750, PAT750LI, PAT750CLI, PAT750KLI, PAT750L5, PAT750CL5, BAT750, BAT35

**D** Use die adaptor **PUADP-1**: Y46, Y46LWSBH, Y46CLWSBH, Y46LWSBHF, Y46CLWSBHF, Y46LWBH, Y46LWBHF, PAT46, PAT46-18V, PAT46-LI, PAT46LW-18V, PAT46LWLI, PAT46LWL5, PAT46LWS, PAT46LWSLI, PAT46CLWSLI, PAT46LWSL5, PAT46CLWSL5